

PRIMARY RECORD

Primary # _____
HRI # _____
Trinomial _____
NRHP Status Code 6Z

Other Listings _____
Review Code _____ Reviewer _____ Date / /

Page 1 of 2

*Resource Name or #: 958, Moffett Federal Airfield

P1. Other Identifier: Storage

*P2. Location: Not for Publication Unrestricted a. County Santa Clara
b. USGS 7.5' Quad _____ Date _____ T _____; R _____; _____ 1/4 of _____ 1/4 of Sec _____; _____ B.M.
c. Address off Ellis Street City Moffett Field Zip 94035
d. UTM: (Give more than one for large and/or linear feature) Zone _____, _____ mE/ _____ mN
e. Other Locational Data: (e.g. parcel #, legal description, directions to resource, elevation, additional UTM's, etc. as appropriate)

*P3a. Description: (Describe resource and its major elements. Include design, materials, condition, alterations, size, setting, and boundaries.)

Building 958 is a pre-fabricated metal open storage shed supported on four metal tapered legs. The gable roof is constructed of ribbed metal. Its sides are enclosed by a chain link fence.

*P3b. Resources Attributes: (List attributes and codes) HP34. Military Property

*P4. Resources Present: Building Structure Object Site District Element of District Other (Isolates, etc.)

P5b. Description of Photo: (View, date, etc.)
North,

April 1998, Roll 7-29

*P6. Date Constructed/Age and Sources:

Prehistoric Historic Both

1956

*P7. Owner and Address:

U.S.A. as represented by
National Aeronautics and Space
Administration, Washington, D.C.

*P8. Recorded by: (Name, affiliation, address)

Alexandra C. Cole, SAIC
816 State Street, Suite 500
Santa Barbara, CA 93101

*P9. Date Recorded: 06/29/1998

*P10. Survey Type: (Describe)

Comprehensive Survey for Section
106 Compliance

*P11. Report Citation: (Cite survey report/other sources or "none") Inventory and Evaluation of Cold War Era Historical Resources, Moffett Federal Airfield

*Attachments: NONE Location Map Sketch Map Continuation Sheet Building, Structure and Object Record
 Archaeological Record District Record Linear Feature Record Milling Station Record Rock Art Record Artifact Record
 Photograph Record Other: (List) _____



BUILDING, STRUCTURE, AND OBJECT RECORD

Page 2 of 2

*NRHP Status Code 6Z

*Resource Name or #: 958, Moffett Federal Airfield

B1. Historic Name: Unknown

B2. Common Name: Unknown

B3. Original Use: Vehicle Shed

B4. Present Use: Storage Shed-U.S. Army

*B5. Architectural Style: No Style

*B6. Construction History: (Construction date, alterations, and date of alterations.)

1956

*B7. Moved? No Yes Unknown Date: _____ Original Location: _____

*B8. Related Features:

B9a. Architect: Unknown

b. Builder: Unknown

*B10. Significance: Theme Cold War

Area United States

Period of Significance 1946-1989

Property Type Military

Applicable Criteria G

(Discuss importance in terms of historical or architectural context as defined by theme, period, and geographic scope. Also address integrity.)

This Cold War-era building is considered a support building, a type found at any Naval installation regardless of mission. It is therefore not of exceptional national significance and is not considered eligible for the National Register of Historic Places (Criterion G).

B11. Additional Resource Attributes: (List attributes and codes) _____

*B12. References:

Real Property Form

B13. Remarks:

*B14. Evaluator: Alexandra C. Cole

Date of Evaluation: 05/01/1998

(This space reserved for official comments.)

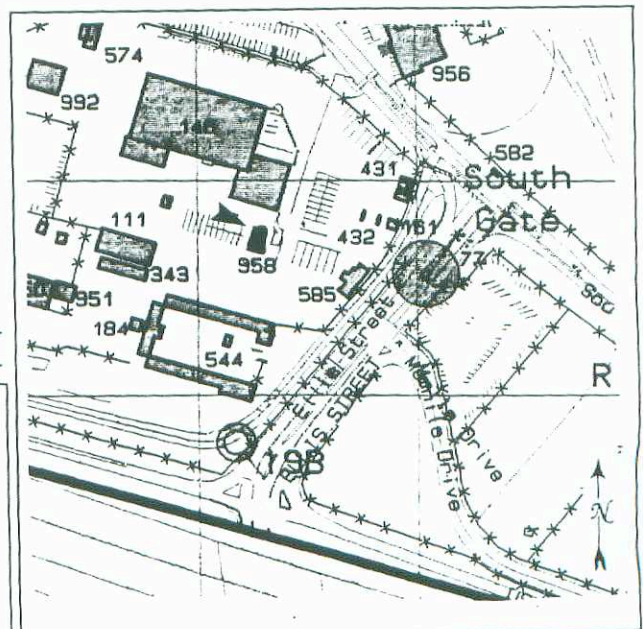

*Required information