

PRIMARY RECORD

Primary # _____
HRI # _____
Trinomial _____
NRHP Status Code 6Z

Other Listings _____
Review Code _____ Reviewer _____ Date / /

Page 1 of 2

*Resource Name or #: 669, Moffett Federal Airfield

P1. Other Identifier: Maintenance

*P2. Location: Not for Publication Unrestricted a. County Santa Clara
b. USGS 7.5' Quad _____ Date _____ T _____; R _____; _____ 1/4 of _____ 1/4 of Sec _____; _____ B.M.
c. Address East Patrol Road City Moffett Field Zip 94035
d. UTM: (Give more than one for large and/or linear feature) Zone _____, _____ mE/ _____ mN
e. Other Locational Data: (e.g. parcel #, legal description, directions to resource, elevation, additional UTM's, etc. as appropriate)

*P3a. Description: (Describe resource and its major elements. Include design, materials, condition, alterations, size, setting, and boundaries.)

Building 669 has a two-story flat-roofed main block with a one-story wing to the north and a one-story ell to the south. The wing, with a high concrete foundation, has a loading dock on its east side. Metal single or double doors provide access on the south, east, and west sides. High overhead doors are located on the east and west sides of the main block. Double-hung windows in wood sash are located on the west, north, and east sides. The ell has sliding aluminum sash windows.

*P3b. Resources Attributes: (List attributes and codes) HP34. Military Property

*P4. Resources Present: Building Structure Object Site District Element of District Other (Isolates, etc.)



P5b. Description of Photo: (View, date, etc.)
North,

April 1998, Roll 7-15

*P6. Date Constructed/Age and Sources:
 Prehistoric Historic Both
1943

*P7. Owner and Address:
U.S.A. as represented by
National Aeronautics and Space
Administration, Washington, D.C.

*P8. Recorded by: (Name, affiliation, address)
Alexandra C. Cole, SAIC
816 State Street, Suite 500
Santa Barbara, CA 93101

*P9. Date Recorded: 06/29/1998

*P10. Survey Type: (Describe)
Comprehensive Survey for Section
106 Compliance

*P11. Report Citation: (Cite survey report/other sources or "none") Inventory and Evaluation of Cold War Era Historical
Resources, Moffett Federal Airfield

*Attachments: NONE Location Map Sketch Map Continuation Sheet Building, Structure and Object Record
 Archaeological Record District Record Linear Feature Record Milling Station Record Rock Art Record Artifact Record
 Photograph Record Other: (List) _____

BUILDING, STRUCTURE, AND OBJECT RECORD

Page 2 of 2

*NRHP Status Code 6Z

*Resource Name or #: 669, Moffett Federal Airfield

B1. Historic Name: Building 49

B2. Common Name: Unknown

B3. Original Use: Unknown B4. Present Use: CANG Maintenance

*B5. Architectural Style: No Style

*B6. Construction History: (Construction date, alterations, and date of alterations.)
1943; 1963, altered by George S. Erskine and Associates, Menlo Park, for P-3 training school; 1998, altered for CANG engine repair.

*B7. Moved? No Yes Unknown Date: _____ Original Location: _____

*B8. Related Features:

B9a. Architect: Unknown b. Builder: Unknown

*B10. Significance: Theme Cold War Area United States

Period of Significance 1946-1989 Property Type Military Applicable Criteria G

(Discuss importance in terms of historical or architectural context as defined by theme, period, and geographic scope. Also address integrity.)

With buildings 654 and 655, this was part of "Orion University" that trained P-3 Orion pilots and technical crews. This building was directly associated with the Cold War P-3 Orion anti-submarine warfare patrol mission dating from 1963 to 1994 at Moffett Field. Although this mission is considered of exceptional national significance within the Cold War context, this building is of standard World War II construction and does not exhibit unique architectural or engineering modifications special to the P-3 mission. It is therefore not considered of exceptional significance under criterion G.

B11. Additional Resource Attributes: (List attributes and codes) _____

*B12. References:
CANG Master Plan 1997; Civil Engineering Archives, Building 683

B13. Remarks:

*B14. Evaluator: Alexandra C. Cole
Date of Evaluation: 05/01/1998

(This space reserved for official comments.)

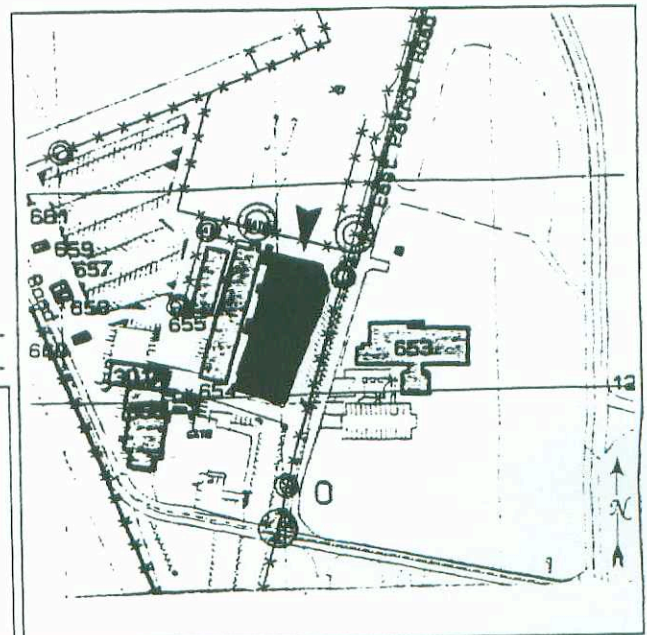

*Required information