

PRIMARY RECORD

Primary # _____
HRI # _____
Trinomial _____
NRHP Status Code 6Z

Other Listings _____
Review Code _____ Reviewer _____ Date / /

Page 1 of 2

*Resource Name or #: Azimuth Antenna/ Shelter, NASA Crows Landing

P1. Other Identifier: Azimuth Antenna/ Shelter

*P2. Location: Not for Publication Unrestricted a. County Stanislaus

b. USGS 7.5' Quad _____ Date _____ T _____; R _____; _____ 1/4 of _____ 1/4 of Sec _____; _____ B.M.

c. Address NASA C.L. Flight Facility City Crows Landing Zip 95313

d. UTM: (Give more than one for large and/or linear feature) Zone _____, _____ mE/ _____ mN

e. Other Locational Data: (e.g. parcel #, legal description, directions to resource, elevation, additional UTMs, etc. as appropriate)

*P3a. Description: (Describe resource and its major elements. Include design, materials, condition, alterations, size, setting, and boundaries.)
The azimuth shelter is a rectangular metal box on a concrete slab. A metal door is located on the south side. The antenna is a rectangular metal box on a concrete slab with a metal door on the east. It is connected to a semi-circular metal shield.

*P3b. Resources Attributes: (List attributes and codes) HP34. Military Property

*P4. Resources Present: Building Structure Object Site District Element of District Other (Isolates, etc.)

P5b. Description of Photo: (View, date, etc.)
Northeast
April 1998, Roll 6-8

*P6. Date Constructed/Age and Sources:
 Prehistoric Historic Both
Unknown

*P7. Owner and Address:
U.S.A. as represented by
National Aeronautics and Space
Administration, Washington, D.C.

*P8. Recorded by: (Name, affiliation, address)
Alexandra C. Cole, SAIC
816 State Street, Suite 500
Santa Barbara, CA 93101

*P9. Date Recorded: 07/01/1998

*P10. Survey Type: (Describe)
Comprehensive Survey for Section
106 Compliance



*P11. Report Citation: (Cite survey report/other sources or "none") Inventory and Evaluation of Cold War Era Historical Resources, NASA Crows Landing

*Attachments: NONE Location Map Sketch Map Continuation Sheet Building, Structure and Object Record
 Archaeological Record District Record Linear Feature Record Milling Station Record Rock Art Record Artifact Record
 Photograph Record Other: (List) _____

*Required information

BUILDING, STRUCTURE, AND OBJECT RECORD

Page 2 of 2

*NRHP Status Code 6Z

*Resource Name or #: Azimuth Antenna/ Shelter, NASA Crows Landing

B1. Historic Name: Unknown

B2. Common Name: Unknown

B3. Original Use: Azimuth Antenna/ Shelter

B4. Present Use: Vacant

*B5. Architectural Style: No Style

*B6. Construction History: (Construction date, alterations, and date of alterations.)

Unknown

*B7. Moved? No Yes Unknown Date: _____ Original Location: _____

*B8. Related Features:

B9a. Architect: Unknown

b. Builder: Texas Instruments

*B10. Significance: Theme Cold War

Area United States

Period of Significance 1946-1989

Property Type Military

Applicable Criteria G

(Discuss importance in terms of historical or architectural context as defined by theme, period, and geographic scope. Also address integrity.)

This Cold War-era building is considered a support building, a type found at any Naval installation regardless of mission. It is therefore not of exceptional national significance and is not considered eligible for the National Register of Historic Places (Criterion G).

B11. Additional Resource Attributes: (List attributes and codes) _____

*B12. References:

B13. Remarks:

*B14. Evaluator: Alexandra C. Cole

Date of Evaluation: 05/01/1998

(This space reserved for official comments.)

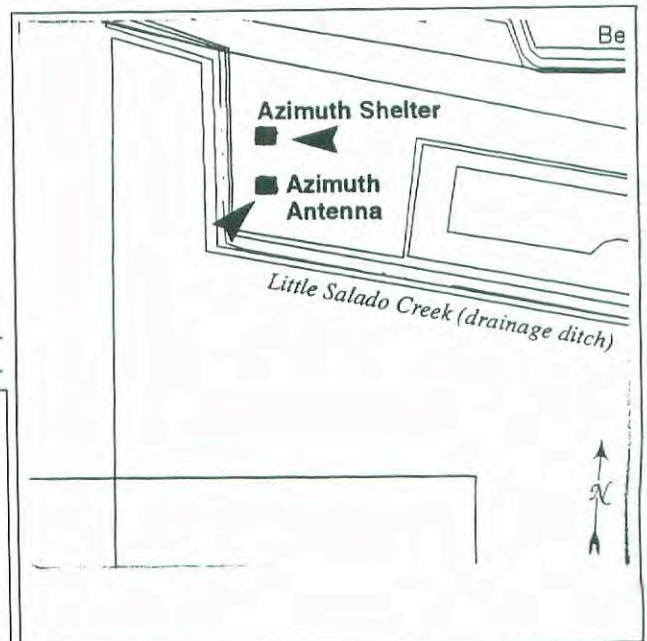

PRIMARY RECORD

Primary # _____
HRI # _____
Trinomial _____
NRHP Status Code 6Z

Other Listings _____
Review Code _____ Reviewer _____ Date / /

Page 1 of 2

*Resource Name or #: Azimuth Antenna/ Shelter, NASA Crows Landing

P1. Other Identifier: Azimuth Antenna/ Shelter

*P2. Location: Not for Publication Unrestricted a. County Stanislaus

b. USGS 7.5' Quad _____ Date _____ T _____; R _____; 1/4 of _____ 1/4 of Sec _____; B.M. _____

c. Address NASA C.L. Flight Facility City Crows Landing Zip 95313

d. UTM: (Give more than one for large and/or linear feature) Zone _____, _____ mE/ _____ mN

e. Other Locational Data: (e.g. parcel #, legal description, directions to resource, elevation, additional UTM's, etc. as appropriate)

*P3a. Description: (Describe resource and its major elements. Include design, materials, condition, alterations, size, setting, and boundaries.)

The azimuth shelter is a rectangular metal box on a concrete slab. A metal door is located on the south side. The antenna is a rectangular metal box on a concrete slab with a metal door on the east. It is connected to a semi-circular metal shield.

*P3b. Resources Attributes: (List attributes and codes) HP34. Military Property

*P4. Resources Present: Building Structure Object Site District Element of District Other (Isolates, etc.)

P5b. Description of Photo: (View, date, etc.)
Northeast

April 1998, Roll 6-7, 6-8

*P6. Date Constructed/Age and Sources:

Prehistoric Historic Both

Unknown

*P7. Owner and Address:

U.S.A. as represented by
National Aeronautics and Space
Administration, Washington, D.C.

*P8. Recorded by: (Name, affiliation, address)

Alexandra C. Cole, SAIC
816 State Street, Suite 500
Santa Barbara, CA 93101

*P9. Date Recorded: 07/01/1998

*P10. Survey Type: (Describe)

Comprehensive Survey for Section
106 Compliance

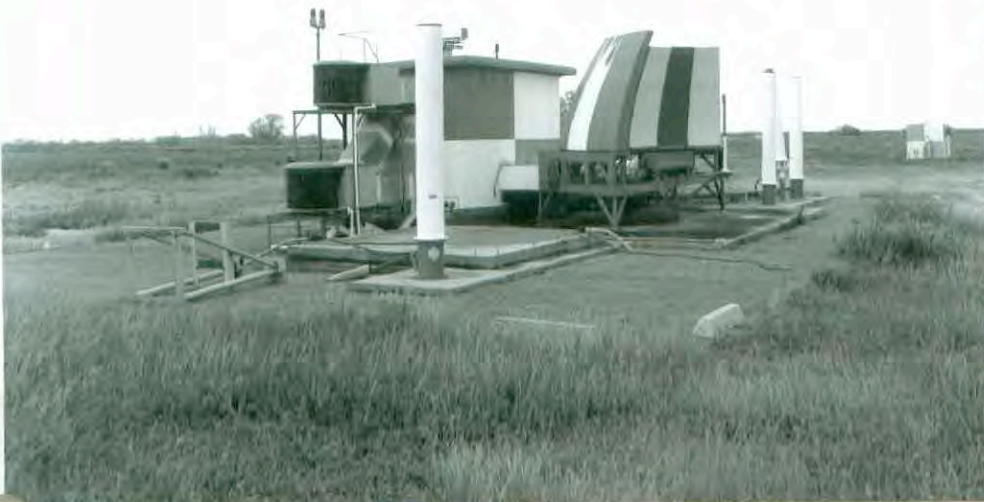

*P11. Report Citation: (Cite survey report/other sources or "none") Inventory and Evaluation of Cold War Era Historical Resources, NASA Crows Landing

*Attachments: NONE Location Map Sketch Map Continuation Sheet Building, Structure and Object Record
 Archaeological Record District Record Linear Feature Record Milling Station Record Rock Art Record Artifact Record
 Photograph Record Other: (List) _____

BUILDING, STRUCTURE, AND OBJECT RECORD

Page 2 of 2

*NRHP Status Code 6Z

*Resource Name or #: Azimuth Antenna/ Shelter, NASA Crows Landing

B1. Historic Name: Unknown

B2. Common Name: Unknown

B3. Original Use: Azimuth Antenna/ Shelter B4. Present Use: Vacant

*B5. Architectural Style: No Style

*B6. Construction History: (Construction date, alterations, and date of alterations.)
Unknown

*B7. Moved? No Yes Unknown Date: _____ Original Location: _____

*B8. Related Features:

B9a. Architect: Unknown b. Builder: Texas Instruments

*B10. Significance: Theme Cold War Area United States

Period of Significance 1946-1989 Property Type Military Applicable Criteria G

(Discuss importance in terms of historical or architectural context as defined by theme, period, and geographic scope. Also address integrity.)

This Cold War-era building is considered a support building, a type found at any Naval installation regardless of mission. It is therefore not of exceptional national significance and is not considered eligible for the National Register of Historic Places (Criterion G).

B11. Additional Resource Attributes: (List attributes and codes) _____

*B12. References:

B13. Remarks:

*B14. Evaluator: Alexandra C. Cole

Date of Evaluation: 05/01/1998

(This space reserved for official comments.)

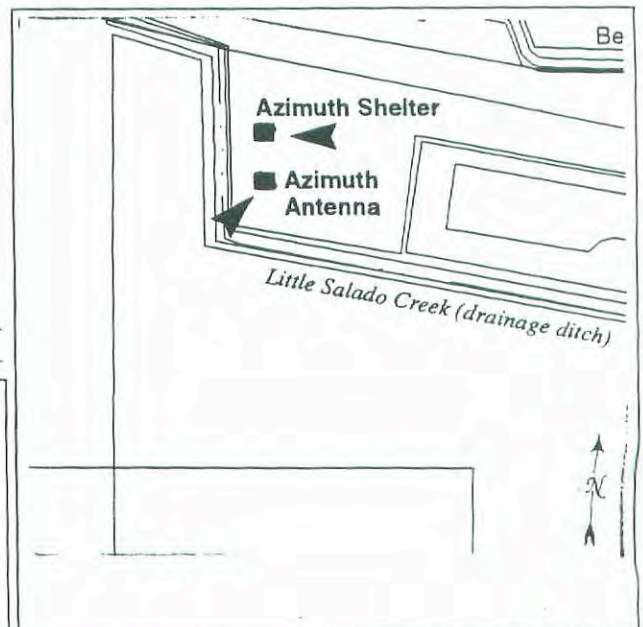

PRIMARY RECORD

Primary # _____
HRI # _____
Trinomial _____
NRHP Status Code 6Z

Other Listings _____
Review Code _____ Reviewer _____ Date / / _____

Page 1 of 2

*Resource Name or #: Bunker, NASA Crows Landing

P1. Other Identifier: Bunker

*P2. Location: Not for Publication Unrestricted a. County Stanislaus

b. USGS 7.5' Quad _____ Date _____ T _____; R _____; _____ 1/4 of _____ 1/4 of Sec _____; _____ B.M.

c. Address NASA C.L. Flight Facility City Crows Landing Zip 95313

d. UTM: (Give more than one for large and/or linear feature) Zone _____, _____ mE/ _____ mN

e. Other Locational Data: (e.g. parcel #, legal description, directions to resource, elevation, additional UTM's, etc. as appropriate)

*P3a. Description: (Describe resource and its major elements. Include design, materials, condition, alterations, size, setting, and boundaries.)

The bunker is a metal Quonset hut covered with grass. Metal double doors are located on the south side.

*P3b. Resources Attributes: (List attributes and codes) HP34. Military Property

*P4. Resources Present: Building Structure Object Site District Element of District Other (Isolates, etc.)

P5b. Description of Photo: (View, date, etc.)

Northwest

April 1998, Roll 6-6

*P6. Date Constructed/Age and Sources:

Prehistoric Historic Both

Unknown

*P7. Owner and Address:

U.S.A. as represented by

National Aeronautics and Space

Administration, Washington, D.C.

*P8. Recorded by: (Name, affiliation, address)

Alexandra C. Cole, SAIC

816 State Street, Suite 500

Santa Barbara, CA 93101

*P9. Date Recorded: 03/03/1999

*P10. Survey Type: (Describe)

Comprehensive Survey for Section

106 Compliance



*P11. Report Citation: (Cite survey report/other sources or "none") Inventory and Evaluation of Cold War Era Historical Resources, NASA Crows Landing

*Attachments: NONE Location Map Sketch Map Continuation Sheet Building, Structure and Object Record
 Archaeological Record District Record Linear Feature Record Milling Station Record Rock Art Record Artifact Record
 Photograph Record Other: (List) _____

BUILDING, STRUCTURE, AND OBJECT RECORD

Page 2 of 2

*NRHP Status Code 6Z

*Resource Name or #: Bunker, NASA Crows Landing

B1. Historic Name: Unknown

B2. Common Name: Unknown

B3. Original Use: Unknown B4. Present Use: V--Vacant

*B5. Architectural Style: Quonset hut

*B6. Construction History: (Construction date, alterations, and date of alterations.)

*B7. Moved? No Yes Unknown Date: _____ Original Location: _____

*B8. Related Features:

B9a. Architect: Unknown b. Builder: Unknown

*B10. Significance: Theme Cold War Area United States

Period of Significance 1946-1989 Property Type Military Applicable Criteria G

(Discuss importance in terms of historical or architectural context as defined by theme, period, and geographic scope. Also address integrity.)

This Cold War-era building is considered a support building, a type found at any Naval installation regardless of mission. It is therefore not of exceptional national significance and is not considered eligible for the National Register of Historic Places (Criterion G).

B11. Additional Resource Attributes: (List attributes and codes) _____

*B12. References:
Real Property Form

B13. Remarks:

*B14. Evaluator: Alexandra C. Cole

Date of Evaluation: 05/01/1998

(This space reserved for official comments.)

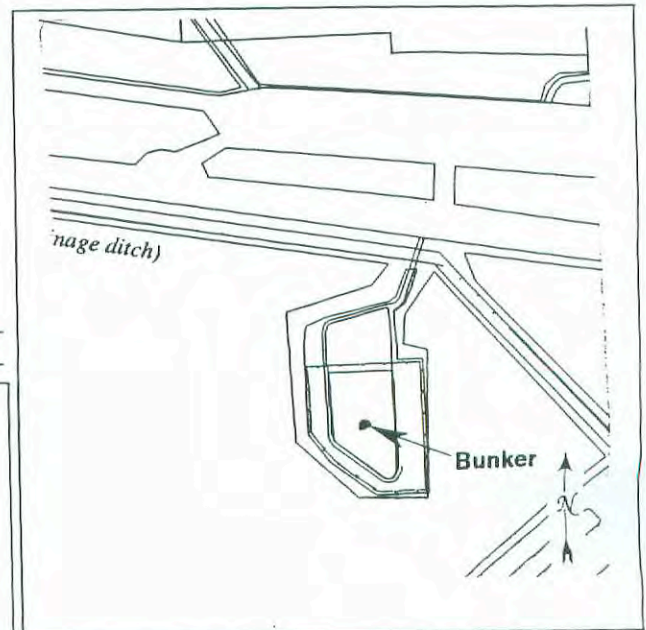

PRIMARY RECORD

Primary # _____
HRI # _____
Trinomial _____
NRHP Status Code 6Z

Other Listings _____
Review Code _____ Reviewer _____ Date / /

Page 1 of 2

*Resource Name or #: 40, NASA Crows Landing

P1. Other Identifier: Pilot's Ready Room

*P2. Location: Not for Publication Unrestricted a. County Stanislaus
b. USGS 7.5' Quad _____ Date _____ T _____; R _____; _____ 1/4 of _____ 1/4 of Sec _____; _____ B.M.
c. Address NASA C.L. Flight Facility City Crows Landing Zip 95313
d. UTM: (Give more than one for large and/or linear feature) Zone _____, _____ mE/ _____ mN
e. Other Locational Data: (e.g. parcel #, legal description, directions to resource, elevation, additional UTM's, etc. as appropriate)

*P3a. Description: (Describe resource and its major elements. Include design, materials, condition, alterations, size, setting, and boundaries.)
Building 40 is a 20'x 50' pre-fabricated metal Quonset hut. Dormer windows with four panes in metal sash light the east and west sides. Metal single doors with glass upper panes provide access on the north and south. The south side was used for crash/fire activities and the north side as a line maintenance shack.

*P3b. Resources Attributes: (List attributes and codes) HP34. Military Property

*P4. Resources Present: Building Structure Object Site District Element of District Other (Isolates, etc.)



P5b. Description of Photo: (View, date, etc.)
Northwest,

April 1998, Roll 5-30

*P6. Date Constructed/Age and Sources:
 Prehistoric Historic Both
1944

*P7. Owner and Address:
U.S.A. as represented by
National Aeronautics and Space
Administration, Washington, D.C.

*P8. Recorded by: (Name, affiliation, address)
Alexandra C. Cole, SAIC
816 State Street, Suite 500
Santa Barbara, CA 93101

*P9. Date Recorded: 06/30/1998

*P10. Survey Type: (Describe)
Comprehensive Survey for Section
106 Compliance

*P11. Report Citation: (Cite survey report/other sources or "none") Inventory and Evaluation of Cold War Era Historical Resources, NASA Crows Landing

*Attachments: NONE Location Map Sketch Map Continuation Sheet Building, Structure and Object Record
 Archaeological Record District Record Linear Feature Record Milling Station Record Rock Art Record Artifact Record
 Photograph Record Other: (List) _____

BUILDING, STRUCTURE, AND OBJECT RECORD

Page 2 of 2

*NRHP Status Code 6Z

*Resource Name or #: 40, NASA Crows Landing

B1. Historic Name: Unknown

B2. Common Name: Unknown

B3. Original Use: Pilot's Ready Room

B4. Present Use: Vacant

*B5. Architectural Style: Quonset hut

*B6. Construction History: (Construction date, alterations, and date of alterations.)

1944

*B7. Moved? No Yes Unknown Date: _____ Original Location: _____

*B8. Related Features:

B9a. Architect: Unknown

b. Builder: Unknown

*B10. Significance: Theme Cold War

Area United States

Period of Significance 1946-1989

Property Type Military

Applicable Criteria G

(Discuss importance in terms of historical or architectural context as defined by theme, period, and geographic scope. Also address integrity.)

This Cold War-era building is considered a support building, a type found at any Naval installation regardless of mission. It is therefore not of exceptional national significance and is not considered eligible for the National Register of Historical Places (Criterion G).

B11. Additional Resource Attributes: (List attributes and codes) _____

*B12. References:

Real Property Form

B13. Remarks:

*B14. Evaluator: Alexandra C. Cole

Date of Evaluation: 05/01/1998

(This space reserved for official comments.)

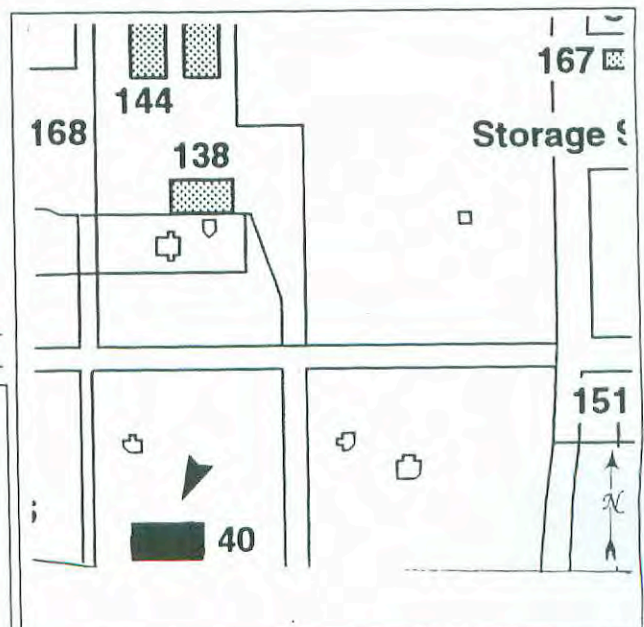

*Required information

PRIMARY RECORD

Primary # _____
HRI # _____
Trinomial _____
NRHP Status Code 6Z

Other Listings _____
Review Code _____ Reviewer _____ Date / /

Page 1 of 2

*Resource Name or #: 101, NASA Crows Landing

P1. Other Identifier: Control Tower

*P2. Location: Not for Publication Unrestricted a. County Stanislaus
b. USGS 7.5' Quad _____ Date _____ T _____; R _____; _____ 1/4 of _____ 1/4 of Sec _____; _____ B.M.
c. Address NASA C.L. Flight Facility City Crows Landing Zip 95313
d. UTM: (Give more than one for large and/or linear feature) Zone _____, _____ mE/ _____ mN
e. Other Locational Data: (e.g. parcel #, legal description, directions to resource, elevation, additional UTM's, etc. as appropriate)

*P3a. Description: (Describe resource and its major elements. Include design, materials, condition, alterations, size, setting, and boundaries.)

Building 101 is a four-story concrete tower measuring 21' x 21' x 64'. Fixed and transom windows in metal sash light the stair tower on the west side, as well as providing light on the east and south sides. A one-story flat-roof wing with an overhanging roof extends from the south side. An octagonal control window with canted tinted windows tops the tower. Metal single or double doors provide access on the east and west sides. A small flat-roof ell is attached on the south side for storage of batteries.

*P3b. Resources Attributes: (List attributes and codes) HP34. Military Property

*P4. Resources Present: Building Structure Object Site District Element of District Other (Isolates, etc.)

P5b. Description of Photo: (View, date, etc.)
Northeast,

April 1998, Roll 6-1

*P6. Date Constructed/Age and Sources:
 Prehistoric Historic Both
1953

*P7. Owner and Address:
U.S.A. as represented by
National Aeronautics and Space
Administration, Washington, D.C.

*P8. Recorded by: (Name, affiliation, address)
Alexandra C. Cole, SAIC
816 State Street, Suite 500
Santa Barbara, CA 93101

*P9. Date Recorded: 06/30/1998

*P10. Survey Type: (Describe)
Comprehensive Survey for Section
106 Compliance



*P11. Report Citation: (Cite survey report/other sources or "none") Inventory and Evaluation of Cold War Era Historical Resources, NASA Crows Landing

*Attachments: NONE Location Map Sketch Map Continuation Sheet Building, Structure and Object Record
 Archaeological Record District Record Linear Feature Record Milling Station Record Rock Art Record Artifact Record
 Photograph Record Other: (List) _____

BUILDING, STRUCTURE, AND OBJECT RECORD

Page 2 of 2

*NRHP Status Code 6Z

*Resource Name or #: 101, NASA Crows Landing

B1. Historic Name: Unknown

B2. Common Name: Unknown

B3. Original Use: Control Tower

B4. Present Use: V--Vacant

*B5. Architectural Style: No Style

*B6. Construction History: (Construction date, alterations, and date of alterations.)

1953

*B7. Moved? No Yes Unknown Date: _____ Original Location: _____

*B8. Related Features:

B9a. Architect: Unknown

b. Builder: Unknown

*B10. Significance: Theme Cold War Area United States

Period of Significance 1946-1989 Property Type Military Applicable Criteria G

(Discuss importance in terms of historical or architectural context as defined by theme, period, and geographic scope. Also address integrity.)

This Cold War-era building is considered a support building, a type found at any Naval installation regardless of mission. It is therefore not of exceptional national significance and is not considered eligible for the National Register of Historic Places (Criterion G).

B11. Additional Resource Attributes: (List attributes and codes) _____

*B12. References:
Real Property Form

B13. Remarks:

*B14. Evaluator: Alexandra C. Cole

Date of Evaluation: 05/01/1998

(This space reserved for official comments.)

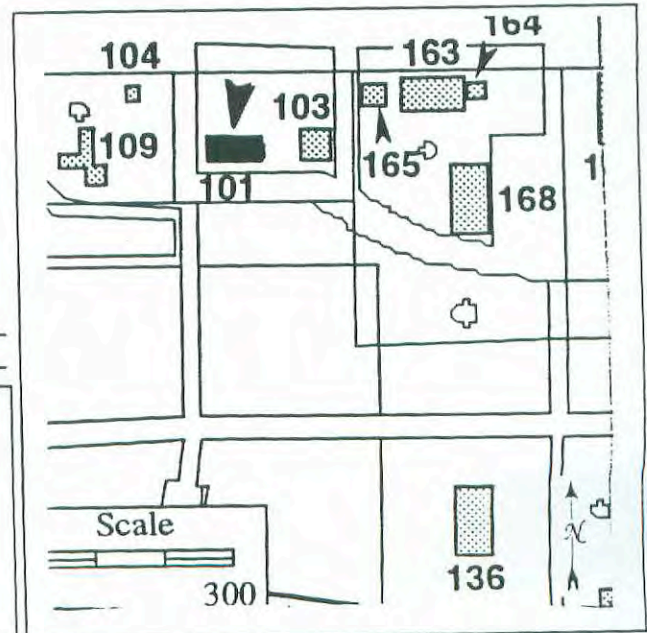

*Required information

PRIMARY RECORD

Primary # _____
HRI # _____
Trinomial _____
NRHP Status Code 6Z

Other Listings _____
Review Code _____ Reviewer _____ Date / /

Page 1 of 2

*Resource Name or #: 102, NASA Crows Landing

P1. Other Identifier: Receiver Building

*P2. Location: Not for Publication Unrestricted a. County Stanislaus
b. USGS 7.5' Quad _____ Date _____ T _____; R _____; _____ 1/4 of _____ 1/4 of Sec _____; _____ B.M.
c. Address NASA C.L. Flight Facility City Crows Landing Zip 95313
d. UTM: (Give more than one for large and/or linear feature) Zone _____, _____ mE/ _____ mN
e. Other Locational Data: (e.g. parcel #, legal description, directions to resource, elevation, additional UTM, etc. as appropriate)

*P3a. Description: (Describe resource and its major elements. Include design, materials, condition, alterations, size, setting, and boundaries.)

This small 18' x 23' rectangular building has a shed-roof concrete block ell to the north. Four antenna are located on the metal shed roof of the main building. A double metal door provides access to the ell and a single metal door provides access to the main building.

*P3b. Resources Attributes: (List attributes and codes) HP34. Military Property

*P4. Resources Present: Building Structure Object Site District Element of District Other (Isolates, etc.)



P5b. Description of Photo: (View, date, etc.)
Northwest,

April 1998, Roll 5-16

*P6. Date Constructed/Age and Sources:
 Prehistoric Historic Both
1953

*P7. Owner and Address:
U.S.A. as represented by
National Aeronautics and Space
Administration, Washington, D.C.

*P8. Recorded by: (Name, affiliation, address)
Alexandra C. Cole, SAIC
816 State Street, Suite 500
Santa Barbara, CA 93101

*P9. Date Recorded: 06/30/1998

*P10. Survey Type: (Describe)
Comprehensive Survey for Section
106 Compliance

*P11. Report Citation: (Cite survey report/other sources or "none") Inventory and Evaluation of Cold War Era Historical Resources, Moffett Federal Airfield

*Attachments: NONE Location Map Sketch Map Continuation Sheet Building, Structure and Object Record
 Archaeological Record District Record Linear Feature Record Milling Station Record Rock Art Record Artifact Record
 Photograph Record Other: (List) _____

BUILDING, STRUCTURE, AND OBJECT RECORD

Page 2 of 2

*NRHP Status Code 6Z

*Resource Name or #: 102, NASA Crows Landing

B1. Historic Name: Unknown

B2. Common Name: Unknown

B3. Original Use: Radio Receiver B4. Present Use: V--Vacant

*B5. Architectural Style: No Style

*B6. Construction History: (Construction date, alterations, and date of alterations.)
1953

*B7. Moved? No Yes Unknown Date: _____ Original Location: _____

*B8. Related Features:

B9a. Architect: Unknown b. Builder: Unknown

*B10. Significance: Theme Cold War Area United States
Period of Significance 1946-1989 Property Type Military Applicable Criteria G

(Discuss importance in terms of historical or architectural context as defined by theme, period, and geographic scope. Also address integrity.)

This Cold War-era building is considered a support building, a type found at any Naval installation regardless of mission. It is therefore not of exceptional national significance and is not considered eligible for the National Register of Historical Resources (Criterion G).

B11. Additional Resource Attributes: (List attributes and codes) _____

*B12. References:
Real Property Form

B13. Remarks:

*B14. Evaluator: Alexandra C. Cole
Date of Evaluation: 05/01/1998

(This space reserved for official comments.)

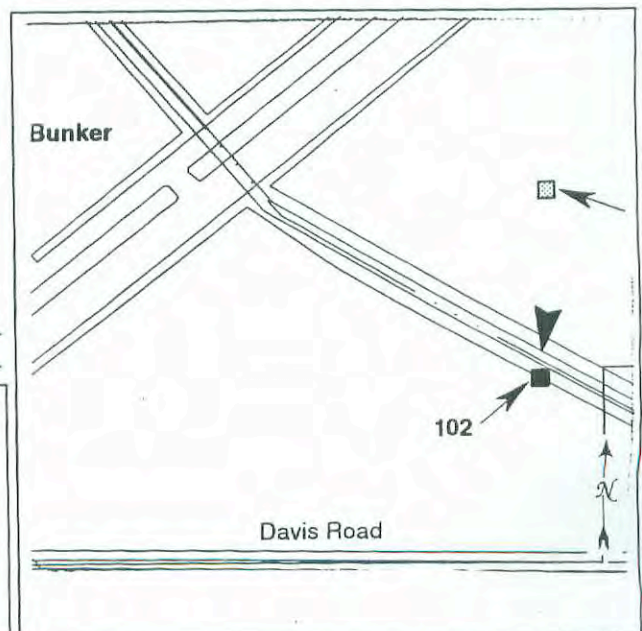

PRIMARY RECORD

Primary # _____
HRI # _____
Trinomial _____
NRHP Status Code 6Z

Other Listings _____
Review Code _____ Reviewer _____ Date / /

Page 1 of 2

*Resource Name or #: 103, NASA Crows Landing

P1. Other Identifier: Transformer Vault

*P2. Location: Not for Publication Unrestricted a. County Stanislaus

b. USGS 7.5' Quad _____ Date _____ T _____; R _____; _____ 1/4 of _____ 1/4 of Sec _____; _____ B.M.

c. Address NASA C.L. Flight Facility City Crows Landing Zip 95313

d. UTM: (Give more than one for large and/or linear feature) Zone _____, _____ mE/ _____ mN

e. Other Locational Data: (e.g. parcel #, legal description, directions to resource, elevation, additional UTM, etc. as appropriate)

*P3a. Description: (Describe resource and its major elements. Include design, materials, condition, alterations, size, setting, and boundaries.)

Building 103 is an 11'x 31' one-story concrete transformer vault. Fixed wire-glass windows light the north and south sides. A metal door with a four-pane wire-glass upper section provides access on the east side. Two transformers are located on concrete pads to the northeast of Building 103. This transformer provided power for runway lighting.

*P3b. Resources Attributes: (List attributes and codes) HP34. Military Property

*P4. Resources Present: Building Structure Object Site District Element of District Other (Isolates, etc.)



P5b. Description of Photo: (View, date, etc.)
Northwest,

April 1998, Roll 6-2

*P6. Date Constructed/Age and Sources:
 Prehistoric Historic Both
1953

*P7. Owner and Address:
U.S.A. as represented by
National Aeronautics and Space
Administration, Washington, D.C.

*P8. Recorded by: (Name, affiliation, address)
Alexandra C. Cole, SAIC
816 State Street, Suite 500
Santa Barbara, CA 93101

*P9. Date Recorded: 06/29/1998

*P10. Survey Type: (Describe)
Comprehensive Survey for Section
106 Compliance

*P11. Report Citation: (Cite survey report/other sources or "none") Inventory and Evaluation of Cold War Era Historical Resources, NASA Crows Landing

*Attachments: NONE Location Map Sketch Map Continuation Sheet Building, Structure and Object Record
 Archaeological Record District Record Linear Feature Record Milling Station Record Rock Art Record Artifact Record
 Photograph Record Other: (List) _____

BUILDING, STRUCTURE, AND OBJECT RECORD

Page 2 of 2

*NRHP Status Code 6Z

*Resource Name or #: 103, NASA Crows Landing

B1. Historic Name: Unknown

B2. Common Name: Unknown

B3. Original Use: Transformer Vault

B4. Present Use: V--Vacant

*B5. Architectural Style: No Style

*B6. Construction History: (Construction date, alterations, and date of alterations.)

1953

*B7. Moved? No Yes Unknown Date: _____ Original Location: _____

*B8. Related Features:

B9a. Architect: Unknown

b. Builder: Unknown

*B10. Significance: Theme Cold War

Area United States

Period of Significance 1946-1989

Property Type Military

Applicable Criteria G

(Discuss importance in terms of historical or architectural context as defined by theme, period, and geographic scope. Also address integrity.)

This Cold War-era building is considered a support building, a type found at any Naval installation regardless of mission. It is therefore not of exceptional national significance and is not considered eligible for the National Register of Historic Places (Criterion G).

B11. Additional Resource Attributes: (List attributes and codes) _____

*B12. References:

Real Property Form

B13. Remarks:

*B14. Evaluator: Alexandra C. Cole

Date of Evaluation: 05/01/1998

(This space reserved for official comments.)

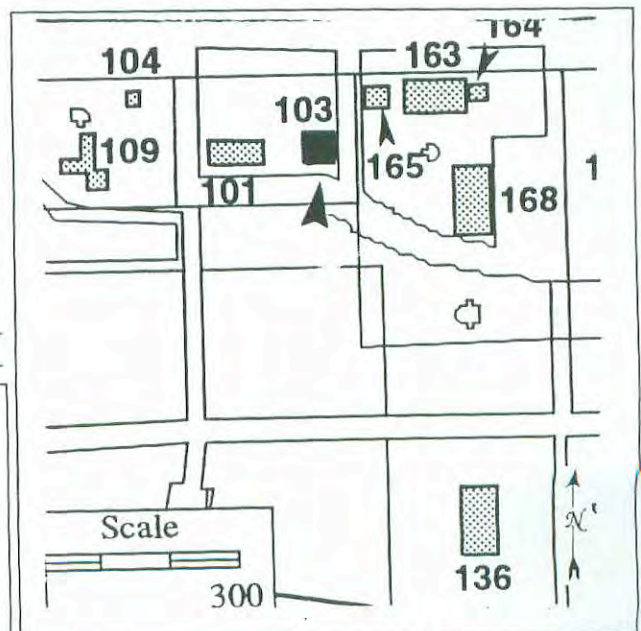

PRIMARY RECORD

Primary # _____
HRI # _____
Trinomial _____
NRHP Status Code 6Z

Other Listings _____
Review Code _____ Reviewer _____ Date ____/____/____

Page 1 of 2

*Resource Name or #: 104, NASA Crows Landing

P1. Other Identifier: Radio Beacon Tower

*P2. Location: Not for Publication Unrestricted a. County Stanislaus

b. USGS 7.5' Quad _____ Date _____ T _____; R _____; _____ 1/4 of _____ 1/4 of Sec _____; _____ B.M.

c. Address NASA C.L. Flight Facility City Crows Landing Zip 95313

d. UTM: (Give more than one for large and/or linear feature) Zone _____, _____ mE/ _____ mN

e. Other Locational Data: (e.g. parcel #, legal description, directions to resource, elevation, additional UTM's, etc. as appropriate)

*P3a. Description: (Describe resource and its major elements. Include design, materials, condition, alterations, size, setting, and boundaries.)

Building 104 consists of a metal scaffolding tower, 14'x 14' at its base, rising to 74'. A beacon tops the tower.

*P3b. Resources Attributes: (List attributes and codes) HP34. Military Property

*P4. Resources Present: Building Structure Object Site District Element of District Other (Isolates, etc.)

P5b. Description of Photo: (View, date, etc.)
East,

April 1998, Roll 6-4

*P6. Date Constructed/Age and Sources:
 Prehistoric Historic Both
1953

*P7. Owner and Address:
U.S.A. as represented by
National Aeronautics and Space
Administration, Washington, D.C.

*P8. Recorded by: (Name, affiliation, address)
Alexandra C. Cole, SAIC
816 State Street, Suite 500
Santa Barbara, CA 93101

*P9. Date Recorded: 06/29/1998

*P10. Survey Type: (Describe)
Comprehensive Survey for Section
106 Compliance



*P11. Report Citation: (Cite survey report/other sources or "none") Inventory and Evaluation of Cold War Era Historical Resources, NASA Crows Landing

*Attachments: NONE Location Map Sketch Map Continuation Sheet Building, Structure and Object Record
 Archaeological Record District Record Linear Feature Record Milling Station Record Rock Art Record Artifact Record
 Photograph Record Other: (List) _____

BUILDING, STRUCTURE, AND OBJECT RECORD

Page 2 of 2

*NRHP Status Code 6Z

*Resource Name or #: 104, NASA Crows Landing

B1. Historic Name: Unknown

B2. Common Name: Unknown

B3. Original Use: Radio Beacon Tower

B4. Present Use: V--Vacant

*B5. Architectural Style: No Style

*B6. Construction History: (Construction date, alterations, and date of alterations.)

1953

*B7. Moved? No Yes Unknown Date: _____ Original Location: _____

*B8. Related Features:

B9a. Architect: Unknown

b. Builder: Unknown

*B10. Significance: Theme Cold War

Area United States

Period of Significance 1946-1989

Property Type Military

Applicable Criteria G

(Discuss importance in terms of historical or architectural context as defined by theme, period, and geographic scope. Also address integrity.)

This Cold War-era building is considered a support building, a type found at any Naval installation regardless of mission. It is therefore not of exceptional national significance and is not considered eligible for the National Register of Historic Places (Criterion G).

B11. Additional Resource Attributes: (List attributes and codes) _____

*B12. References:

Real Property Form

B13. Remarks:

*B14. Evaluator: Alexandra C. Cole

Date of Evaluation: 05/01/1998

(This space reserved for official comments.)

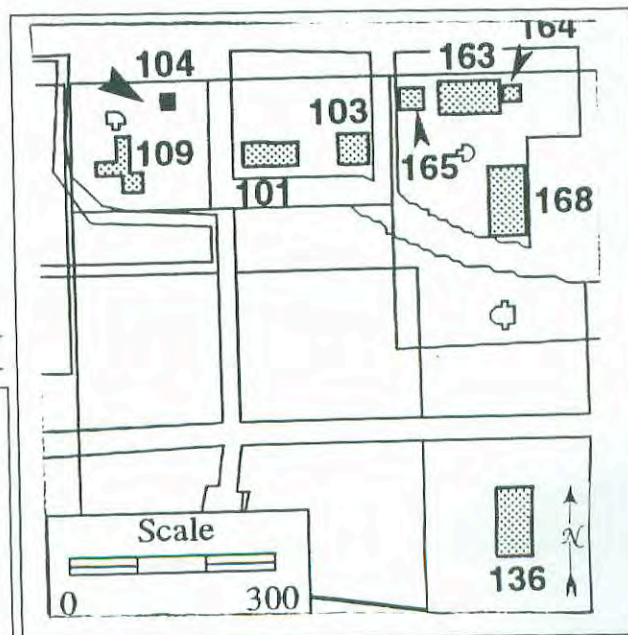

*Required information

PRIMARY RECORD

Primary # _____
HRI # _____
Trinomial _____
NRHP Status Code 6Z

Other Listings _____
Review Code _____ Reviewer _____ Date / /

Page 1 of 2

*Resource Name or #: 109, NASA Crows Landing

P1. Other Identifier: Administration

*P2. Location: Not for Publication Unrestricted a. County Stanislaus
b. USGS 7.5' Quad _____ Date _____ T _____; R _____; _____ 1/4 of _____ 1/4 of Sec _____; _____ B.M.
c. Address NASA C.L. Flight Facility City Crows Landing Zip 95313
d. UTM: (Give more than one for large and/or linear feature) Zone _____, _____ mE/ _____ mN
e. Other Locational Data: (e.g. parcel #, legal description, directions to resource, elevation, additional UTM's, etc. as appropriate)

*P3a. Description: (Describe resource and its major elements. Include design, materials, condition, alterations, size, setting, and boundaries.)

Building 109 is a one-story rectangular building with a two-story wing to the north and a high one-story fire station attached to the west. The windows are fixed and transom in metal sash. High roll-up doors provide access on the north and south sides of the fire station, and on the north side of the two-story wing. Single and double doors with glass upper panes provide access to the administration building.

*P3b. Resources Attributes: (List attributes and codes) HP34. Military Property

*P4. Resources Present: Building Structure Object Site District Element of District Other (Isolates, etc.)

P5b. Description of Photo: (View, date, etc.)
Northeast,

April 1998, Roll 6-5

*P6. Date Constructed/Age and Sources:
 Prehistoric Historic Both
1957

*P7. Owner and Address:
U.S.A. as represented by
National Aeronautics and Space
Administration, Washington, D.C.

*P8. Recorded by: (Name, affiliation, address)
Alexandra C. Cole, SAIC
816 State Street, Suite 500
Santa Barbara, CA 93101

*P9. Date Recorded: 06/30/1998

*P10. Survey Type: (Describe)
Comprehensive Survey for Section
106



*P11. Report Citation: (Cite survey report/other sources or "none") Inventory and Evaluation of Cold War Era Historical Resources, NASA Crows Landing

*Attachments: NONE Location Map Sketch Map Continuation Sheet Building, Structure and Object Record
 Archaeological Record District Record Linear Feature Record Milling Station Record Rock Art Record Artifact Record
 Photograph Record Other: (List) _____

BUILDING, STRUCTURE, AND OBJECT RECORD

Page 2 of 2

*NRHP Status Code 6Z

*Resource Name or #: 109, NASA Crows Landing

B1. Historic Name: Unknown

B2. Common Name: Unknown

B3. Original Use: Administration

B4. Present Use: Fire/Air Crash/ Rescue Station

*B5. Architectural Style: No Style

*B6. Construction History: (Construction date, alterations, and date of alterations.)

1957

*B7. Moved? No Yes Unknown Date: _____ Original Location: _____

*B8. Related Features:

B9a. Architect: Unknown b. Builder: Unknown

*B10. Significance: Theme Cold War Area United States

Period of Significance 1946-1989 Property Type Military Applicable Criteria G

(Discuss importance in terms of historical or architectural context as defined by theme, period, and geographic scope. Also address integrity.)

This Cold War-era building is considered a support building, a type found at any Naval installation regardless of mission. It is therefore not of exceptional national significance and is not considered eligible for the National Register of Historic Places (Criterion G).

B11. Additional Resource Attributes: (List attributes and codes) _____

*B12. References:

Real Property Form

B13. Remarks:

*B14. Evaluator: Alexandra C. Cole

Date of Evaluation: 05/01/1998

(This space reserved for official comments.)

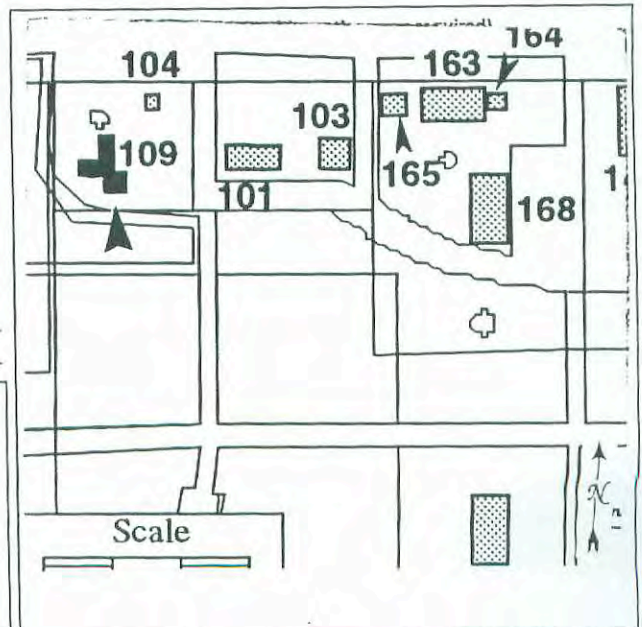

*Required information

PRIMARY RECORD

Primary # _____
HRI # _____
Trinomial _____
NRHP Status Code 6Z

Other Listings _____
Review Code _____ Reviewer _____ Date / / _____

Page 1 of 2

*Resource Name or #: 120, NASA Crows Landing

P1. Other Identifier: Compass Rose

*P2. Location: Not for Publication Unrestricted a. County Stanislaus

b. USGS 7.5' Quad _____ Date _____ T _____; R _____; _____ 1/4 of _____ 1/4 of Sec _____; _____ B.M.

c. Address NASA C.L. Flight Facility City Crows Landing Zip 95313

d. UTM: (Give more than one for large and/or linear feature) Zone _____, _____ mE/ _____ mN

e. Other Locational Data: (e.g. parcel #, legal description, directions to resource, elevation, additional UTM's, etc. as appropriate)

*P3a. Description: (Describe resource and its major elements. Include design, materials, condition, alterations, size, setting, and boundaries.)
This compass rose is a large circular concrete pad with a central iron ring and lines radiating from the center corresponding to the compass points. It was used to calibrate aircraft compasses.

*P3b. Resources Attributes: (List attributes and codes) HP34. Military Property

*P4. Resources Present: Building Structure Object Site District Element of District Other (Isolates, etc.)



P5b. Description of Photo: (View, date, etc.)
South,

April 1998, Roll 6-3

*P6. Date Constructed/Age and Sources:
 Prehistoric Historic Both
1944

*P7. Owner and Address:
U.S.A. as represented by
National Aeronautics and Space
Administration, Washington, D.C.

*P8. Recorded by: (Name, affiliation, address)
Alexandra C. Cole, SAIC
816 State Street, Suite 500
Santa Barbara, CA 93101

*P9. Date Recorded: 06/29/1998

*P10. Survey Type: (Describe)
Comprehensive Survey for Section
106 Compliance

*P11. Report Citation: (Cite survey report/other sources or "none") Inventory and Evaluation of Cold War Era Historical Resources, NASA Crows Landing

*Attachments: NONE Location Map Sketch Map Continuation Sheet Building, Structure and Object Record
 Archaeological Record District Record Linear Feature Record Milling Station Record Rock Art Record Artifact Record
 Photograph Record Other: (List) _____

BUILDING, STRUCTURE, AND OBJECT RECORD

Page 2 of 2

*NRHP Status Code 6Z

*Resource Name or #: 120, NASA Crows Landing

B1. Historic Name: Unknown

B2. Common Name: Unknown

B3. Original Use: Compass Rose B4. Present Use: Vacant

*B5. Architectural Style: No Style

*B6. Construction History: (Construction date, alterations, and date of alterations.)
1944

*B7. Moved? No Yes Unknown Date: _____ Original Location: _____

*B8. Related Features:

B9a. Architect: Unknown b. Builder: Unknown

*B10. Significance: Theme Cold War Area United States

Period of Significance 1946-1989 Property Type Military Applicable Criteria G

(Discuss importance in terms of historical or architectural context as defined by theme, period, and geographic scope. Also address integrity.)

This Cold War-era building is considered a support building, a type found at any Naval installation regardless of mission. It is therefore not of exceptional national significance and is not considered eligible for the National Register of Historic Places (Criterion G).

B11. Additional Resource Attributes: (List attributes and codes) _____

*B12. References:
Real Property Form

B13. Remarks:

*B14. Evaluator: Alexandra C. Cole

Date of Evaluation: 05/01/1998

(This space reserved for official comments.)

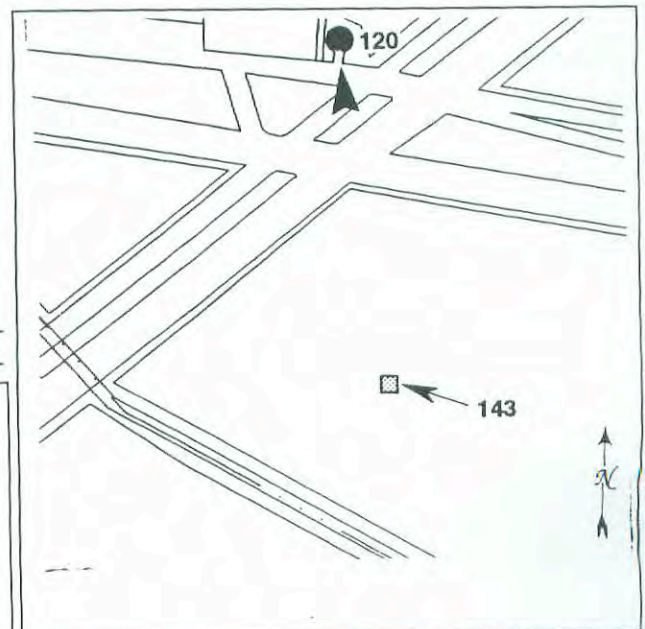

PRIMARY RECORD

Primary # _____
HRI # _____
Trinomial _____
NRHP Status Code 6Z

Other Listings _____
Review Code _____ Reviewer _____ Date / /

Page 1 of 2

*Resource Name or #: 136, NASA Crows Landing

P1. Other Identifier: Security

*P2. Location: Not for Publication Unrestricted a. County Stanislaus
b. USGS 7.5' Quad _____ Date _____ T _____; R _____; _____ 1/4 of _____ 1/4 of Sec _____; _____ B.M.
c. Address NASA C.L. Flight Facility City Crows Landing Zip 95313
d. UTM: (Give more than one for large and/or linear feature) Zone _____, _____ mE/ _____ mN
e. Other Locational Data: (e.g. parcel #, legal description, directions to resource, elevation, additional UTM's, etc. as appropriate)

*P3a. Description: (Describe resource and its major elements. Include design, materials, condition, alterations, size, setting, and boundaries.)

Building 136 is a 40'x 60' rectangular pre-fabricated metal building with a medium-pitched gable roof. Sliding metal doors and metal single doors with double panes provide access on the south and east sides. Fixed and transom multi-paned windows in metal sash light the north, east and south sides.

*P3b. Resources Attributes: (List attributes and codes) HP34. Military Property

*P4. Resources Present: Building Structure Object Site District Element of District Other (Isolates, etc.)



P5b. Description of Photo: (View, date, etc.)
Northwest,

April 1998, Roll 5-29

*P6. Date Constructed/Age and Sources:
 Prehistoric Historic Both
1958

*P7. Owner and Address:
U.S.A. as represented by
National Aeronautics and Space
Administration, Washington, D.C.

*P8. Recorded by: (Name, affiliation, address)
Alexandra C. Cole, SAIC
816 State Street, Suite 500
Santa Barbara, CA 93101

*P9. Date Recorded: 06/29/1998

*P10. Survey Type: (Describe)
Comprehensive Survey for Section
106 Compliance

*P11. Report Citation: (Cite survey report/other sources or "none") Inventory and Evaluation of Cold War Era Historical Resources, NASA Crows Landing

*Attachments: NONE Location Map Sketch Map Continuation Sheet Building, Structure and Object Record
 Archaeological Record District Record Linear Feature Record Milling Station Record Rock Art Record Artifact Record
 Photograph Record Other: (List) _____

BUILDING, STRUCTURE, AND OBJECT RECORD

Page 2 of 2

*NRHP Status Code 6Z

*Resource Name or #: 136, NASA Crows Landing

B1. Historic Name: Unknown

B2. Common Name: Unknown

B3. Original Use: Aircraft Maintenance Shop B4. Present Use: V--Vacant

*B5. Architectural Style: No Style

*B6. Construction History: (Construction date, alterations, and date of alterations.)

1958

*B7. Moved? No Yes Unknown Date: _____ Original Location: _____

*B8. Related Features:

B9a. Architect: Unknown b. Builder: Unknown

*B10. Significance: Theme Cold War Area United States
Period of Significance 1946-1989 Property Type Military Applicable Criteria G

(Discuss importance in terms of historical or architectural context as defined by theme, period, and geographic scope. Also address integrity.)

This Cold War-era building is considered a support building, a type found at any Naval installation regardless of mission. It is therefore not of exceptional national significance and is not considered eligible for the National Register of Historic Places (Criterion G).

B11. Additional Resource Attributes: (List attributes and codes) _____

*B12. References:

Real Property Form

B13. Remarks:

*B14. Evaluator: Alexandra C. Cole

Date of Evaluation: 05/01/1998

(This space reserved for official comments.)

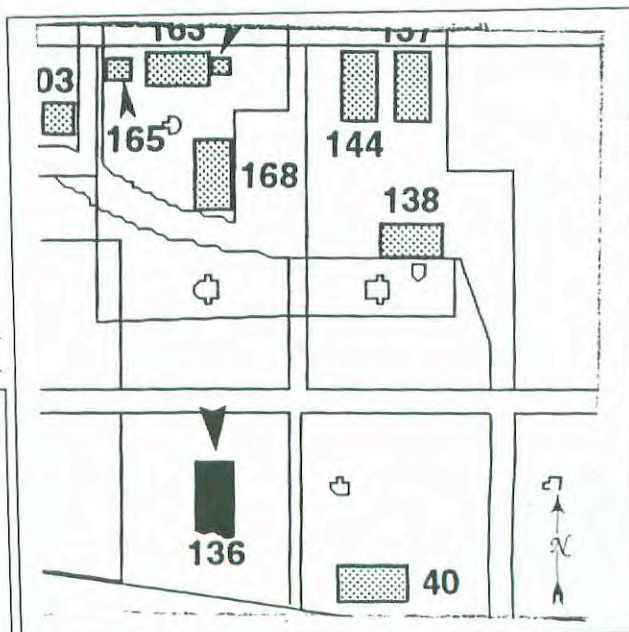

*Required information

PRIMARY RECORD

Primary # _____
HRI # _____
Trinomial _____
NRHP Status Code 6Z

Other Listings _____
Review Code _____ Reviewer _____ Date / /

Page 1 of 2

*Resource Name or #: 137, NASA Crows Landing

P1. Other Identifier: Storage

*P2. Location: Not for Publication Unrestricted a. County Stanislaus

b. USGS 7.5' Quad _____ Date _____ T _____; R _____; _____ 1/4 of _____ 1/4 of Sec _____; _____ B.M.

c. Address NASA C.L. Flight Facility City Crows Landing Zip 95313

d. UTM: (Give more than one for large and/or linear feature) Zone _____, _____ mE/ _____ mN

e. Other Locational Data: (e.g. parcel #, legal description, directions to resource, elevation, additional UTMs, etc. as appropriate)

*P3a. Description: (Describe resource and its major elements. Include design, materials, condition, alterations, size, setting, and boundaries.)

Building 137 is a 40'x 60' pre-fabricated metal building with a medium-pitched roof on a concrete foundation. Sliding metal doors or metal single doors provide access on the east and west sides. Fixed and transom windows in metal frames light the east, north and west sides.

*P3b. Resources Attributes: (List attributes and codes) HP34. Military Property

*P4. Resources Present: Building Structure Object Site District Element of District Other (Isolates, etc.)



P5b. Description of Photo: (View, date, etc.)
Northwest,

April 1998, Roll 5-26

*P6. Date Constructed/Age and Sources:
 Prehistoric Historic Both
1959

*P7. Owner and Address:
U.S.A. as represented by
National Aeronautics and Space
Administration, Washington, D.C.

*P8. Recorded by: (Name, affiliation, address)
Alexandra C. Cole, SAIC
816 State Street, Suite 500
Santa Barbara, CA 93101

*P9. Date Recorded: 06/29/1998

*P10. Survey Type: (Describe)
Comprehensive Survey for Section
106 Compliance

*P11. Report Citation: (Cite survey report/other sources or "none") Inventory and Evaluation of Cold War Era Historical
Resources, NASA Crows Landind

*Attachments: NONE Location Map Sketch Map Continuation Sheet Building, Structure and Object Record
 Archaeological Record District Record Linear Feature Record Milling Station Record Rock Art Record Artifact Record
 Photograph Record Other: (List) _____

BUILDING, STRUCTURE, AND OBJECT RECORD

Page 2 of 2

*NRHP Status Code 6Z

*Resource Name or #: 137, NASA Crows Landing

B1. Historic Name: Unknown

B2. Common Name: Unknown

B3. Original Use: Storage Supply/ Electronics B4. Present Use: V--Vacant

*B5. Architectural Style: No Style

*B6. Construction History: (Construction date, alterations, and date of alterations.)
1959

*B7. Moved? No Yes Unknown Date: _____ Original Location: _____

*B8. Related Features:

B9a. Architect: Unknown b. Builder: Unknown

*B10. Significance: Theme Cold War Area United States

Period of Significance 1946-1989 Property Type Military Applicable Criteria G

(Discuss importance in terms of historical or architectural context as defined by theme, period, and geographic scope. Also address integrity.)

This Cold War-era building is considered a support building, a type found at any Naval installation regardless of mission. It is therefore not of exceptional national significance and is not considered eligible for the National Register of Historic Places (Criterion G).

B11. Additional Resource Attributes: (List attributes and codes) _____

*B12. References:
Real Property Form

B13. Remarks:

*B14. Evaluator: Alexandra C. Cole

Date of Evaluation: 05/01/1998

(This space reserved for official comments.)

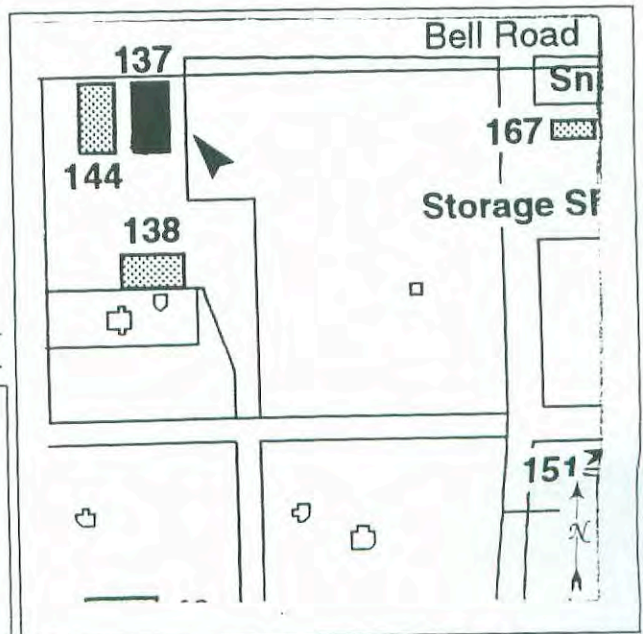

PRIMARY RECORD

Primary # _____
HRI # _____
Trinomial _____
NRHP Status Code 6Z

Other Listings _____
Review Code _____ Reviewer _____ Date / /

Page 1 of 2

*Resource Name or #: 138, NASA Crows Landing

P1. Other Identifier: Transportation

*P2. Location: Not for Publication Unrestricted a. County Stanislaus
b. USGS 7.5' Quad _____ Date _____ T _____; R _____; _____ 1/4 of _____ 1/4 of Sec _____; _____ B.M.
c. Address NASA C.L. Flight Facility City Crows Landing Zip 95313
d. UTM: (Give more than one for large and/or linear feature) Zone _____, _____ mE/ _____ mN
e. Other Locational Data: (e.g. parcel #, legal description, directions to resource, elevation, additional UTM's, etc. as appropriate)

*P3a. Description: (Describe resource and its major elements. Include design, materials, condition, alterations, size, setting, and boundaries.)
Building 138 is a 41' x 62' pre-fabricated metal building on a concrete foundation. Two vents pierce the medium-pitched gable roof. Access is provided on the south by a high roll-up door, on the east by a metal single door with double-pane windows, and on the north by two metal roll-up doors. Fixed and transom windows in metal sash are located on the west and south sides.

*P3b. Resources Attributes: (List attributes and codes) HP34. Military Property

*P4. Resources Present: Building Structure Object Site District Element of District Other (Isolates, etc.)



P5b. Description of Photo: (View, date, etc.)
Northwest,
April 1998, Roll 5-28

*P6. Date Constructed/Age and Sources:
 Prehistoric Historic Both
1959

*P7. Owner and Address:
U.S.A. as represented by
National Aeronautics and Space
Administration, Washington, D.C.

*P8. Recorded by: (Name, affiliation, address)
Alexandra C. Cole, SAIC
816 State Street, Suite 500
Santa Barbara, CA 93101

*P9. Date Recorded: 06/29/1998

*P10. Survey Type: (Describe)
Comprehensive Survey for Section
106 Compliance

*P11. Report Citation: (Cite survey report/other sources or "none") Inventory and Evaluation of Cold War Era Historical
Resources, NASA Crows Landing

*Attachments: NONE Location Map Sketch Map Continuation Sheet Building, Structure and Object Record
 Archaeological Record District Record Linear Feature Record Milling Station Record Rock Art Record Artifact Record
 Photograph Record Other: (List) _____

BUILDING, STRUCTURE, AND OBJECT RECORD

Page 2 of 2

*NRHP Status Code 6Z

*Resource Name or #: 138, NASA Crows Landing

B1. Historic Name: Unknown

B2. Common Name: Unknown

B3. Original Use: Transportation

B4. Present Use: V--Vacant

*B5. Architectural Style: No Style

*B6. Construction History: (Construction date, alterations, and date of alterations.)

1959

*B7. Moved? No Yes Unknown Date: _____ Original Location: _____

*B8. Related Features:

B9a. Architect: Unknown

b. Builder: Edward A. Tomlinson, Modesto

*B10. Significance: Theme Cold War

Area United States

Period of Significance 1946-1989

Property Type Military

Applicable Criteria G

(Discuss importance in terms of historical or architectural context as defined by theme, period, and geographic scope. Also address integrity.)

This Cold War-era building is considered a support building, a type found at any Naval installation regardless of mission. It is therefore not of exceptional national significance and is not considered eligible for the National Register of Historic Places (Criterion G).

B11. Additional Resource Attributes: (List attributes and codes) _____

*B12. References:

Real Property Form

B13. Remarks:

*B14. Evaluator: Alexandra C. Cole

Date of Evaluation: 05/01/1998

(This space reserved for official comments.)

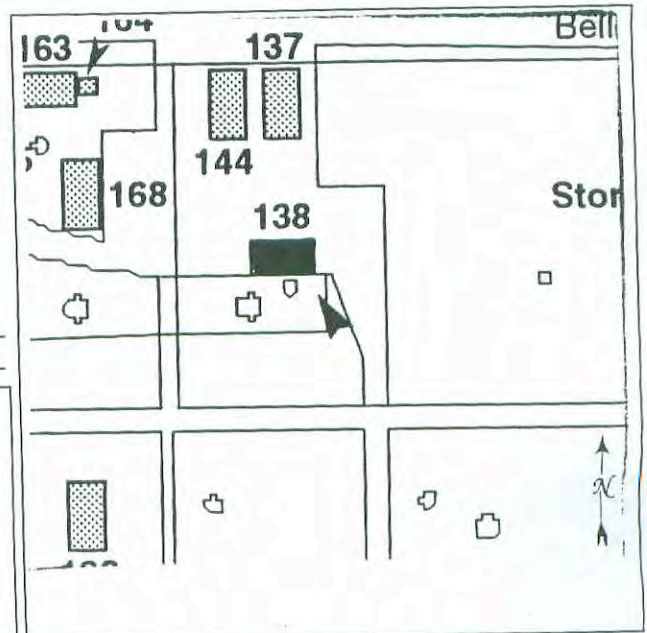

*Required information

PRIMARY RECORD

Primary # _____
HRI # _____
Trinomial _____
NRHP Status Code 6Z

Other Listings _____
Review Code _____ Reviewer _____ Date / /

Page 1 of 2

*Resource Name or #: 143, NASA Crows Landing

P1. Other Identifier: TACAN

*P2. Location: Not for Publication Unrestricted a. County Stanislaus

b. USGS 7.5' Quad _____ Date _____ T _____; R _____; _____ 1/4 of _____ 1/4 of Sec _____; _____ B.M.

c. Address NASA C.L. Flight Facility City Crows Landing Zip 95313

d. UTM: (Give more than one for large and/or linear feature) Zone _____, _____ mE/ _____ mN

e. Other Locational Data: (e.g. parcel #, legal description, directions to resource, elevation, additional UTM's, etc. as appropriate)

*P3a. Description: (Describe resource and its major elements. Include design, materials, condition, alterations, size, setting, and boundaries.)

This small square concrete block one-story building has a metal shed roof. Metal single and double doors provide access on the east side. Metal louvers vent the north, west, and east sides. The TACAN equipment sits on metal scaffolding on the roof.

*P3b. Resources Attributes: (List attributes and codes) HP34. Military Property

*P4. Resources Present: Building Structure Object Site District Element of District Other (Isolates, etc.)



P5b. Description of Photo: (View, date, etc.)
Northwest,

April 1998, Roll 5-17

*P6. Date Constructed/Age and Sources:
 Prehistoric Historic Both
1959

*P7. Owner and Address:
U.S.A. as represented by
National Aeronautics and Space
Administration, Washington, D.C.

*P8. Recorded by: (Name, affiliation, address)
Alexandra C. Cole, SAIC
816 State Street, Suite 500
Santa Barbara, CA 93101

*P9. Date Recorded: 06/29/1998

*P10. Survey Type: (Describe)
Comprehensive Survey for Section
106 Compliance

*P11. Report Citation: (Cite survey report/other sources or "none") Inventory and Evaluation of Cold War Era Historical Resources, NASA Crows Landing

*Attachments: NONE Location Map Sketch Map Continuation Sheet Building, Structure and Object Record
 Archaeological Record District Record Linear Feature Record Milling Station Record Rock Art Record Artifact Record
 Photograph Record Other: (List) _____

BUILDING, STRUCTURE, AND OBJECT RECORD

Page 2 of 2

*NRHP Status Code 6Z

*Resource Name or #: 143, NASA Crows Landing

B1. Historic Name: Unknown

B2. Common Name: Unknown

B3. Original Use: TACAN Site B4. Present Use: V--Vacant

*B5. Architectural Style: No Style

*B6. Construction History: (Construction date, alterations, and date of alterations.)

1959

*B7. Moved? No Yes Unknown Date: _____ Original Location: _____

*B8. Related Features:

B9a. Architect: Unknown b. Builder: Charles I. Cunningham

*B10. Significance: Theme Cold War Area United States

Period of Significance 1946-1989 Property Type Military Applicable Criteria G

(Discuss importance in terms of historical or architectural context as defined by theme, period, and geographic scope. Also address integrity.)

This Cold War-era building is considered a support building, a type found at any Naval installation regardless of mission. It is therefore not of exceptional national significance and is not considered eligible for the National Register of Historic Places (Criterion G).

B11. Additional Resource Attributes: (List attributes and codes) _____

*B12. References:
Real Property Form

B13. Remarks:

*B14. Evaluator: Alexandra C. Cole

Date of Evaluation: 05/01/1998

(This space reserved for official comments.)

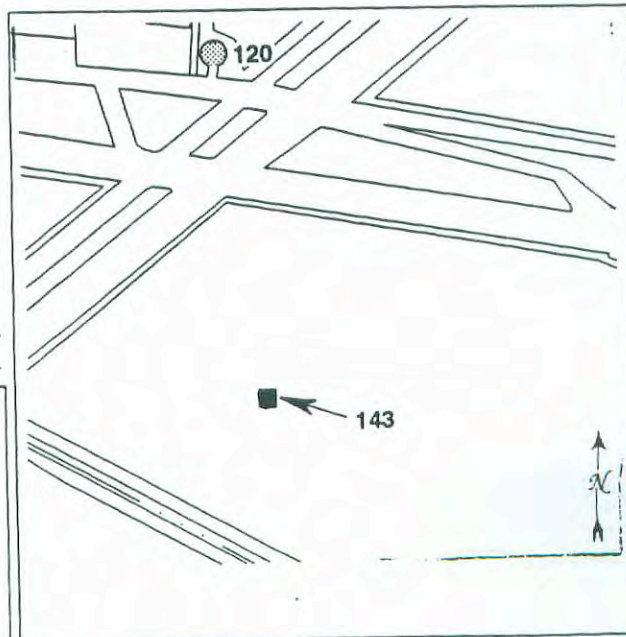

*Required information

PRIMARY RECORD

Primary # _____
HRI # _____
Trinomial _____
NRHP Status Code 6Z

Other Listings _____
Review Code _____ Reviewer _____ Date / /

Page 1 of 2

*Resource Name or #: 144, NASA Crows Landing

P1. Other Identifier: Shop

*P2. Location: Not for Publication Unrestricted a. County Stanislaus
b. USGS 7.5' Quad _____ Date _____ T _____; R _____; _____ 1/4 of _____ 1/4 of Sec _____; _____ B.M.
c. Address NASA C.L. Flight Facility City Crows Landing Zip 95313
d. UTM: (Give more than one for large and/or linear feature) Zone _____, _____ mE/ _____ mN
e. Other Locational Data: (e.g. parcel #, legal description, directions to resource, elevation, additional UTM, etc. as appropriate)

*P3a. Description: (Describe resource and its major elements. Include design, materials, condition, alterations, size, setting, and boundaries.)

Building 144 is a 40'x 60' pre-fabricated metal building on a concrete foundation. Two vents pierce the medium-pitched gable roof. Sliding metal doors provide access on the east and west sides; metal single doors with double windows are located on the west and south sides. Fixed and transom windows in metal sash light all sides.

*P3b. Resources Attributes: (List attributes and codes) HP34. Military Property

*P4. Resources Present: Building Structure Object Site District Element of District Other (Isolates, etc.)

P5b. Description of Photo: (View, date, etc.)
Northwest,
April 1998, Roll 5-27

*P6. Date Constructed/Age and Sources:
 Prehistoric Historic Both
1959

*P7. Owner and Address:
U.S.A. as represented by
National Aeronautics and Space
Administration, Washington, D.C.

*P8. Recorded by: (Name, affiliation, address)
Alexandra C. Cole, SAIC
816 State Street, Suite 500
Santa Barbara, CA 93101

*P9. Date Recorded: 06/30/1998

*P10. Survey Type: (Describe)
Comprehensive Survey for Section
106 Compliance



*P11. Report Citation: (Cite survey report/other sources or "none") Inventory and Evaluation of Cold War Era Historical Resources, NASA Crows Landing

*Attachments: NONE Location Map Sketch Map Continuation Sheet Building, Structure and Object Record
 Archaeological Record District Record Linear Feature Record Milling Station Record Rock Art Record Artifact Record
 Photograph Record Other: (List) _____

BUILDING, STRUCTURE, AND OBJECT RECORD

Page 2 of 2

*NRHP Status Code 6Z

*Resource Name or #: 144, NASA Crows Landing

B1. Historic Name: Unknown

B2. Common Name: Unknown

B3. Original Use: Public Works Shop

B4. Present Use: V--Vacant

*B5. Architectural Style: No Style

*B6. Construction History: (Construction date, alterations, and date of alterations.)

1959

*B7. Moved? No Yes Unknown Date: _____ Original Location: _____

*B8. Related Features:

B9a. Architect: Unknown

b. Builder: Edward A. Tomlinson, Modesto

*B10. Significance: Theme Cold War

Area United States

Period of Significance 1946-1989

Property Type Military

Applicable Criteria G

(Discuss importance in terms of historical or architectural context as defined by theme, period, and geographic scope. Also address integrity.)

This Cold War-era building is considered a support building, a type found at any Naval installation regardless of mission. It is therefore not of exceptional national significance and is not considered eligible for the National Register of Historic Places (Criterion G).

B11. Additional Resource Attributes: (List attributes and codes) _____

*B12. References:

Real Property Form

B13. Remarks:

*B14. Evaluator: Alexandra C. Cole

Date of Evaluation: 05/01/1998

(This space reserved for official comments.)

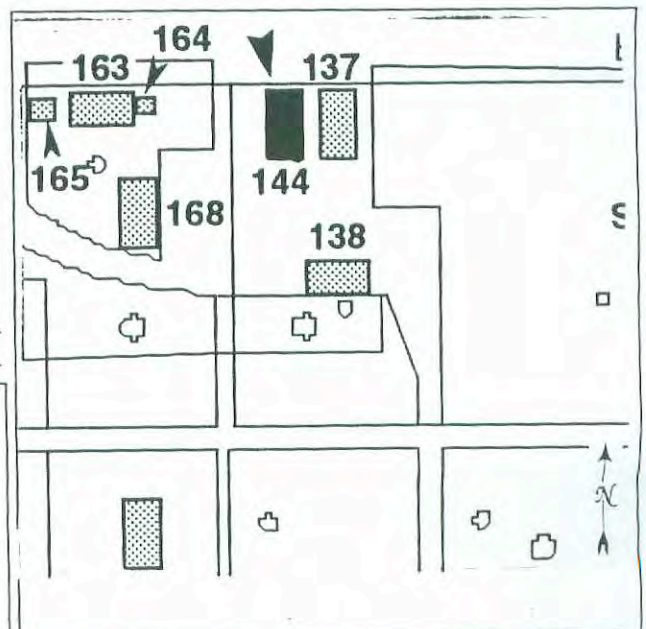

PRIMARY RECORD

Primary # _____
HRI # _____
Trinomial _____
NRHP Status Code 6Z

Other Listings _____
Review Code _____ Reviewer _____ Date / /

Page 1 of 2

*Resource Name or #: 150, NASA Crows Landing

P1. Other Identifier: Water Pump Station

*P2. Location: Not for Publication Unrestricted a. County Stanislaus

b. USGS 7.5' Quad _____ Date _____ T _____; R _____; _____ 1/4 of _____ 1/4 of Sec _____; _____ B.M.

c. Address NASA C.L. Flight Facility City Crows Landing Zip 95313

d. UTM: (Give more than one for large and/or linear feature) Zone _____, _____ mE/ _____ mN

e. Other Locational Data: (e.g. parcel #, legal description, directions to resource, elevation, additional UTM's, etc. as appropriate)

*P3a. Description: (Describe resource and its major elements. Include design, materials, condition, alterations, size, setting, and boundaries.)

This small pre-fabricated metal Butler building has a four-pane metal sash window on the south side and a metal double door on the east side. A vent pierces the gable roof.

*P3b. Resources Attributes: (List attributes and codes) HP34. Military Property

*P4. Resources Present: Building Structure Object Site District Element of District Other (Isolates, etc.)



P5b. Description of Photo: (View, date, etc.)
Northwest,

April 1998, Roll 5-20

*P6. Date Constructed/Age and Sources:
 Prehistoric Historic Both
1943

*P7. Owner and Address:
U.S.A. as represented by
National Aeronautics and Space
Administration, Washington, D.C.

*P8. Recorded by: (Name, affiliation, address)
Alexandra C. Cole, SAIC
816 State Street, Suite 500
Santa Barbara, CA 93101

*P9. Date Recorded: 06/29/1998

*P10. Survey Type: (Describe)
Comprehensive Survey for Section
106 Compliance

*P11. Report Citation: (Cite survey report/other sources or "none") Inventory and Evaluation of Cold War Era Historical Resources, NASA Crows Landing

*Attachments: NONE Location Map Sketch Map Continuation Sheet Building, Structure and Object Record
 Archaeological Record District Record Linear Feature Record Milling Station Record Rock Art Record Artifact Record
 Photograph Record Other: (List) _____

BUILDING, STRUCTURE, AND OBJECT RECORD

Page 2 of 2

*NRHP Status Code 6Z

*Resource Name or #: 150, NASA Crows Landing

B1. Historic Name: Unknown

B2. Common Name: Unknown

B3. Original Use: Water Pump Station B4. Present Use: Vacant-capped off

*B5. Architectural Style: No Style

*B6. Construction History: (Construction date, alterations, and date of alterations.)
1943

*B7. Moved? No Yes Unknown Date: _____ Original Location: _____

*B8. Related Features:
Building 150, a large cylindrical water tank, and Building 151 are enclosed by a chain link fence.

B9a. Architect: Unknown b. Builder: Unknown

*B10. Significance: Theme Cold War Area United States

Period of Significance 1946-1989 Property Type Military Applicable Criteria G

(Discuss importance in terms of historical or architectural context as defined by theme, period, and geographic scope. Also address integrity.)

This Cold War-era building is considered a support building, a type found at any Naval installation regardless of mission. It is therefore not of exceptional national significance and is not considered eligible for the National Register of Historic Places (Criterion G).

B11. Additional Resource Attributes: (List attributes and codes) _____

*B12. References:
Real Property Form

B13. Remarks:

*B14. Evaluator: Alexandra C. Cole
Date of Evaluation: 05/01/1998

(This space reserved for official comments.)

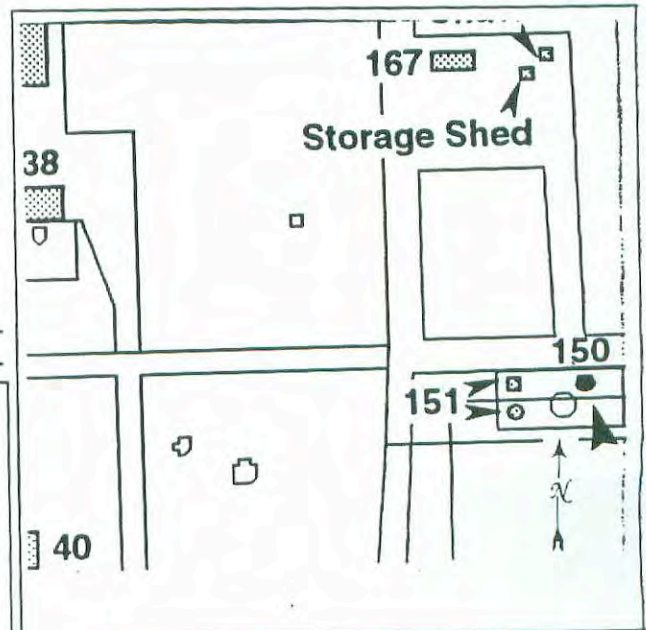

PRIMARY RECORD

Primary # _____
HRI # _____
Trinomial _____
NRHP Status Code 6Z

Other Listings _____
Review Code _____ Reviewer _____ Date / /

Page 1 of 2

*Resource Name or #: 151, NASA Crows Landing

P1. Other Identifier: Pump House, Water Tank

*P2. Location: Not for Publication Unrestricted a. County Stanislaus

b. USGS 7.5' Quad _____ Date _____ T _____; R _____; _____ 1/4 of _____ 1/4 of Sec _____; _____ B.M.

c. Address NASA C.L. Flight Facility City Crows Landing Zip 95313

d. UTM: (Give more than one for large and/or linear feature) Zone _____, _____ mE/ _____ mN

e. Other Locational Data: (e.g. parcel #, legal description, directions to resource, elevation, additional UTM's, etc. as appropriate)

*P3a. Description: (Describe resource and its major elements. Include design, materials, condition, alterations, size, setting, and boundaries.)

Building 151 is a small rectangular flat-roof prefabricated metal building on a concrete slab foundation. It houses two pumps that are attached to a large water tank. Sliding windows in metal sash light the north and west sides, and a metal single door provides access on the east side. The adjacent well pumped the water into the tank. From there the water traveled by gravity flow to pump water for normal use throughout the base or to pump water for fire.

*P3b. Resources Attributes: (List attributes and codes) HP34. Military Property

*P4. Resources Present: Building Structure Object Site District Element of District Other (Isolates, etc.)



P5b. Description of Photo: (View, date, etc.)
Southwest,

April 1998, Roll 5-21

*P6. Date Constructed/Age and Sources:
 Prehistoric Historic Both
1943

*P7. Owner and Address:
U.S.A. as represented by
National Aeronautics and Space
Administration, Washington, D.C.

*P8. Recorded by: (Name, affiliation, address)
Alexandra C. Cole, SAIC
816 State Street, Suite 500
Santa Barbara, CA 93101

*P9. Date Recorded: 06/30/1998

*P10. Survey Type: (Describe)
Comprehensive Survey for Section
106 Compliance

*P11. Report Citation: (Cite survey report/other sources or "none") Inventory and Evaluation of Cold War Era Historical Resources, NASA Crows Landing

*Attachments: NONE Location Map Sketch Map Continuation Sheet Building, Structure and Object Record
 Archaeological Record District Record Linear Feature Record Milling Station Record Rock Art Record Artifact Record
 Photograph Record Other: (List) _____

BUILDING, STRUCTURE, AND OBJECT RECORD

Page 2 of 2

*NRHP Status Code 6Z

*Resource Name or #: 151, NASA Crows Landing

B1. Historic Name: Unknown

B2. Common Name: Unknown

B3. Original Use: Water Storage Tank; Pump House B4. Present Use: Vacant

*B5. Architectural Style: No Style

*B6. Construction History: (Construction date, alterations, and date of alterations.)
1943

*B7. Moved? No Yes Unknown Date: _____ Original Location: _____

*B8. Related Features:

B9a. Architect: Unknown b. Builder: Unknown

*B10. Significance: Theme Cold War Area United States

Period of Significance 1946-1989 Property Type Military Applicable Criteria G

(Discuss importance in terms of historical or architectural context as defined by theme, period, and geographic scope. Also address integrity.)

This Cold War-era building is considered a support building, a type found at any Naval installation regardless of mission. It is therefore not of exceptional national significance and is not considered eligible for the National Register of Historic Places (Criterion G).

B11. Additional Resource Attributes: (List attributes and codes) _____

*B12. References:
Real Property Form

B13. Remarks:

*B14. Evaluator: Alexandra C. Cole

Date of Evaluation: 05/01/1998

(This space reserved for official comments.)

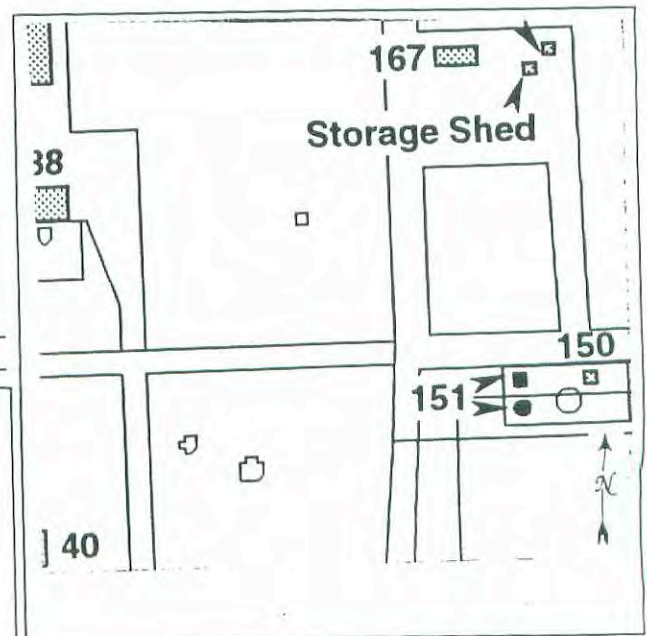

*Required information

PRIMARY RECORD

Primary # _____
HRI # _____
Trinomial _____
NRHP Status Code 6Z

Other Listings _____
Review Code _____ Reviewer _____ Date / /

Page 1 of 2

*Resource Name or #: 163, NASA Crows Landing

P1. Other Identifier: Swimming Pool

*P2. Location: Not for Publication Unrestricted a. County Stanislaus

b. USGS 7.5' Quad _____ Date _____ T _____; R _____; _____ 1/4 of _____ 1/4 of Sec _____; _____ B.M.

c. Address NASA C.L. Flight Facility City Crows Landing Zip 95313

d. UTM: (Give more than one for large and/or linear feature) Zone _____, _____ mE/ _____ mN

e. Other Locational Data: (e.g. parcel #, legal description, directions to resource, elevation, additional UTM's, etc. as appropriate)

*P3a. Description: (Describe resource and its major elements. Include design, materials, condition, alterations, size, setting, and boundaries.)

Building 163 is a gunite swimming pool with a tile coping and concrete steps.

*P3b. Resources Attributes: (List attributes and codes) HP34. Military Property

*P4. Resources Present: Building Structure Object Site District Element of District Other (Isolates, etc.)



P5b. Description of Photo: (View, date, etc.)
Northeast,

April 1998, Roll 5-34

*P6. Date Constructed/Age and Sources:
 Prehistoric Historic Both
1960

*P7. Owner and Address:
U.S.A. as represented by
National Aeronautics and Space
Administration, Washington, D.C.

*P8. Recorded by: (Name, affiliation, address)
Alexandra C. Cole, SAIC
816 State Street, Suite 500
Santa Barbara, CA 93101

*P9. Date Recorded: 06/30/1998

*P10. Survey Type: (Describe)
Comprehensive Survey for Section
106 Compliance

*P11. Report Citation: (Cite survey report/other sources or "none") Inventory and Evaluation of Cold War Era Historical Resources, NASA Crows Landing

*Attachments: NONE Location Map Sketch Map Continuation Sheet Building, Structure and Object Record
 Archaeological Record District Record Linear Feature Record Milling Station Record Rock Art Record Artifact Record
 Photograph Record Other: (List) _____

BUILDING, STRUCTURE, AND OBJECT RECORD

Page 2 of 2

*NRHP Status Code 6Z

*Resource Name or #: 163, NASA Crows Landing

B1. Historic Name: Unknown

B2. Common Name: Unknown

B3. Original Use: Swimming Pool

B4. Present Use: V--Vacant

*B5. Architectural Style: No Style

*B6. Construction History: (Construction date, alterations, and date of alterations.)

1960

*B7. Moved? No Yes Unknown Date: _____ Original Location: _____

*B8. Related Features:

B9a. Architect: Unknown

b. Builder: Dalton Pools, Modesto

*B10. Significance: Theme Cold War

Area United States

Period of Significance 1946-1989

Property Type Military

Applicable Criteria G

(Discuss importance in terms of historical or architectural context as defined by theme, period, and geographic scope. Also address integrity.)

This Cold War-era building is considered a support building, a type found at any Naval installation regardless of mission. It is therefore not of exceptional national significance and is not considered eligible for the National Register of Historic Places (Criterion G).

B11. Additional Resource Attributes: (List attributes and codes) _____

*B12. References:

Real Property Form

B13. Remarks:

*B14. Evaluator: Alexandra C. Cole

Date of Evaluation: 05/01/1998

(This space reserved for official comments.)

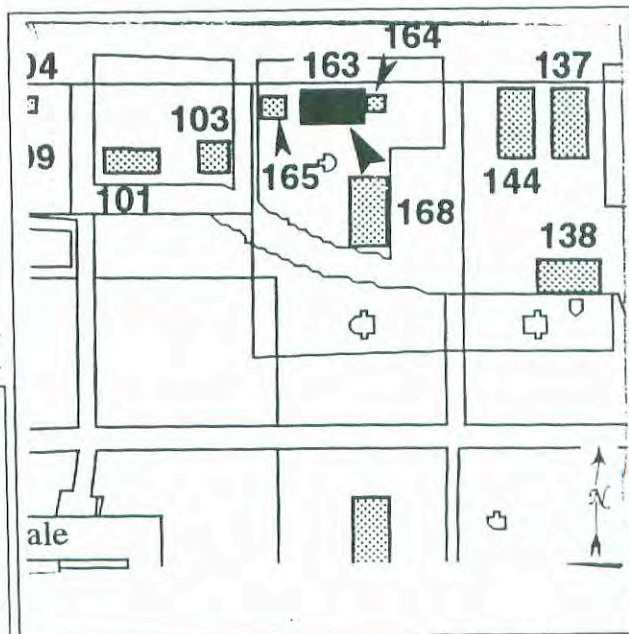

*Required information

PRIMARY RECORD

Primary # _____
HRI # _____
Trinomial _____
NRHP Status Code 6Z

Other Listings _____
Review Code _____ Reviewer _____ Date / /

Page 1 of 2

*Resource Name or #: 164, NASA Crows Landing

P1. Other Identifier: Pool Shed

*P2. Location: Not for Publication Unrestricted a. County Stanislaus
b. USGS 7.5' Quad _____ Date _____ T _____; R _____; _____ 1/4 of _____ 1/4 of Sec _____; _____ B.M.
c. Address NASA C.L. Flight Facility City Crows Landing Zip 95313
d. UTM: (Give more than one for large and/or linear feature) Zone _____, _____ mE/ _____ mN
e. Other Locational Data: (e.g. parcel #, legal description, directions to resource, elevation, additional UTM's, etc. as appropriate)

*P3a. Description: (Describe resource and its major elements. Include design, materials, condition, alterations, size, setting, and boundaries.)
Building 164 is an 8'x 12' plywood shed with a plywood roof and wood double doors. A single metal transom window lights the west side. It housed the pool filter.

*P3b. Resources Attributes: (List attributes and codes) HP34. Military Property

*P4. Resources Present: Building Structure Object Site District Element of District Other (Isolates, etc.)



P5b. Description of Photo: (View, date, etc.)
Southwest,
April 1998, Roll 5-32

*P6. Date Constructed/Age and Sources:
 Prehistoric Historic Both
1960

*P7. Owner and Address:
U.S.A. as represented by
National Aeronautics and Space
Administration, Washington, D.C.

*P8. Recorded by: (Name, affiliation, address)
Alexandra C. Cole, SAIC
816 State Street, Suite 500
Santa Barbara, CA 93101

*P9. Date Recorded: 06/30/1998

*P10. Survey Type: (Describe)
Comprehensive Survey for Section
106 Compliance

*P11. Report Citation: (Cite survey report/other sources or "none") Inventory and Evaluation of Cold War Era Historical
Resources, NASA Crows Landing

*Attachments: NONE Location Map Sketch Map Continuation Sheet Building, Structure and Object Record
 Archaeological Record District Record Linear Feature Record Milling Station Record Rock Art Record Artifact Record
 Photograph Record Other: (List) _____

BUILDING, STRUCTURE, AND OBJECT RECORD

Page 2 of 2

*NRHP Status Code 6Z

*Resource Name or #: 164, NASA Crows Landing

B1. Historic Name: Unknown

B2. Common Name: Unknown

B3. Original Use: Swimming Pool Filter Shed B4. Present Use: V--Vacant

*B5. Architectural Style: No Style

*B6. Construction History: (Construction date, alterations, and date of alterations.)

1960

*B7. Moved? No Yes Unknown Date: _____ Original Location: _____

*B8. Related Features:

B9a. Architect: Unknown b. Builder: Unknown

*B10. Significance: Theme Cold War Area United States

Period of Significance 1946-1989 Property Type Military Applicable Criteria G

(Discuss importance in terms of historical or architectural context as defined by theme, period, and geographic scope. Also address integrity.)

This Cold War-era building is considered a support building, a type found at any Naval installation regardless of mission. It is therefore not of exceptional national significance and is not considered eligible for the National Register of Historic Places.

B11. Additional Resource Attributes: (List attributes and codes) _____

*B12. References:

Real Property Form

B13. Remarks:

*B14. Evaluator: Alexandra C. Cole

Date of Evaluation: 05/01/1998

(This space reserved for official comments.)

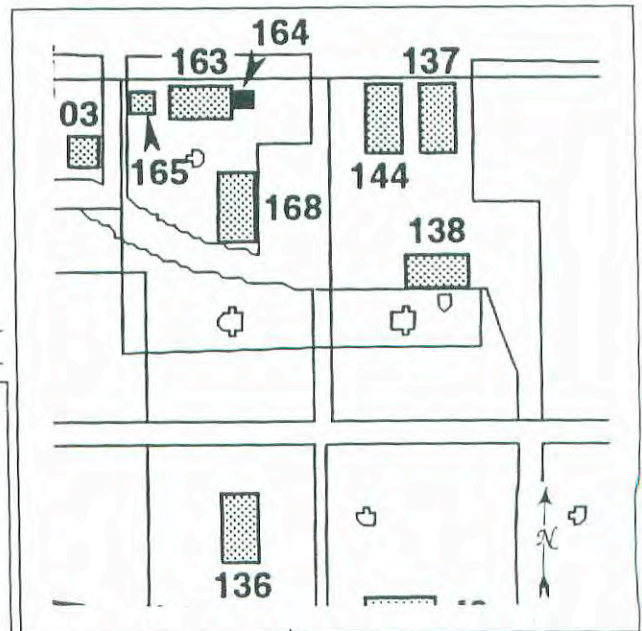

*Required information

PRIMARY RECORD

Primary # _____
HRI # _____
Trinomial _____
NRHP Status Code 6Z

Other Listings _____
Review Code _____ Reviewer _____ Date / /

Page 1 of 2

*Resource Name or #: 165, NASA Crows Landing

P1. Other Identifier: Bath House

*P2. Location: Not for Publication Unrestricted a. County Stanislaus
b. USGS 7.5' Quad _____ Date _____ T _____; R _____; _____ 1/4 of _____ 1/4 of Sec _____; _____ B.M.
c. Address NASA C.L. Flight Facility City Crows Landing Zip 95313
d. UTM: (Give more than one for large and/or linear feature) Zone _____, _____ mE/ _____ mN
e. Other Locational Data: (e.g. parcel #, legal description, directions to resource, elevation, additional UTM, etc. as appropriate)

*P3a. Description: (Describe resource and its major elements. Include design, materials, condition, alterations, size, setting, and boundaries.)
Building 165 is a 15'x 21' concrete block building with a plywood shed roof. Two doors and a snack window are located on the south side. It housed bathrooms, changing rooms and a snack bar.

*P3b. Resources Attributes: (List attributes and codes) HP34. Military Property

*P4. Resources Present: Building Structure Object Site District Element of District Other (Isolates, etc.)

P5b. Description of Photo: (View, date, etc.)
Northeast,

April 1998, Roll 5-33

*P6. Date Constructed/Age and Sources:
 Prehistoric Historic Both
1960

*P7. Owner and Address:
U.S.A. as represented by
National Aeronautics and Space
Administration, Washington, D.C.

*P8. Recorded by: (Name, affiliation, address)
Alexandra C. Cole, SAIC
816 State Street, Suite 500
Santa Barbara, CA 93101

*P9. Date Recorded: 06/30/1998

*P10. Survey Type: (Describe)
Comprehensive Survey for Section
106 Compliance



*P11. Report Citation: (Cite survey report/other sources or "none") Inventory and Evaluation of Cold War Era Historical Resources, NASA Crows Landing

*Attachments: NONE Location Map Sketch Map Continuation Sheet Building, Structure and Object Record
 Archaeological Record District Record Linear Feature Record Milling Station Record Rock Art Record Artifact Record
 Photograph Record Other: (List) _____

BUILDING, STRUCTURE, AND OBJECT RECORD

Page 2 of 2

*NRHP Status Code 6Z

*Resource Name or #: 165, NASA Crows Landing

B1. Historic Name: Unknown

B2. Common Name: Unknown

B3. Original Use: Bath House

B4. Present Use: V--Vacant

*B5. Architectural Style: No Style

*B6. Construction History: (Construction date, alterations, and date of alterations.)

1960

*B7. Moved? No Yes Unknown Date: _____ Original Location: _____

*B8. Related Features:

B9a. Architect: Unknown

b. Builder: Unknown

*B10. Significance: Theme Cold War

Area United States

Period of Significance 1946-1989

Property Type Military

Applicable Criteria G

(Discuss importance in terms of historical or architectural context as defined by theme, period, and geographic scope. Also address integrity.)

This Cold War-era building is considered a support building, a type found at any Naval installation regardless of mission. It is therefore not of exceptional national significance and is not considered eligible for the National Register of Historic Places (Criterion G).

B11. Additional Resource Attributes: (List attributes and codes) _____

*B12. References:

Real Property Form

B13. Remarks:

*B14. Evaluator: Alexandra C. Cole

Date of Evaluation: 05/01/1998

(This space reserved for official comments.)

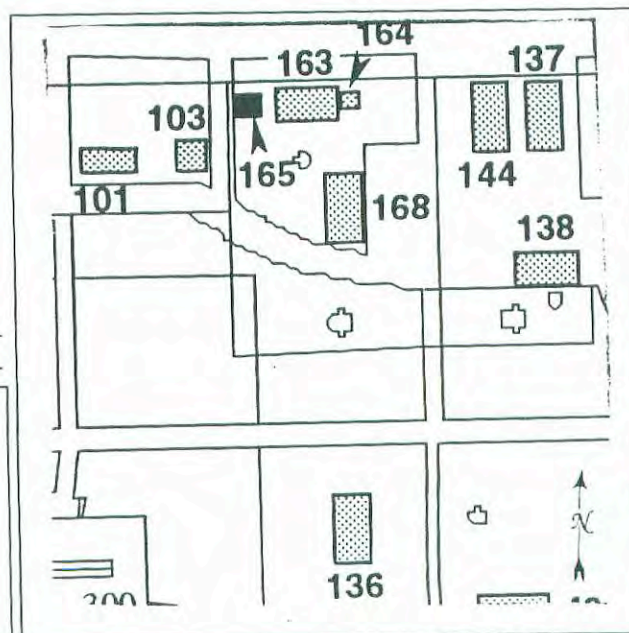

*Required information

PRIMARY RECORD

Primary # _____
HRI # _____
Trinomial _____
NRHP Status Code 6Z

Other Listings _____
Review Code _____ Reviewer _____ Date / /

Page 1 of 2

*Resource Name or #: 167, NASA Crows Landing

P1. Other Identifier: Medical Trailer

*P2. Location: Not for Publication Unrestricted a. County Stanislaus
b. USGS 7.5' Quad _____ Date _____ T _____; R _____; _____ 1/4 of _____ 1/4 of Sec _____; _____ B.M.
c. Address NASA C.L. Flight Facility City Crows Landing Zip 95313
d. UTM: (Give more than one for large and/or linear feature) Zone _____, _____ mE/ _____ mN
e. Other Locational Data: (e.g. parcel #, legal description, directions to resource, elevation, additional UTM's, etc. as appropriate)

*P3a. Description: (Describe resource and its major elements. Include design, materials, condition, alterations, size, setting, and boundaries.)
Building 167 is a pre-fabricated metal trailer with aluminum-framed windows and metal doors with glass upper panes.

*P3b. Resources Attributes: (List attributes and codes) HP34. Military Property

*P4. Resources Present: Building Structure Object Site District Element of District Other (Isolates, etc.)



P5b. Description of Photo: (View, date, etc.)
Northeast,
April 1998, Roll 5-22

*P6. Date Constructed/Age and Sources:
 Prehistoric Historic Both
Unknown

*P7. Owner and Address:
U.S.A. as represented by
National Aeronautics and Space
Administration, Washington, D.C

*P8. Recorded by: (Name, affiliation, address)
Alexandra C. Cole, SAIC
816 State Street, Suite 500
Santa Barbara, CA 93101

*P9. Date Recorded: 06/30/1998

*P10. Survey Type: (Describe)
Comprehensive Survey for Section
106 Compliance

*P11. Report Citation: (Cite survey report/other sources or "none") Inventory and Evaluation of Cold War Era Historical
Resources, NASA Crow Landing

*Attachments: NONE Location Map Sketch Map Continuation Sheet Building, Structure and Object Record
 Archaeological Record District Record Linear Feature Record Milling Station Record Rock Art Record Artifact Record
 Photograph Record Other: (List) _____

BUILDING, STRUCTURE, AND OBJECT RECORD

Page 2 of 2

*NRHP Status Code 6Z

*Resource Name or #: 167, NASA Crows Landing

B1. Historic Name: Unknown

B2. Common Name: Unknown

B3. Original Use: Medical Trailer

B4. Present Use: V--Vacant

*B5. Architectural Style: No Style

*B6. Construction History: (Construction date, alterations, and date of alterations.)

*B7. Moved? No Yes Unknown Date: _____ Original Location: _____

*B8. Related Features:

B9a. Architect: Unknown

b. Builder: Unknown

*B10. Significance: Theme Cold War

Area United States

Period of Significance 1946-1989

Property Type Military

Applicable Criteria G

(Discuss importance in terms of historical or architectural context as defined by theme, period, and geographic scope. Also address integrity.)

This Cold War-era building is considered a support building, a type found at any Naval installation regardless of mission. It is therefore not of exceptional national significance and is not considered eligible for the National Register of Historic Places (Criterion G).

B11. Additional Resource Attributes: (List attributes and codes) _____

*B12. References:

Real Property Form

B13. Remarks:

*B14. Evaluator: Alexandra C. Cole

Date of Evaluation: 05/01/1998

(This space reserved for official comments.)

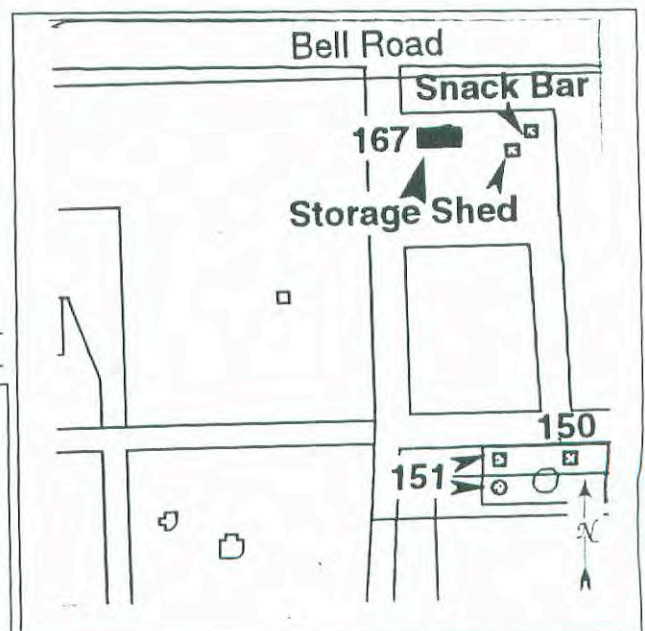

PRIMARY RECORD

Primary # _____
HRI # _____
Trinomial _____
NRHP Status Code 6Z

Other Listings _____
Review Code _____ Reviewer _____ Date / /

Page 1 of 2

*Resource Name or #: 168, NASA Crows Landing

P1. Other Identifier: Exchange

*P2. Location: Not for Publication Unrestricted a. County Stanislaus
b. USGS 7.5' Quad _____ Date _____ T _____; R _____; _____ 1/4 of _____ 1/4 of Sec _____; _____ B.M.
c. Address NASA C.L. Flight Facility City Crows Landing Zip 95313
d. UTM: (Give more than one for large and/or linear feature) Zone _____, _____ mE/ _____ mN
e. Other Locational Data: (e.g. parcel #, legal description, directions to resource, elevation, additional UTM, etc. as appropriate)

*P3a. Description: (Describe resource and its major elements. Include design, materials, condition, alterations, size, setting, and boundaries.)

Building 168 consists of two double-wide quonset huts linked by an entrance on the south side. A plywood shed addition extends to the north. The foundation and end walls are concrete block, and the rounded roof is corrugated metal. The main entrance on the south, with aluminum and glass windows, is protected by a wood canopy supported on a brick pier wall. The doors and windows are glass in aluminum frames. Brick sheathing has been applied to the west side.

*P3b. Resources Attributes: (List attributes and codes) HP34. Military Property

*P4. Resources Present: Building Structure Object Site District Element of District Other (Isolates, etc.)

P5b. Description of Photo: (View, date, etc.)
Southeast,

April 1998, Roll 5-36A

*P6. Date Constructed/Age and Sources:
 Prehistoric Historic Both
1943

*P7. Owner and Address:
U.S.A. as represented by
National Aeronautics and Space
Administration, Washington, D.C.

*P8. Recorded by: (Name, affiliation, address)
Alexandra C. Cole, SAIC
816 State Street, Suite 500
Santa Barbara, CA 93101

*P9. Date Recorded: 06/30/1998

*P10. Survey Type: (Describe)
Comprehensive Survey for Section
106 Compliance



*P11. Report Citation: (Cite survey report/other sources or "none") Inventory and Evaluation of Cold War Era Historical Resources, NASA Crows Landing

*Attachments: NONE Location Map Sketch Map Continuation Sheet Building, Structure and Object Record
 Archaeological Record District Record Linear Feature Record Milling Station Record Rock Art Record Artifact Record
 Photograph Record Other: (List) _____

BUILDING, STRUCTURE, AND OBJECT RECORD

Page 2 of 2

*NRHP Status Code 6Z

*Resource Name or #: 168, NASA Crows Landing

B1. Historic Name: "Crows Nest"

B2. Common Name: Unknown

B3. Original Use: Exchange, Club B4. Present Use: V--Vacant

*B5. Architectural Style: Quonset hut

*B6. Construction History: (Construction date, alterations, and date of alterations.)

1943

*B7. Moved? No Yes Unknown Date: _____ Original Location: _____

*B8. Related Features:

B9a. Architect: Unknown b. Builder: Unknown

*B10. Significance: Theme Cold War Area United States

Period of Significance 1946-1989 Property Type Military Applicable Criteria G

(Discuss importance in terms of historical or architectural context as defined by theme, period, and geographic scope. Also address integrity.)

This Cold War-era building is considered a support building, a type found at any Naval installation regardless of mission. It is therefore not of exceptional national significance and is not considered eligible for the National Register of Historic Places (Criterion G).

B11. Additional Resource Attributes: (List attributes and codes) _____

*B12. References:

Real Property Form

B13. Remarks:

*B14. Evaluator: Alexandra C. Cole

Date of Evaluation: 05/01/1998

(This space reserved for official comments.)

