

PRIMARY RECORD

Primary # _____
HRI # _____
Trinomial _____
NRHP Status Code 6Z

Other Listings _____
Review Code _____ Reviewer _____ Date / /

Page 1 of 2

*Resource Name or #: 572, Moffett Federal Airfield

P1. Other Identifier: Handball Courts

*P2. Location: Not for Publication Unrestricted a. County Santa Clara
b. USGS 7.5' Quad _____ Date _____ T _____; R _____; _____ 1/4 of _____ 1/4 of Sec _____; _____ B.M.
c. Address Girard Road City Moffett Field Zip 94035
d. UTM: (Give more than one for large and/or linear feature) Zone _____, _____ mE/ _____ mN
e. Other Locational Data: (e.g. parcel #, legal description, directions to resource, elevation, additional UTMs, etc. as appropriate)

*P3a. Description: (Describe resource and its major elements. Include design, materials, condition, alterations, size, setting, and boundaries.)
Building 572 is a high one-story building with stucco panel walls and a shallow-pitched gable roof. Two enclosed shed-roof porches of wood are located on the west side.

*P3b. Resources Attributes: (List attributes and codes) HP34. Military Property

*P4. Resources Present: Building Structure Object Site District Element of District Other (Isolates, etc.)

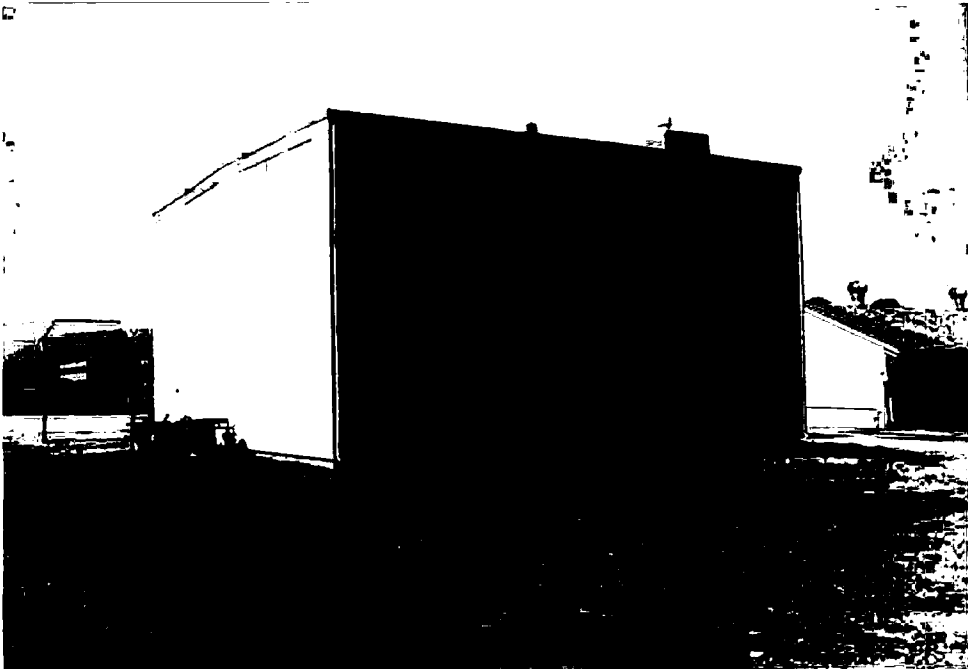

P5b. Description of Photo: (View, date, etc.)
Southwest.

June 1998, Roll 8-22, Ali Finley

*P6. Date Constructed/Age and Sources:
 Prehistoric Historic Both
1963

*P7. Owner and Address:
U.S.A. as represented by
National Aeronautics and Space
Administration, Washington, D.C.

*P8. Recorded by: (Name, affiliation, address)
Alexandra C. Cole, SAIC
816 State Street, Suite 500
Santa Barbara, CA 93101

*P9. Date Recorded: 06/29/1998

*P10. Survey Type: (Describe)
Comprehensive Survey for Section
106 Compliance

*P11. Report Citation: (Cite survey report/other sources or "none") Inventory and Evaluation of Cold War Era Historical
Resources, Moffett Field

*Attachments: NONE Location Map Sketch Map Continuation Sheet Building, Structure and Object Record
 Archaeological Record District Record Linear Feature Record Milling Station Record Rock Art Record Artifact Record
 Photograph Record Other: (List) _____

BUILDING, STRUCTURE, AND OBJECT RECORD

Page 2 of 2

*NRHP Status Code 6Z

*Resource Name or #: 572, Moffett Federal Airfield

B1. Historic Name: Unknown

B2. Common Name: Unknown

B3. Original Use: Handball Courts B4. Present Use: Handball Courts

*B5. Architectural Style: No Style

*B6. Construction History: (Construction date, alterations, and date of alterations.)
1963

*B7. Moved? No Yes Unknown Date: _____ Original Location: _____

*B8. Related Features: _____

B9a. Architect: Unknown b. Builder: Unknown

*B10. Significance: Theme Cold War Area United States

Period of Significance 1946-1989 Property Type Military Applicable Criteria G

(Discuss importance in terms of historical or architectural context as defined by theme, period, and geographic scope. Also address integrity.)

This Cold War-era building is considered a support building, a type found at any Naval installation regardless of mission. It is therefore not of exceptional national significance and is not considered eligible for the National Register of Historic Places (Criterion G).

B11. Additional Resource Attributes: (List attributes and codes) _____

*B12. References:
Real Property Form

B13. Remarks:

*B14. Evaluator: Alexandra C. Cole
Date of Evaluation: 05/01/1998

(This space reserved for official comments.)

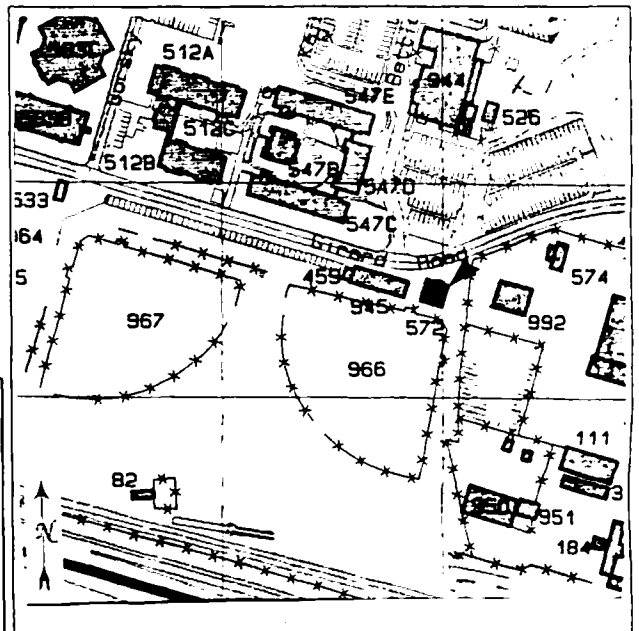

PRIMARY RECORD

Primary # _____
HRI # _____
Trinomial _____
NRHP Status Code 6Z

Other Listings _____
Review Code _____ Reviewer _____ Date / /

Page 1 of 2

*Resource Name or #: 574, Moffett Federal Airfield

P1. Other Identifier: Storage

*P2. Location: Not for Publication Unrestricted a. County Santa Clara
b. USGS 7.5' Quad _____ Date _____ T _____; R _____; _____ 1/4 of _____ 1/4 of Sec _____; _____ B.M.
c. Address Girard Road City Moffett Field Zip 94035
d. UTM: (Give more than one for large and/or linear feature) Zone _____, _____ mE/ _____ mN
e. Other Locational Data: (e.g. parcel #, legal description, directions to resource, elevation, additional UTM's, etc. as appropriate)

*P3a. Description: (Describe resource and its major elements. Include design, materials, condition, alterations, size, setting, and boundaries.)

Building 574 is a one-story pre-fabricated metal gable-roof building on a concrete slab foundation. Metal double doors provide access on the north and south sides.

*P3b. Resources Attributes: (List attributes and codes) HP34. Military Property

*P4. Resources Present: Building Structure Object Site District Element of District Other (Isolates, etc.)

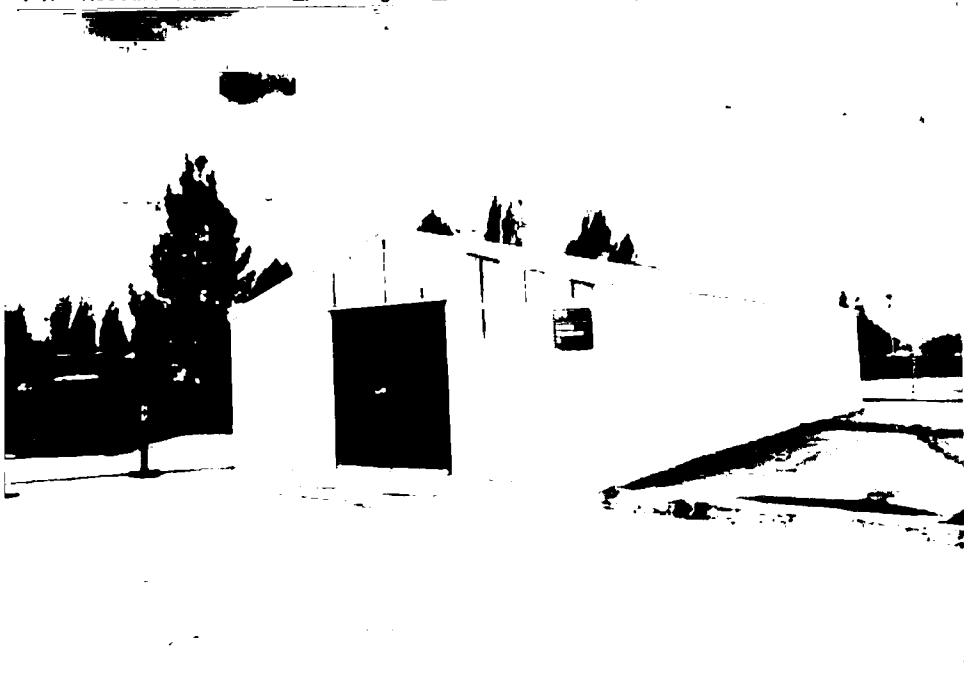

P5b. Description of Photo: (View, date, etc.)
North,

April 1998, Roll 5-10

*P6. Date Constructed/Age and Sources:
 Prehistoric Historic Both
1982

*P7. Owner and Address:
U.S.A. as represented by
National Aeronautics and Space
Administration, Washington, D.C.

*P8. Recorded by: (Name, affiliation, address)
Alexandra C. Cole, SAIC
816 State Street, Suite 500
Santa Barbara, CA 93101

*P9. Date Recorded: 06/29/1998

*P10. Survey Type: (Describe)
Comprehensive Survey for Section
106 Compliance

*P11. Report Citation: (Cite survey report/other sources or "none") Inventory and Evaluation of Cold War Era Historical Resources, Moffett Federal Airfield

*Attachments: NONE Location Map Sketch Map Continuation Sheet Building, Structure and Object Record
 Archaeological Record District Record Linear Feature Record Milling Station Record Rock Art Record Artifact Record
 Photograph Record Other: (List) _____

BUILDING, STRUCTURE, AND OBJECT RECORD

Page 2 of 2

*NRHP Status Code 6Z

*Resource Name or #: 574, Moffett Federal Airfield

B1. Historic Name: Unknown

B2. Common Name: Unknown

B3. Original Use: Oil, Tire storage

B4. Present Use: Mobility Storage B

*B5. Architectural Style: No Style

*B6. Construction History: (Construction date, alterations, and date of alterations.)

1982

*B7. Moved? No Yes Unknown Date: _____ Original Location: _____

*B8. Related Features:

B9a. Architect: Unknown

b. Builder: Unknown

*B10. Significance: Theme Cold War

Area United States

Period of Significance 1946-1989

Property Type Military

Applicable Criteria G

(Discuss importance in terms of historical or architectural context as defined by theme, period, and geographic scope. Also address integrity.)

This Cold War-era building is considered a support building, a type found at any Naval installation regardless of mission. It is therefore not of exceptional national significance and is not considered eligible for the National Register of Historic Places (Criterion G).

B11. Additional Resource Attributes: (List attributes and codes) _____

*B12. References:

Real Property Form

B13. Remarks:

*B14. Evaluator: Alexandra C. Cole

Date of Evaluation: 05/01/1998

(This space reserved for official comments.)

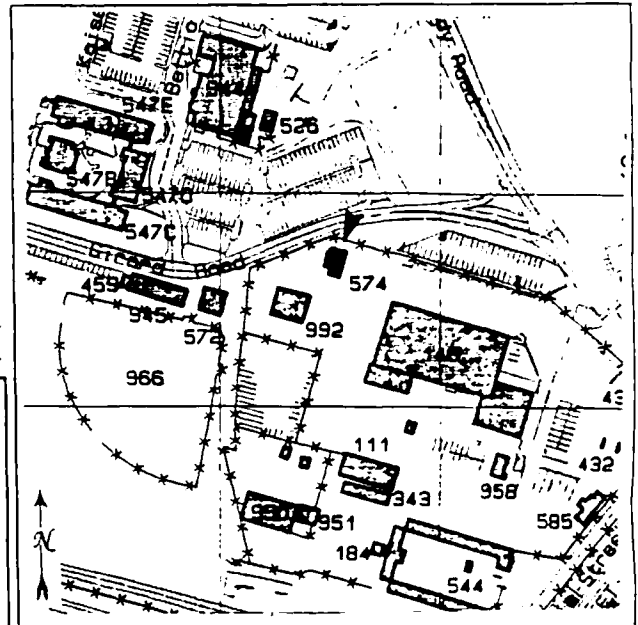

PRIMARY RECORD

Primary # _____
HRI # _____
Trinomial _____
NRHP Status Code 6Z

Other Listings _____
Review Code _____ Reviewer _____ Date / /

Page 1 of 2

*Resource Name or #: 580, Moffett Federal Airfield

P1. Other Identifier: Fire Station

*P2. Location: Not for Publication Unrestricted a. County Santa Clara

b. USGS 7.5' Quad _____ Date _____ T _____; R _____; _____ 1/4 of _____ 1/4 of Sec _____; _____ B.M.

c. Address Zook Road City Moffett Field Zip 94035

d. UTM: (Give more than one for large and/or linear feature) Zone _____ mE/ _____ mN

e. Other Locational Data: (e.g. parcel #, legal description, directions to resource, elevation, additional UTM's, etc. as appropriate)

*P3a. Description: (Describe resource and its major elements. Include design, materials, condition, alterations, size, setting, and boundaries.)

This rectangular flat-roofed fire station has two high one-story ribbed metal bays for trucks and two lower one-story wings for administrative duties. The walls of the administrative wing are clad in pink glazed tile and topped by a ribbed metal fascia. A dispatch tower with tinted windows extends from the southeast corner.

*P3b. Resources Attributes: (List attributes and codes) HP34, Military Property

*P4. Resources Present: Building Structure Object Site District Element of District Other (Isolates, etc.)

P5b. Description of Photo: (View, date, etc.)

Northeast,

April 1998, Roll 4-13

*P6. Date Constructed/Age and Sources:

Prehistoric Historic Both

1983

*P7. Owner and Address:

U.S.A. as represented by

National Aeronautics and Space

Administration, Washington, D.C.

*P8. Recorded by: (Name, affiliation, address)

Alexandra C. Cole, SAIC

816 State Street, Suite 500

Santa Barbara, CA 93101

*P9. Date Recorded: 06/29/1998

*P10. Survey Type: (Describe)

Comprehensive Survey for Section

106 Compliance

*P11. Report Citation: (Cite survey report/other sources or "none") Inventory and Evaluation of Cold War Era Historical

Resources, Moffett Federal Airfield

*Attachments: NONE Location Map Sketch Map Continuation Sheet Building, Structure and Object Record

Archaeological Record District Record Linear Feature Record Milling Station Record Rock Art Record Artifact Record

Photograph Record Other: (List) _____

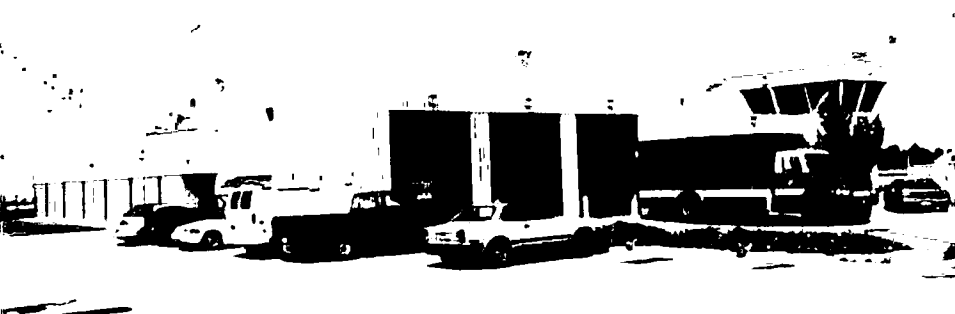

BUILDING, STRUCTURE, AND OBJECT RECORD

Page 2 of 2

*NRHP Status Code 6Z

*Resource Name or #: 580, Moffett Federal Airfield

B1. Historic Name: Unknown

B2. Common Name: Unknown

B3. Original Use: Fire Station B4. Present Use: Fire/Air Crash Rescue Station

*B5. Architectural Style: No Style

*B6. Construction History: (Construction date, alterations, and date of alterations.)
1983

*B7. Moved? No Yes Unknown Date: _____ Original Location: _____

*B8. Related Features:

B9a. Architect: Unknown b. Builder: Unknown

*B10. Significance: Theme Cold War Area United States

Period of Significance 1946-1989 Property Type Military Applicable Criteria G

(Discuss importance in terms of historical or architectural context as defined by theme, period, and geographic scope. Also address integrity.)

This Cold War-era building is considered a support building, a type found at any Naval installation regardless of mission. It is therefore not of exceptional national significance and is not considered eligible for the National Register of Historic Places (Criterion G).

B11. Additional Resource Attributes: (List attributes and codes) _____

*B12. References:
Real Property Form

B13. Remarks:

*B14. Evaluator: Alexandra C. Cole

Date of Evaluation: 05/01/1998

(This space reserved for official comments.)

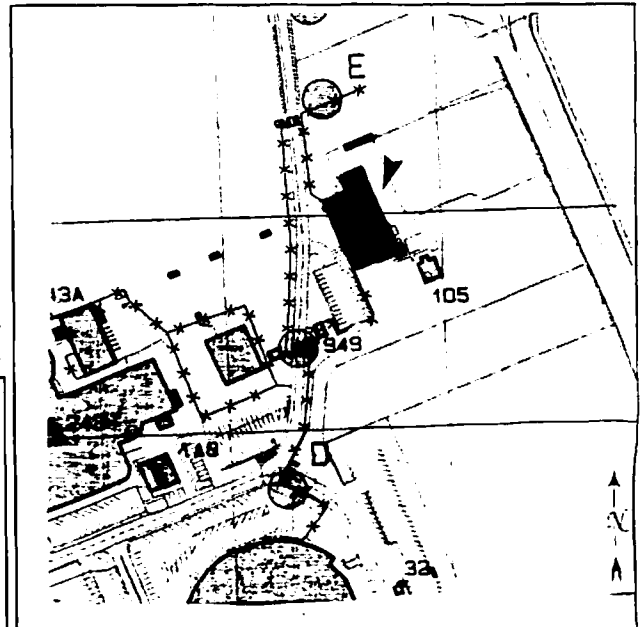

PRIMARY RECORD

Primary # _____
HRI # _____
Trinomial _____
NRHP Status Code 6Z

Other Listings _____
Review Code _____ Reviewer _____ Date / /

Page 1 of 2

*Resource Name or #: 581, Moffett Federal Airfield

P1. Other Identifier: Sign Board

*P2. Location: Not for Publication Unrestricted a. County Santa Clara
b. USGS 7.5' Quad _____ Date _____ T _____; R _____; _____ 1/4 of _____ 1/4 of Sec _____; _____ B.M.
c. Address North Akron Road City Moffett Field Zip 94035
d. UTM: (Give more than one for large and/or linear feature) Zone _____, _____ mE/ _____ mN
e. Other Locational Data: (e.g. parcel #, legal description, directions to resource, elevation, additional UTM's, etc. as appropriate)

*P3a. Description: (Describe resource and its major elements. Include design, materials, condition, alterations, size, setting, and boundaries.)

This sign board consists of three large square wooden posts, set into a concrete pad, that are topped by a red-tile hipped roof. A plastic and metal sign board attached to the posts is used to announce coming events.

*P3b. Resources Attributes: (List attributes and codes) HP34. Military Property

*P4. Resources Present: Building Structure Object Site District Element of District Other (Isolates, etc.)



P5b. Description of Photo: (View, date, etc.)
North,

April 1998, Roll 4-14

*P6. Date Constructed/Age and Sources:
 Prehistoric Historic Both
1982

*P7. Owner and Address:
U.S.A. as represented by
National Aeronautics and Space
Administration, Washington, D.C.

*P8. Recorded by: (Name, affiliation, address)
Alexandra C. Cole, SAIC
816 State Street, Suite 500
Santa Barbara, CA 93101

*P9. Date Recorded: 06/29/1998

*P10. Survey Type: (Describe)
Comprehensive Survey for Section
106 Compliance

*P11. Report Citation: (Cite survey report/other sources or "none") Inventory and Evaluation of Cold War Era Historical Resources, Moffett Federal Airfield

*Attachments: NONE Location Map Sketch Map Continuation Sheet Building, Structure and Object Record
 Archaeological Record District Record Linear Feature Record Milling Station Record Rock Art Record Artifact Record
 Photograph Record Other: (List) _____

BUILDING, STRUCTURE, AND OBJECT RECORD

Page 2 of 2

*NRHP Status Code 6Z

*Resource Name or #: 581, Moffett Federal Airfield

B1. Historic Name: Unknown

B2. Common Name: Unknown

B3. Original Use: Theater Marquee

B4. Present Use: Sign Board

*B5. Architectural Style: No Style

*B6. Construction History: (Construction date, alterations, and date of alterations.)

1982

*B7. Moved? No Yes Unknown Date: _____ Original Location: _____

*B8. Related Features:

B9a. Architect: Unknown

b. Builder: Unknown

*B10. Significance: Theme Cold War

Area United States

Period of Significance 1946-1989

Property Type Military

Applicable Criteria G

(Discuss importance in terms of historical or architectural context as defined by theme, period, and geographic scope. Also address integrity.)

This Cold War-era building is considered a support building, a type found at any Naval installation regardless of mission. It is therefore not of exceptional national significance and is not considered eligible for the National Register of Historic Places (Criterion G).

B11. Additional Resource Attributes: (List attributes and codes) _____

*B12. References:

Real Property Form

B13. Remarks:

*B14. Evaluator: Alexandra C. Cole

Date of Evaluation: 05/01/1998

(This space reserved for official comments.)

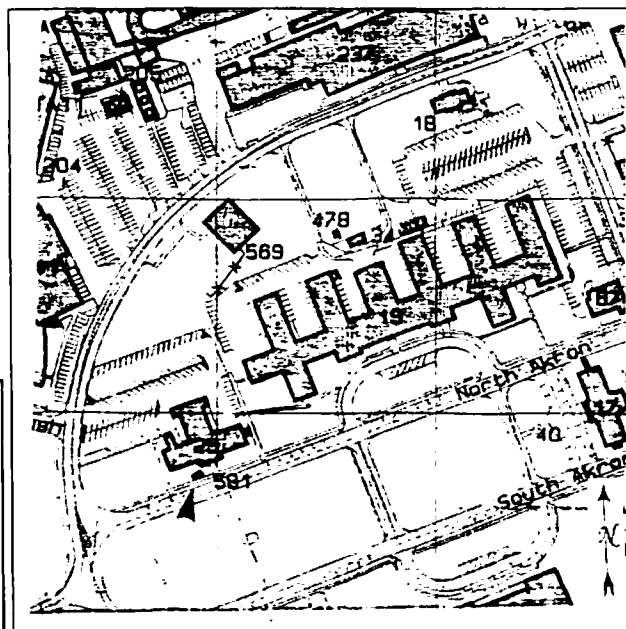

PRIMARY RECORD

Primary # _____
HRI # _____
Trinomial _____
NRHP Status Code 6Z

Other Listings _____
Review Code _____ Reviewer _____ Date / /

Page 1 of 2

*Resource Name or #: 582, Moffett Federal Airfield

P1. Other Identifier: Sign Board

*P2. Location: Not for Publication Unrestricted a. County Santa Clara
b. USGS 7.5' Quad _____ Date _____ T _____; R _____; _____ 1/4 of _____ 1/4 of Sec _____; _____ B.M.
c. Address South Macon Road City Moffett Field Zip 94035
d. UTM: (Give more than one for large and/or linear feature) Zone _____, _____ mE/ _____ mN
e. Other Locational Data: (e.g. parcel #, legal description, directions to resource, elevation, additional UTM's, etc. as appropriate)

*P3a. Description: (Describe resource and its major elements. Include design, materials, condition, alterations, size, setting, and boundaries.)

This sign board consists of three large square wooden posts, set into a concrete pad, that are topped by a red-tile hipped roof. A plastic and metal sign board attached to the posts is used to announce coming events.

*P3b. Resources Attributes: (List attributes and codes) HP34. Military Property

*P4. Resources Present: Building Structure Object Site District Element of District Other (Isolates, etc.)



P5b. Description of Photo: (View, date, etc.)
East,

April 1998, Roll 4-19

*P6. Date Constructed/Age and Sources:
 Prehistoric Historic Both
1982

*P7. Owner and Address:
U.S.A. as represented by
National Aeronautics and Space
Administration, Washington, D.C.

*P8. Recorded by: (Name, affiliation, address)
Alexandra C. Cole, SAIC
816 State Street, Suite 500
Santa Barbara, CA 93101

*P9. Date Recorded: 06/29/1998

*P10. Survey Type: (Describe)
Comprehensive Survey for Section
106 Compliance

*P11. Report Citation: (Cite survey report/other sources or "none") Inventory and Evaluation of Cold War Era Historical Resources, Moffett Federal Airfield

*Attachments: NONE Location Map Sketch Map Continuation Sheet Building, Structure and Object Record
 Archaeological Record District Record Linear Feature Record Milling Station Record Rock Art Record Artifact Record
 Photograph Record Other: (List) _____

BUILDING, STRUCTURE, AND OBJECT RECORD

Page 2 of 2

*NRHP Status Code 6Z

*Resource Name or #: 582, Moffett Federal Airfield

B1. Historic Name: Unknown

B2. Common Name: Unknown

B3. Original Use: Sign Board

B4. Present Use: Ellis Gate Entry Sign

*B5. Architectural Style: No Style

*B6. Construction History: (Construction date, alterations, and date of alterations.)

1982

*B7. Moved? No Yes Unknown Date: _____ Original Location: _____

*B8. Related Features:

B9a. Architect: Unknown

b. Builder: Unknown

*B10. Significance: Theme Cold War

Area United States

Period of Significance 1946-1989

Property Type Military

Applicable Criteria G

(Discuss importance in terms of historical or architectural context as defined by theme, period, and geographic scope. Also address integrity.)

This Cold War-era building is considered a support building, a type found at any Naval installation regardless of mission. It is therefore not of exceptional national significance and is not considered eligible for the National Register of Historic Places (Criterion G).

B11. Additional Resource Attributes: (List attributes and codes) _____

*B12. References:

Real Property Form

B13. Remarks:

*B14. Evaluator: Alexandra C. Cole

Date of Evaluation: 05/01/1998

(This space reserved for official comments.)

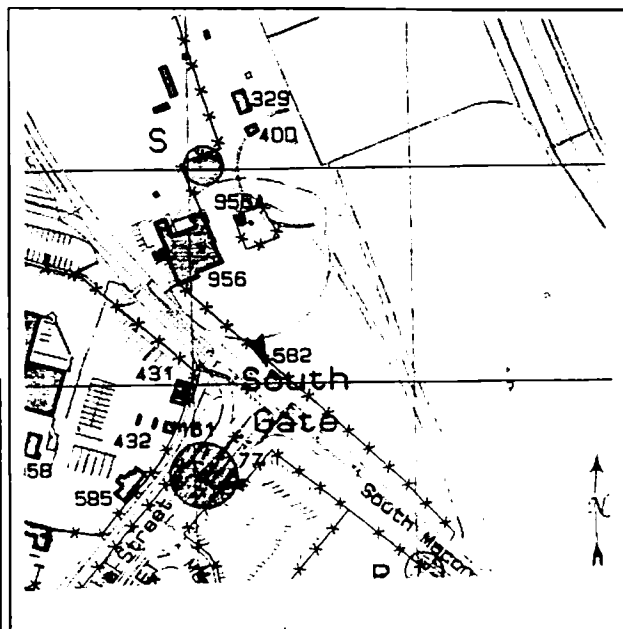

PRIMARY RECORD

Primary # _____
HRI # _____
Trinomial _____
NRHP Status Code 6Z

Other Listings _____
Review Code _____ Reviewer _____ Date / /

Page 1 of 2

*Resource Name or #: 583 A, B, C, Moffett Federal Airfield

P1. Other Identifier: Living Quarters

*P2. Location: Not for Publication Unrestricted a. County Santa Clara

b. USGS 7.5' Quad _____ Date _____ T _____; R _____; _____ 1/4 of _____ 1/4 of Sec _____; _____ B.M.

c. Address Gorsky Road City Moffett Field Zip 94035

d. UTM: (Give more than one for large and/or linear feature) Zone _____, _____ mE/ _____ mN

e. Other Locational Data: (e.g. parcel #, legal description, directions to resource, elevation, additional UTM's, etc. as appropriate)

*P3a. Description: (Describe resource and its major elements. Include design, materials, condition, alterations, size, setting, and boundaries.)

Buildings 583 A, B, and C, consist of two three-story flat-roof concrete block dormitories arranged in an L-shape, with a one-story concrete block lounge located at the center of the L. Door and window units, which combine maroon doors, transom panels and ribbed panels below sliding windows in anodized aluminum frames, enliven the otherwise plain facades. Concrete stair and storage towers are located at the ends and along the sides of the dormitories.

*P3b. Resources Attributes: (List attributes and codes) HP34, Military Property

*P4. Resources Present: Building Structure Object Site District Element of District Other (Isolates, etc.)

P5b. Description of Photo: (View, date, etc.)

583 B Northwest,

April 1998, Roll 5-2

*P6. Date Constructed/Age and Sources:

Prehistoric Historic Both

1985

*P7. Owner and Address:

U.S.A. as represented by

National Aeronautics and Space

Administration, Washington, D.C.

*P8. Recorded by: (Name, affiliation, address)

Alexandra C. Cole, SAIC

816 State Street, Suite 500

Santa Barbara, CA 93101

*P9. Date Recorded: 06/29/1998

*P10. Survey Type: (Describe)

Comprehensive Survey for Section

106 Compliance



*P11. Report Citation: (Cite survey report/other sources or "none") Inventory and Evaluation of Cold War Era Historical Resources, Moffett Federal Airfield

*Attachments: NONE Location Map Sketch Map Continuation Sheet Building, Structure and Object Record

Archaeological Record District Record Linear Feature Record Milling Station Record Rock Art Record Artifact Record

Photograph Record Other: (List) _____

BUILDING, STRUCTURE, AND OBJECT RECORD

Page 2 of 2

*NRHP Status Code 6Z

*Resource Name or #: 583 A, B, C, Moffett Federal Airfield

B1. Historic Name: Unknown

B2. Common Name: Unknown

B3. Original Use: Living Quarters B4. Present Use: Living Quarters

*B5. Architectural Style: No Style

*B6. Construction History: (Construction date, alterations, and date of alterations.)
1985

*B7. Moved? No Yes Unknown Date: _____ Original Location: _____

*B8. Related Features:

B9a. Architect: Unknown b. Builder: Unknown

*B10. Significance: Theme Cold War Area United States

Period of Significance 1946-1989 Property Type Military Applicable Criteria G

(Discuss importance in terms of historical or architectural context as defined by theme, period, and geographic scope. Also address integrity.)

This Cold War-era building is considered a support building, a type found at any Naval installation regardless of mission. It is therefore not of exceptional national significance and is not considered eligible for the National Register of Historic Places (Criterion G).

B11. Additional Resource Attributes: (List attributes and codes) _____

*B12. References:
Real Property Form

B13. Remarks:

*B14. Evaluator: Alexandra C. Cole

Date of Evaluation: 05/01/1998

(This space reserved for official comments.)

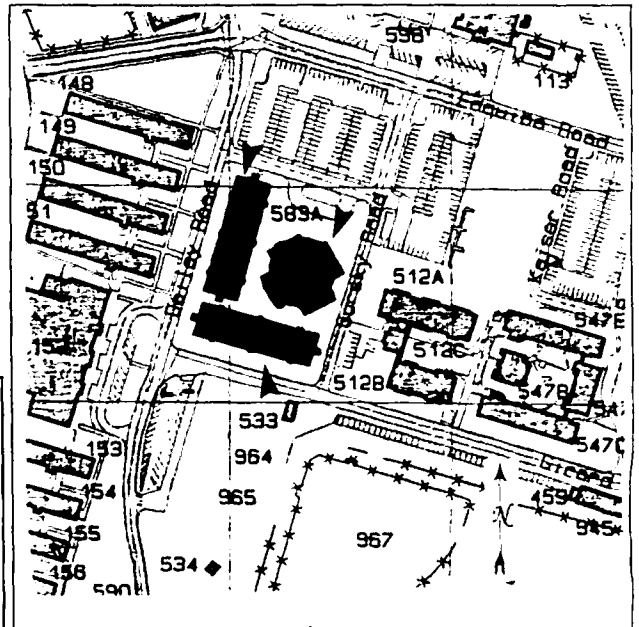

PRIMARY RECORD

Primary # _____
HRI # _____
Trinomial _____
NRHP Status Code 6Z

Other Listings _____
Review Code _____ Reviewer _____ Date / /

Page 1 of 2

*Resource Name or #: 591, Moffett Federal Airfield

P1. Other Identifier: Substation

*P2. Location: Not for Publication Unrestricted a. County Santa Clara
b. USGS 7.5' Quad _____ Date _____ T _____; R _____; _____ 1/4 of _____ 1/4 of Sec _____; _____ B.M.
c. Address Macon Road City Moffett Field Zip 94035
d. UTM: (Give more than one for large and/or linear feature) Zone _____, _____ mE/ _____ mN
e. Other Locational Data: (e.g. parcel #, legal description, directions to resource, elevation, additional UTM's, etc. as appropriate)

*P3a. Description: (Describe resource and its major elements. Include design, materials, condition, alterations, size, setting, and boundaries.)
Building 591 is an electric sub-station on a 110'x 180' concrete pad. It is the main station for Moffett Field.

*P3b. Resources Attributes: (List attributes and codes) HP34, Military Property

*P4. Resources Present: Building Structure Object Site District Element of District Other (Isolates, etc.)

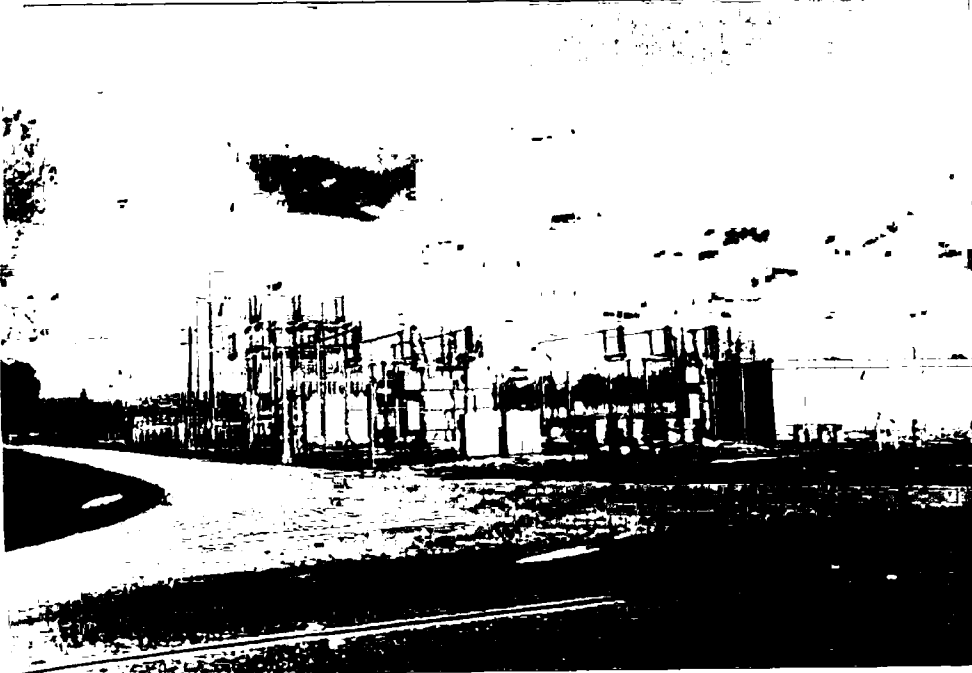

P5b. Description of Photo: (View, date, etc.)
Southeast,

April 1998, Roll 3-22A

*P6. Date Constructed/Age and Sources:
 Prehistoric Historic Both
1983

*P7. Owner and Address:
 U.S.A. as represented by
National Aeronautics and Space Administration, Washington, D.C.

*P8. Recorded by: (Name, affiliation, address)
Alexandra C. Cole, SAIC
816 State Street, Suite 500
Santa Barbara, CA 93101

*P9. Date Recorded: 06/18/1998

*P10. Survey Type: (Describe)
Comprehensive Survey for Section 106 Compliance

*P11. Report Citation: (Cite survey report/other sources or "none") Inventory and Evaluation of Cold War Era Historical Resources, Moffett Federal Airfield

*Attachments: NONE Location Map Sketch Map Continuation Sheet Building, Structure and Object Record
 Archaeological Record District Record Linear Feature Record Milling Station Record Rock Art Record Artifact Record
 Photograph Record Other: (List) _____

BUILDING, STRUCTURE, AND OBJECT RECORD

Page 2 of 2

*NRHP Status Code 6Z

*Resource Name or #: 591, Moffett Federal Airfield

B1. Historic Name: Unknown

B2. Common Name: Unknown

B3. Original Use: Electric Substation

B4. Present Use: Electric Substation

*B5. Architectural Style: No Style

*B6. Construction History: (Construction date, alterations, and date of alterations.)

1983

*B7. Moved? No Yes Unknown Date: _____ Original Location: _____

*B8. Related Features:

B9a. Architect: Unknown

b. Builder: Unknown

*B10. Significance: Theme Cold War

Area United States

Period of Significance 1946-1989

Property Type Military

Applicable Criteria G

(Discuss importance in terms of historical or architectural context as defined by theme, period, and geographic scope. Also address integrity.)

This Cold War-era building is considered a support building, a type found at any Naval installation regardless of mission. It is therefore not of exceptional national significance and is not considered eligible for the National Register of Historical Resources (Criterion G).

B11. Additional Resource Attributes: (List attributes and codes) _____

*B12. References:

Real Property Form

B13. Remarks:

*B14. Evaluator: Alexandra C. Cole

Date of Evaluation: 05/01/1998

(This space reserved for official comments.)

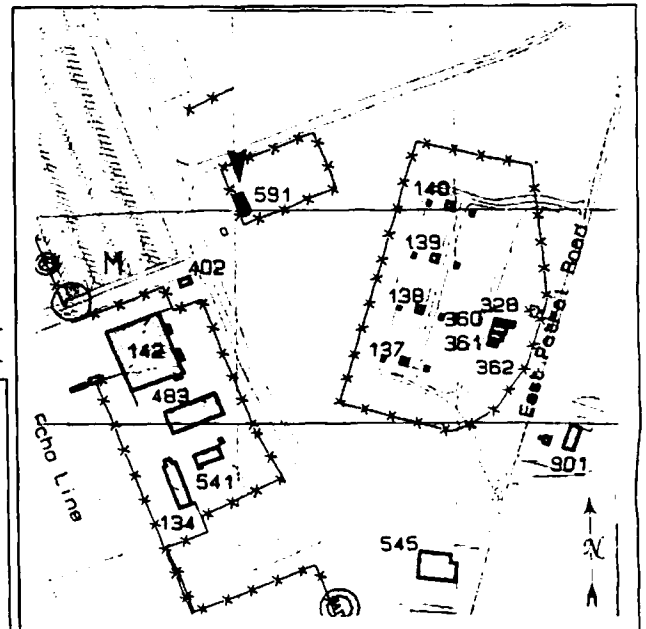

PRIMARY RECORD

Primary # _____
HRI # _____
Trinomial _____
NRHP Status Code 6Z

Other Listings _____
Review Code _____ Reviewer _____ Date / /

Page 1 of 2

*Resource Name or #: 596, Moffett Federal Airfield

P1. Other Identifier: McDonalds

*P2. Location: Not for Publication Unrestricted a. County Santa Clara
b. USGS 7.5' Quad _____ Date _____ T _____; R _____; 1/4 of _____ 1/4 of Sec _____; B.M. _____
c. Address Edquiba Road City Moffett Field Zip 94035
d. UTM: (Give more than one for large and/or linear feature) Zone _____ mE/ _____ mN
e. Other Locational Data: (e.g. parcel #, legal description, directions to resource, elevation, additional UTM, etc. as appropriate)

*P3a. Description: (Describe resource and its major elements. Include design, materials, condition, alterations, size, setting, and boundaries.)
Building 596 is a one-story restaurant with glass and stucco walls and a mid-sprung mansard roof with widely overhanging eaves.

*P3b. Resources Attributes: (List attributes and codes) HP34. Military Property

*P4. Resources Present: Building Structure Object Site District Element of District Other (Isolates, etc.)



P5b. Description of Photo: (View, date, etc.)
Northeast,

June 1998, Roll 8-12, Ali Finley

*P6. Date Constructed/Age and Sources:
 Prehistoric Historic Both
1985

*P7. Owner and Address:
U.S.A. as represented by
National Aeronautics and Space
Administration, Washington, D.C.

*P8. Recorded by: (Name, affiliation, address)
Alexandra C. Cole, SAIC
816 State Street, Suite 500
Santa Barbara, CA 93101

*P9. Date Recorded: 06/25/1998

*P10. Survey Type: (Describe)
Comprehensive Survey for Section
106 Compliance

*P11. Report Citation: (Cite survey report/other sources or "none") Inventory and Evaluation of Cold War Era Historical Resources, Moffett Field

*Attachments: NONE Location Map Sketch Map Continuation Sheet Building, Structure and Object Record
 Archaeological Record District Record Linear Feature Record Milling Station Record Rock Art Record Artifact Record
 Photograph Record Other: (List) _____

BUILDING, STRUCTURE, AND OBJECT RECORD

Page 2 of 2

*NRHP Status Code 6Z

*Resource Name or #: 596, Moffett Federal Airfield

B1. Historic Name: Unknown

B2. Common Name: Unknown

B3. Original Use: McDonalds

B4. Present Use: McDonalds

*B5. Architectural Style: No Style

*B6. Construction History: (Construction date, alterations, and date of alterations.)

1985

*B7. Moved? No Yes Unknown Date: _____ Original Location: _____

*B8. Related Features:

B9a. Architect: Unknown

b. Builder: Unknown

*B10. Significance: Theme Cold War

Area United States

Period of Significance 1946-1989

Property Type Military

Applicable Criteria G

(Discuss importance in terms of historical or architectural context as defined by theme, period, and geographic scope. Also address integrity.)

This Cold War-era building is considered a support building, a type found at any Naval installation regardless of mission. It is therefore not of exceptional national significance and is not considered eligible for the National Register of Historic Places (Criterion G).

B11. Additional Resource Attributes: (List attributes and codes) _____

*B12. References:

Real Property Form

B13. Remarks:

*B14. Evaluator: Alexandra C. Cole

Date of Evaluation: 05/01/1998

(This space reserved for official comments.)

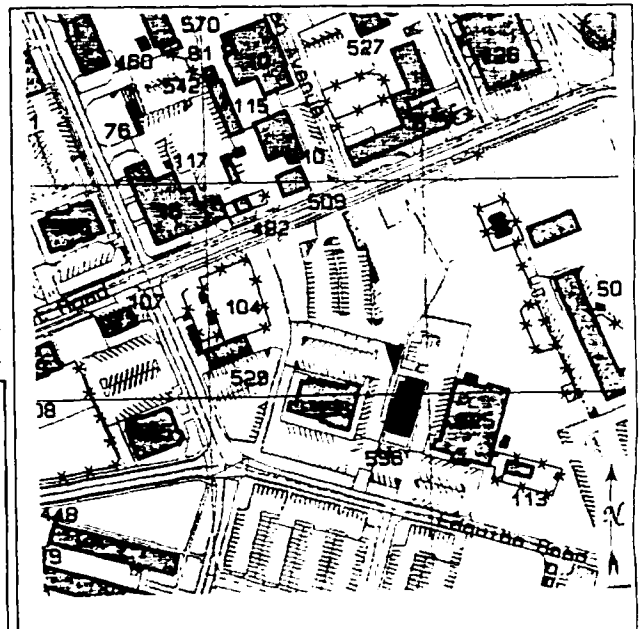

PRIMARY RECORD

Primary # _____
HRI # _____
Trinomial _____
NRHP Status Code 6Z
Other Listings _____
Review Code _____ Reviewer _____ Date 1/1

Page 1 of 2

*Resource Name or #: 650, Moffett Federal Airfield

P1. Other Identifier: General Purpose Shops

*P2. Location: Not for Publication Unrestricted a. County Santa Clara

b. USGS 7.5' Quad _____ Date _____ T _____; R _____; 1/4 of _____ 1/4 of Sec _____; B.M. _____

c. Address Jagels Road City Moffett Field Zip 94035

d. UTM: (Give more than one for large and/or linear feature) Zone _____, _____ mE/ _____ mN

e. Other Locational Data: (e.g. parcel #, legal description, directions to resource, elevation, additional UTM's, etc. as appropriate)

*P3a. Description: (Describe resource and its major elements. Include design, materials, condition, alterations, size, setting, and boundaries.)

Building 650 is a rectangular one-story flat-roofed building on a concrete foundation. The fluted concrete slab walls are topped by porcelain enamel fascia panels. An entrance wing with reflective glass walls and porcelain enamel fascia panels extends to the north. Metal single or double doors provide access on the north, west, and south sides.

*P3b. Resources Attributes: (List attributes and codes) HP34, Military Property

*P4. Resources Present: Building Structure Object Site District Element of District Other (Isolates, etc.)

P5b. Description of Photo: (View, date, etc.)

Southeast,

April 1998, Roll 1-30

*P6. Date Constructed/Age and Sources:

Prehistoric Historic Both

1975

*P7. Owner and Address:

U.S.A. as represented by

National Aeronautics and Space

Administration, Washington, D.C.

*P8. Recorded by: (Name, affiliation, address)

Alexandra C. Cole, SAIC

816 State Street, Suite 500

Santa Barbara, CA 93101

*P9. Date Recorded: 06/19/1998

*P10. Survey Type: (Describe)

Comprehensive Survey for Section

106 Compliance

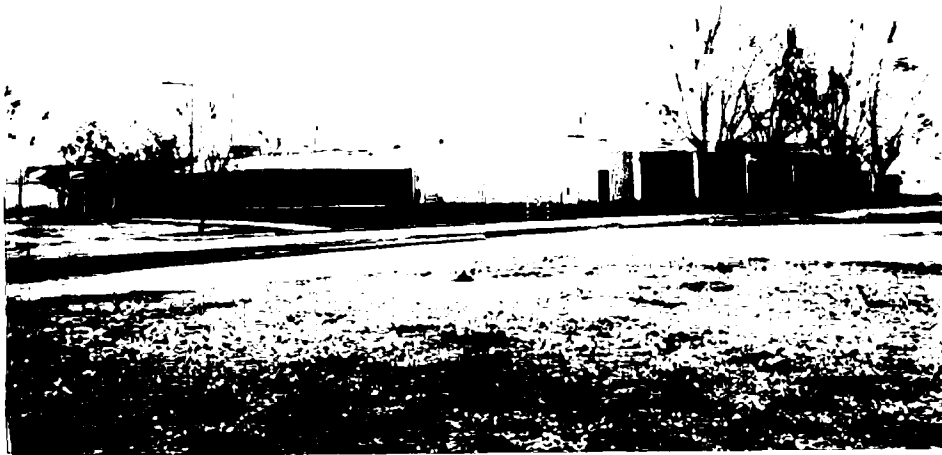

*P11. Report Citation: (Cite survey report/other sources or "none") Inventory and Evaluation of Cold War Era Historical

Resources, Moffett Federal Airfield

*Attachments: NONE Location Map Sketch Map Continuation Sheet Building, Structure and Object Record

Archaeological Record District Record Linear Feature Record Milling Station Record Rock Art Record Artifact Record

Photograph Record Other: (List) _____

BUILDING, STRUCTURE, AND OBJECT RECORD

Page 2 of 2

*NRHP Status Code 6Z

*Resource Name or #: 650, Moffett Federal Airfield

B1. Historic Name: Building 549

B2. Common Name: Unknown

B3. Original Use: AIMD Avionics Shop

B4. Present Use: CANG General Purpose Shops

*B5. Architectural Style: No Style

*B6. Construction History: (Construction date, alterations, and date of alterations.)

Built in 1975, it was altered in 1994 by David Takamoto Associates, San Jose

*B7. Moved? No Yes Unknown Date: _____ Original Location: _____

*B8. Related Features:

B9a. Architect: Braccia, DeBrer, Heglund, S.F.

b. Builder: Unknown

*B10. Significance: Theme Cold War Area United States

Period of Significance 1946-1989 Property Type Military Applicable Criteria G

(Discuss importance in terms of historical or architectural context as defined by theme, period, and geographic scope. Also address integrity.)

Building 650 housed the avionics shop and electronics repair and maintenance shop for the avionics component boxes found on the P-3 Orion. This building was directly associated with the Cold War P-3 Orion anti-submarine warfare patrol mission dating from 1963 to 1994. Although this mission is considered of exceptional national significance within the Cold War context, this building is of standard construction and does not exhibit unique architectural or engineering features special to the P-3 mission. It is therefore not considered of exceptional significance under criterion G.

B11. Additional Resource Attributes: (List attributes and codes) _____

*B12. References:

C.E. Archives, Building 683

B13. Remarks:

*B14. Evaluator: Alexandra C. Cole

Date of Evaluation: 05/01/1998

(This space reserved for official comments.)

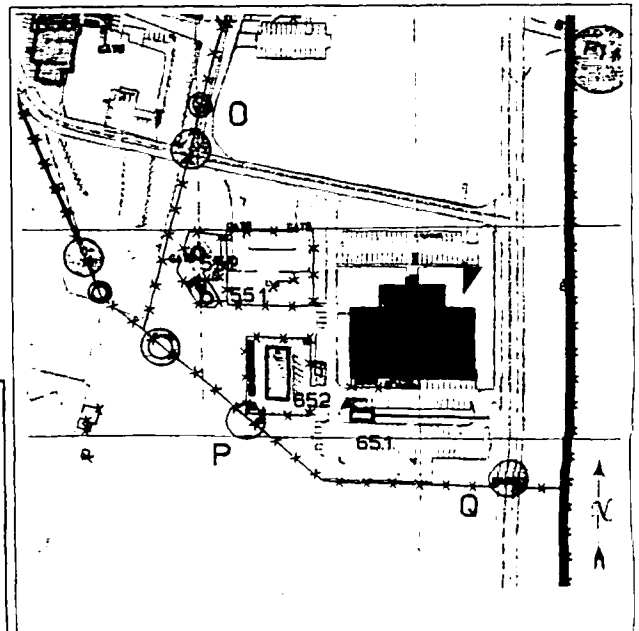

PRIMARY RECORD

Primary # _____
HRI # _____
Trinomial _____
NRHP Status Code 6Z

Other Listings _____
Review Code _____ Reviewer _____ Date / /

Page 1 of 2

*Resource Name or #: 651, Moffett Federal Airfield

P1. Other Identifier: Battery Lockers

*P2. Location: Not for Publication Unrestricted a. County Santa Clara
b. USGS 7.5' Quad _____ Date _____ T _____; R _____; 1/4 of _____ 1/4 of Sec _____; B.M. _____
c. Address Jagels Road City Moffett Field Zip 94035
d. UTM: (Give more than one for large and/or linear feature) Zone _____, _____ mE/ _____ mN
e. Other Locational Data: (e.g. parcel #, legal description, directions to resource, elevation, additional UTM's, etc. as appropriate)

*P3a. Description: (Describe resource and its major elements. Include design, materials, condition, alterations, size, setting, and boundaries.)

Building 651 is a rectangular one-story flat-roofed building constructed of concrete block with a ribbed sheet metal fascia. Metal double doors provide access on the east side.

*P3b. Resources Attributes: (List attributes and codes) HP34, Military Property

*P4. Resources Present: Building Structure Object Site District Element of District Other (Isolates, etc.)

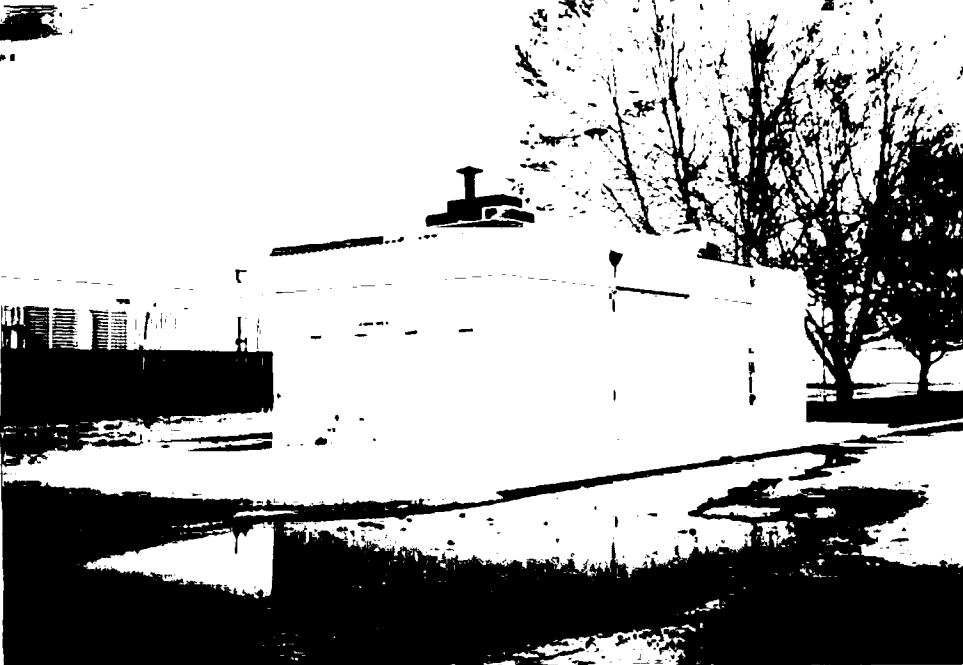

P5b. Description of Photo: (View, date, etc.)
Northeast,

April 1998, Roll 1-4

*P6. Date Constructed/Age and Sources:
 Prehistoric Historic Both
1981

*P7. Owner and Address:
U.S.A. as represented by
National Aeronautics and Space
Administration, Washington, D.C.

*P8. Recorded by: (Name, affiliation, address)
Alexandra C. Cole, SAIC
816 State Street, Suite 500
Santa Barbara, CA 93101

*P9. Date Recorded: 06/29/1998

*P10. Survey Type: (Describe)
Comprehensive Survey for Section
106 Compliance

*P11. Report Citation: (Cite survey report/other sources or "none") Inventory and Evaluation of Cold War Era Historical
Resources, Moffett Federal Airfield

*Attachments: NONE Location Map Sketch Map Continuation Sheet Building, Structure and Object Record
 Archaeological Record District Record Linear Feature Record Milling Station Record Rock Art Record Artifact Record
 Photograph Record Other: (List) _____

BUILDING, STRUCTURE, AND OBJECT RECORD

Page 2 of 2

*NRHP Status Code 6Z

*Resource Name or #: 651, Moffett Federal Airfield

B1. Historic Name: Building 575

B2. Common Name: Unknown

B3. Original Use: AIMD Battery Lockers

B4. Present Use: CANG Battery Shop

*B5. Architectural Style: No Style

*B6. Construction History: (Construction date, alterations, and date of alterations.)

1981

*B7. Moved? No Yes Unknown Date: _____ Original Location: _____

*B8. Related Features:

B9a. Architect: Bissell & Karn, Milpitas b. Builder: Unknown

*B10. Significance: Theme Cold War Area United States

Period of Significance 1946-1989 Property Type Military Applicable Criteria G

(Discuss importance in terms of historical or architectural context as defined by theme, period, and geographic scope. Also address integrity.)

This Cold War-era building is considered a support building, a type found at any Naval installation regardless of mission. It is therefore not of exceptional national significance and is not considered eligible for the National Register of Historic Places (Criterion G).

B11. Additional Resource Attributes: (List attributes and codes) _____

*B12. References:

Real Property Form

B13. Remarks:

*B14. Evaluator: Alexandra C. Cole

Date of Evaluation: 05/01/1998

(This space reserved for official comments.)

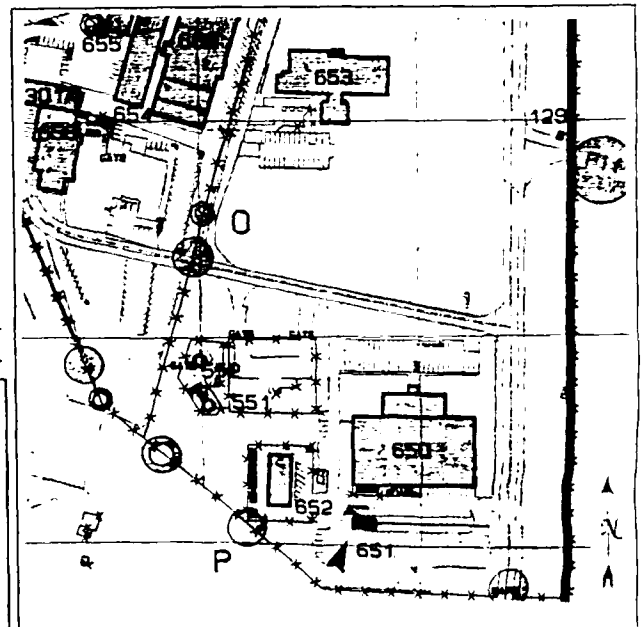

PRIMARY RECORD

Primary # _____
HRI # _____
Trinomial _____
NRHP Status Code 6Z

Other Listings _____
Review Code _____ Reviewer _____ Date / /

Page 1 of 2

*Resource Name or #: 652, Moffett Federal Airfield

P1. Other Identifier: Warehouse

*P2. Location: Not for Publication Unrestricted a. County Santa Clara
b. USGS 7.5' Quad _____ Date _____ T _____; R _____; _____ 1/4 of _____ 1/4 of Sec _____; _____ B.M.
c. Address Jagels Road City Moffett Field Zip 94035
d. UTM: (Give more than one for large and/or linear feature) Zone _____, _____ mE/ _____ mN
e. Other Locational Data: (e.g. parcel #, legal description, directions to resource, elevation, additional UTM's, etc. as appropriate)

*P3a. Description: (Describe resource and its major elements. Include design, materials, condition, alterations, size, setting, and boundaries.)
Building 652 is a rectangular pre-fabricated Varco-Pruden rigid frame metal building with a standing seam metal gable roof. The windows are single pane sliders in metal sash. A metal single door provides access on the east side, sliding metal double doors are located on the south side.

*P3b. Resources Attributes: (List attributes and codes) HP34. Military Property

*P4. Resources Present: Building Structure Object Site District Element of District Other (Isolates, etc.)

P5b. Description of Photo: (View, date, etc.)
Northwest,
April 1998, Roll 1-5

*P6. Date Constructed/Age and Sources:
 Prehistoric Historic Both
1988

*P7. Owner and Address:
U.S.A. as represented by
National Aeronautics and Space
Administration, Washington, D.C.

*P8. Recorded by: (Name, affiliation, address)
Alexandra C. Cole, SAIC
816 State Street, Suite 500
Santa Barbara, CA 93101

*P9. Date Recorded: 06/29/1998

*P10. Survey Type: (Describe)
Comprehensive Survey for Section
106 Compliance



*P11. Report Citation: (Cite survey report/other sources or "none") Inventory and Evaluation of Cold War Era Historical Resources, Moffett Federal Airfield

*Attachments: NONE Location Map Sketch Map Continuation Sheet Building, Structure and Object Record
 Archaeological Record District Record Linear Feature Record Milling Station Record Rock Art Record Artifact Record
 Photograph Record Other: (List) _____

BUILDING, STRUCTURE, AND OBJECT RECORD

Page 2 of 2

*NRHP Status Code 6Z

*Resource Name or #: 652, Moffett Federal Airfield

B1. Historic Name: Building 548

B2. Common Name: Unknown

B3. Original Use: Aircraft Maintenance

B4. Present Use: CANG Warehouse

*B5. Architectural Style: No Style

*B6. Construction History: (Construction date, alterations, and date of alterations.)

1988

*B7. Moved? No Yes Unknown Date: _____ Original Location: _____

*B8. Related Features:

B9a. Architect: Frank M. Studer

b. Builder: Unknown

*B10. Significance: Theme Cold War

Area United States

Period of Significance 1946-1989

Property Type Military

Applicable Criteria G

(Discuss importance in terms of historical or architectural context as defined by theme, period, and geographic scope. Also address integrity.)

This Cold War-era building is considered a support building, a type found at any Naval installation regardless of mission. It is therefore not of exceptional national significance and is not considered eligible for the National Register of Historic Places (Criterion G)

B11. Additional Resource Attributes: (List attributes and codes) _____

*B12. References:

Real Property Form

B13. Remarks:

*B14. Evaluator: Alexandra C. Cole

Date of Evaluation: 05/01/1998

(This space reserved for official comments.)

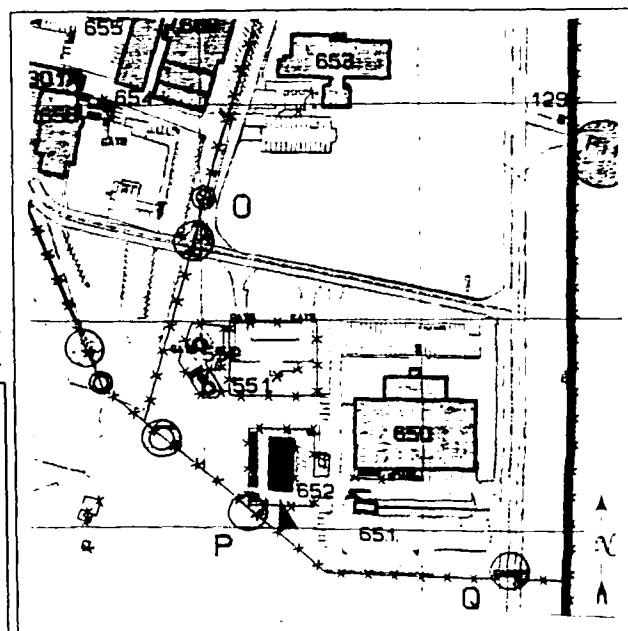

PRIMARY RECORD

Primary # _____
HRI # _____
Trinomial _____
NRHP Status Code 6Z

Other Listings _____
Review Code _____ Reviewer _____ Date / /

Page 1 of 2

*Resource Name or #: 653, Moffett Federal Airfield

P1. Other Identifier: Security Police

*P2. Location: Not for Publication Unrestricted a. County Santa Clara
b. USGS 7.5' Quad _____ Date _____ T _____; R _____; _____ 1/4 of _____ 1/4 of Sec _____; _____ B.M.
c. Address East Patrol Road City Moffett Field Zip 94035
d. UTM: (Give more than one for large and/or linear feature) Zone _____ mE/ _____ mN
e. Other Locational Data: (e.g. parcel #, legal description, directions to resource, elevation, additional UTM, etc. as appropriate)

*P3a. Description: (Describe resource and its major elements. Include design, materials, condition, alterations, size, setting, and boundaries.)

Building 653 is a post-modern one-story rectangular building, constructed of scored concrete, with a square office and lobby wing attached to the south. High ribbon windows with decorative metal louvers are located on the south side. A high one-story section with a clerestory window is located on the north side, housing the ordnance bay. A high overhead door on the west side provides access to this bay. Reflective glass double doors provide access to the lobby on the east and west sides. Decorative elements include the curved clerestory window detail, window louvers, and scored concrete panels.

*P3b. Resources Attributes: (List attributes and codes) HP34, Military Property

*P4. Resources Present: Building Structure Object Site District Element of District Other (Isolates, etc.)

P5b. Description of Photo: (View, date, etc.)
Northwest.

April 1998, Roll 3-18A

*P6. Date Constructed/Age and Sources:
 Prehistoric Historic Both
1984

*P7. Owner and Address:
U.S.A. as represented by
National Aeronautics and Space
Administration, Washington, D.C.

*P8. Recorded by: (Name, affiliation, address)
Alexandra C. Cole, SAIC
816 State Street, Suite 500
Santa Barbara, CA 93101

*P9. Date Recorded: 06/29/1998

*P10. Survey Type: (Describe)
Comprehensive Survey for Section
106 Compliance

*P11. Report Citation: (Cite survey report/other sources or "none") Inventory and Evaluation of Cold War Era Historical
Resources, Moffett Federal Airfield

*Attachments: NONE Location Map Sketch Map Continuation Sheet Building, Structure and Object Record
 Archaeological Record District Record Linear Feature Record Milling Station Record Rock Art Record Artifact Record
 Photograph Record Other: (List) _____

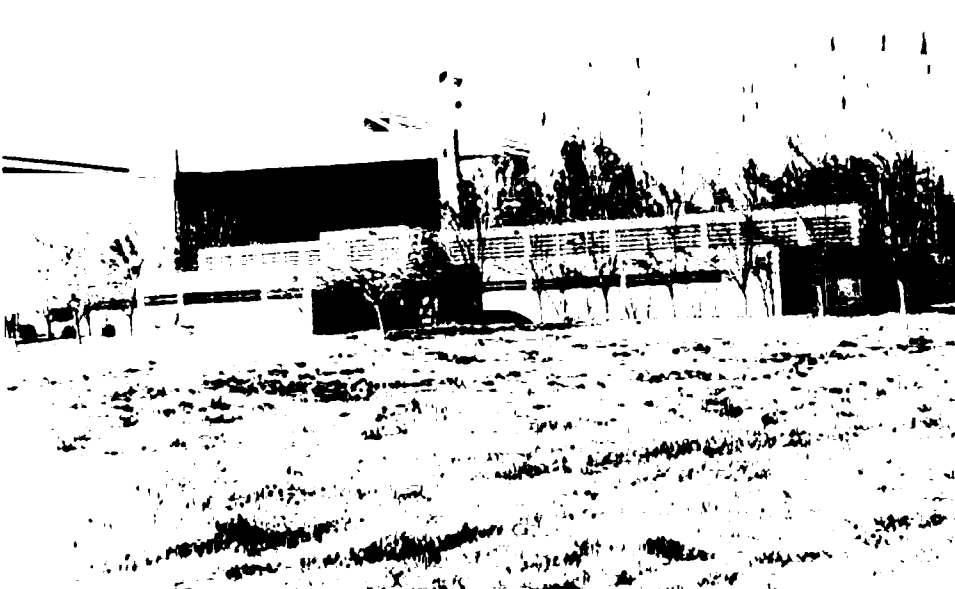

BUILDING, STRUCTURE, AND OBJECT RECORD

Page 2 of 2

*NRHP Status Code 6Z

*Resource Name or #: 653, Moffett Federal Airfield

B1. Historic Name: Building 586

B2. Common Name: Unknown

B3. Original Use: Applied Instruction B4. Present Use: CANG Security Police

*B5. Architectural Style: Post-Modern

*B6. Construction History: (Construction date, alterations, and date of alterations.)
1984; altered by David Takomoto, San Jose, in 1994-96

*B7. Moved? No Yes Unknown Date: _____ Original Location: _____

*B8. Related Features:

B9a. Architect: Ishimaru Design Group b. Builder: Unknown

*B10. Significance: Theme Cold War Area United States

Period of Significance 1946-1989 Property Type Military Applicable Criteria G

(Discuss importance in terms of historical or architectural context as defined by theme, period, and geographic scope. Also address integrity.)

This building provided classrooms for applied instruction in maintenance of P-3 Orions. This building was directly associated with the Cold War P-3 Orion anti-submarine warfare patrol mission dating from 1963 to 1994. Although this mission is considered of exceptional national significance within the Cold War context, this building is of standard construction in the Post-Modern style and does not exhibit unique architectural or engineering features special to the P-3 mission. It is therefore not considered of exceptional significance under criterion G.

B11. Additional Resource Attributes: (List attributes and codes) _____

*B12. References:
C.E. Archives, Building 683

B13. Remarks:

*B14. Evaluator: Alexandra C. Cole

Date of Evaluation: 05/01/1998

(This space reserved for official comments.)

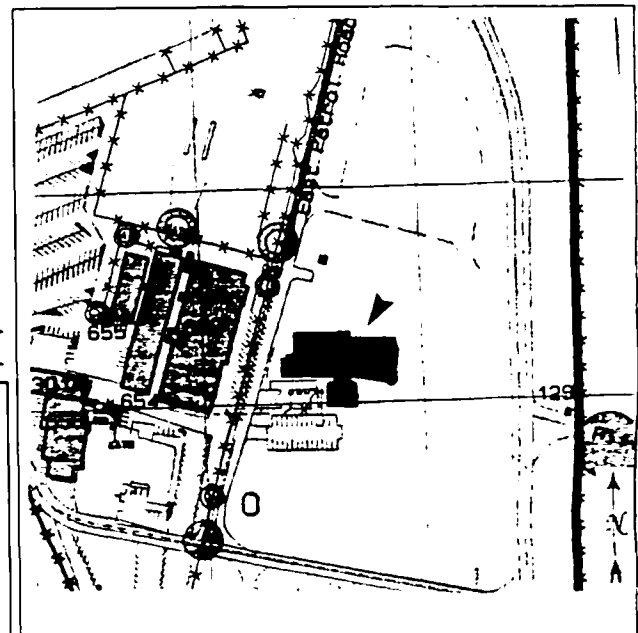

PRIMARY RECORD

Primary # _____
HRI # _____
Trinomial _____
NRHP Status Code 6Z

Other Listings _____
Review Code _____ Reviewer _____ Date / /

Page 1 of 2

*Resource Name or #: 654, Moffett Federal Airfield

P1. Other Identifier: CANG Squadron Operations

*P2. Location: Not for Publication Unrestricted a. County Santa Clara

b. USGS 7.5' Quad _____ Date _____ T _____; R _____; _____ 1/4 of _____ 1/4 of Sec _____; _____ B.M.

c. Address Jagels Road City Moffett Field Zip 94035

d. UTM: (Give more than one for large and/or linear feature) Zone _____, _____ mE/ _____ mN

e. Other Locational Data: (e.g. parcel #, legal description, directions to resource, elevation, additional UTMs, etc. as appropriate)

*P3a. Description: (Describe resource and its major elements. Include design, materials, condition, alterations, size, setting, and boundaries.)

Building 654 is a one-story flat-roofed rectangular concrete building with concrete piers along the east and west sides. A flat-roof Butler pre-fabricated metal shed for the HVAC system extends to the north. Three sets of metal double doors provide access on the west side. New tinted fixed windows in metal frames have been inset in the east and west sides. A new tinted glass and metal door, sheltered by a concrete canopy, provides access on the south side.

*P3b. Resources Attributes: (List attributes and codes) HP34. Military Property

*P4. Resources Present: Building Structure Object Site District Element of District Other (Isolates, etc.)

P5b. Description of Photo: (View, date, etc.)
North,

April 1998, Roll 1-6

*P6. Date Constructed/Age and Sources:
 Prehistoric Historic Both
1969

*P7. Owner and Address:
U.S.A. as represented by
National Aeronautics and Space
Administration, Washington, D.C.

*P8. Recorded by: (Name, affiliation, address)
Alexandra C. Cole, SAIC
816 State Street, Suite 500
Santa Barbara, CA 93101

*P9. Date Recorded: 03/03/1999

*P10. Survey Type: (Describe)
Comprehensive Survey for Section
106 Compliance

*P11. Report Citation: (Cite survey report/other sources or "none") Inventory and Evaluation of Cold War Era Historical Resources, Moffett Federal Airfield

*Attachments: NONE Location Map Sketch Map Continuation Sheet Building, Structure and Object Record
 Archaeological Record District Record Linear Feature Record Milling Station Record Rock Art Record Artifact Record
 Photograph Record Other: (List) _____

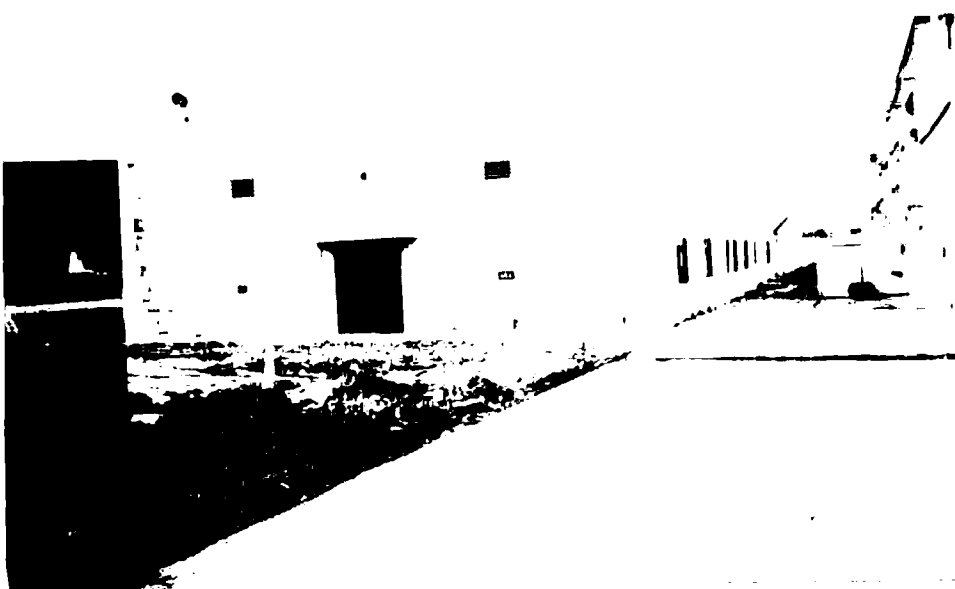

BUILDING, STRUCTURE, AND OBJECT RECORD

Page 2 of 2

*NRHP Status Code 6Z

*Resource Name or #: 654, Moffett Federal Airfield

B1. Historic Name: Building 513

B2. Common Name: Unknown

B3. Original Use: Classroom, Systems Training B4. Present Use: CANG Administration

*B5. Architectural Style: No Style

*B6. Construction History: (Construction date, alterations, and date of alterations.)
1969; windows and new doors in 1994 by David Takamoto Associates

*B7. Moved? No Yes Unknown Date: _____ Original Location: _____

*B8. Related Features:

B9a. Architect: Richard J. Huyk & Asso., Aptos b. Builder: Robert L. Wilson, Oakland

*B10. Significance: Theme Cold War Area United States

Period of Significance 1946-1989 Property Type Military Applicable Criteria G

(Discuss importance in terms of historical or architectural context as defined by theme, period, and geographic scope. Also address integrity.)

With buildings 655 and 669, this classroom building was part of "Orion University" that trained P-3 Orion pilots and technical crews. It has been remodeled for new use. This building was directly associated with the Cold War P-3 Orion anti-submarine warfare patrol mission dating from 1963 to 1994 at Moffett Field. Although this mission is considered of exceptional national significance within the Cold War context, this building is of standard construction and does not exhibit unique architectural or engineering features special to the P-3 mission. It is therefore not considered of exceptional significance under criterion G.

B11. Additional Resource Attributes: (List attributes and codes) _____

*B12. References:
C.E. Files, Building 683

B13. Remarks:

*B14. Evaluator: Alexandra C. Cole

Date of Evaluation: 05/01/1998

(This space reserved for official comments.)

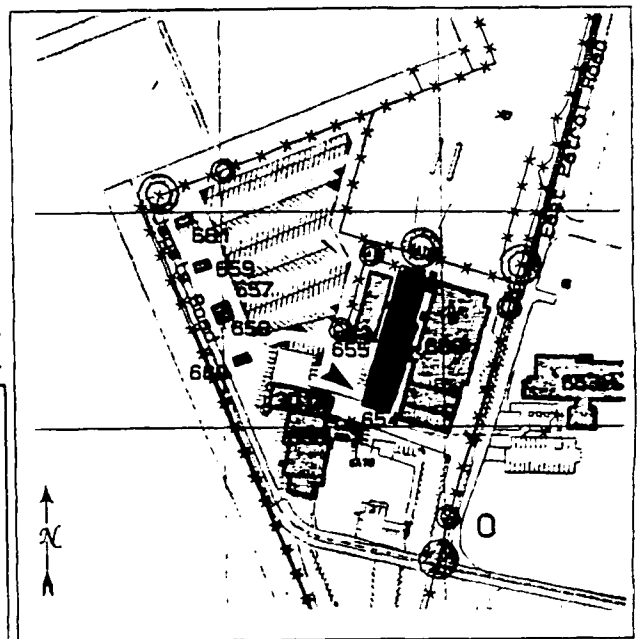

PRIMARY RECORD

Primary # _____
HRI # _____
Trinomial _____
NRHP Status Code 6Z

Other Listings _____
Review Code _____ Reviewer _____ Date / /

Page 1 of 2

*Resource Name or #: 655, Moffett Federal Airfield

P1. Other Identifier: Warehouse

*P2. Location: Not for Publication Unrestricted a. County Santa Clara

b. USGS 7.5' Quad _____ Date _____ T _____; R _____; _____ 1/4 of _____ 1/4 of Sec _____; _____ B.M.

c. Address Jagels Road City Moffett Field Zip 94035

d. UTM: (Give more than one for large and/or linear feature) Zone _____, _____ mE/ _____ mN

e. Other Locational Data: (e.g. parcel #, legal description, directions to resource, elevation, additional UTM, etc. as appropriate)

*P3a. Description: (Describe resource and its major elements. Include design, materials, condition, alterations, size, setting, and boundaries.)

This rectangular one-story pre-fabricated building with corrugated metal walls sits on a concrete foundation. The medium-pitched gable roof is metal. Metal single and double doors provide access on the north and south sides. Three roll-up metal doors have been added on the west side. Fixed and transom multi-paned windows in metal sash provide light on the west side. A shed-roof boiler room is attached to the east side

*P3b. Resources Attributes: (List attributes and codes) HP34. Military Property

*P4. Resources Present: Building Structure Object Site District Element of District Other (Isolates, etc.)

P5b. Description of Photo: (View, date, etc.)
Northeast,

April 1998, Roll 1-7

*P6. Date Constructed/Age and Sources:

Prehistoric Historic Both

1945

*P7. Owner and Address:

U.S.A. as represented by

National Aeronautics and Space

Administration, Washington, D.C.

*P8. Recorded by: (Name, affiliation, address)

Alexandra C. Cole, SAIC

816 State Street, Suite 500

Santa Barbara, CA 93101

*P9. Date Recorded: 03/03/1999

*P10. Survey Type: (Describe)

Comprehensive Survey for Section

106 Compliance

*P11. Report Citation: (Cite survey report/other sources or "none") Inventory and Evaluation of Cold War Era Historical Resources, Moffett Federal Airfield

*Attachments: NONE Location Map Sketch Map Continuation Sheet Building, Structure and Object Record
 Archaeological Record District Record Linear Feature Record Milling Station Record Rock Art Record Artifact Record
 Photograph Record Other: (List) _____

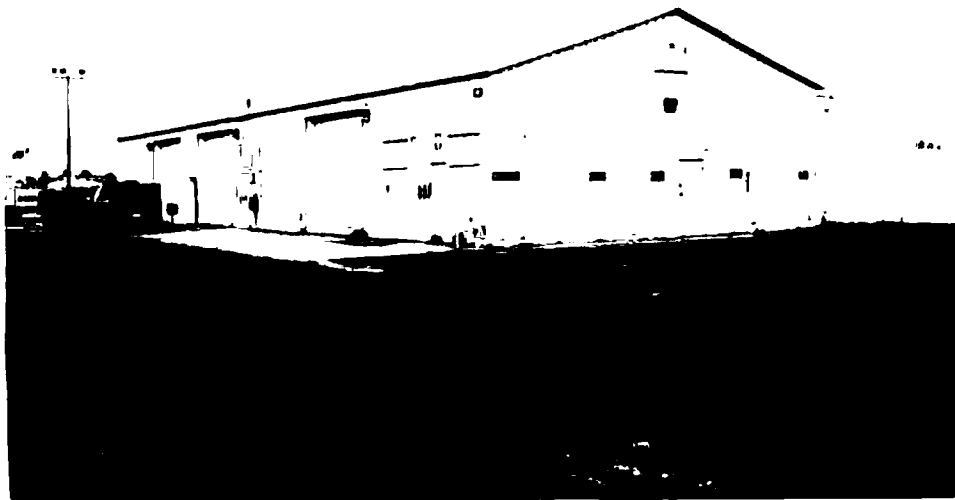

BUILDING, STRUCTURE, AND OBJECT RECORD

Page 2 of 2

*NRHP Status Code 6Z

*Resource Name or #: 655, Moffett Federal Airfield

B1. Historic Name: Building 124

B2. Common Name: Unknown

B3. Original Use: Unknown B4. Present Use: CANG Warehouse

*B5. Architectural Style: No Style

*B6. Construction History: (Construction date, alterations, and date of alterations.)

Built in 1945; it was altered in 1963 for classrooms by George S. Erskine, Menlo Park

*B7. Moved? No Yes Unknown Date: _____ Original Location: _____

*B8. Related Features:

B9a. Architect: Unknown b. Builder: Unknown

*B10. Significance: Theme Cold War Area United States

Period of Significance 1946-1989 Property Type Military Applicable Criteria G

(Discuss importance in terms of historical or architectural context as defined by theme, period, and geographic scope. Also address integrity.)

With buildings 654 and 669, this was part of "Orion University" that trained P-3 Orion pilots and technical crews. This building was directly associated with the Cold War P-3 Orion anti-submarine warfare patrol mission dating from 1963 to 1994 at Moffett Field. Although this mission is considered of exceptional national significance within the Cold War context, this building is of standard World War II construction and does not exhibit unique architectural or engineering modifications special to the P-3 mission. It is therefore not considered of exceptional significance under criterion G.

B11. Additional Resource Attributes: (List attributes and codes) _____

*B12. References:

C.E. Archives, Building 683

B13. Remarks:

*B14. Evaluator: Alexandra C. Cole

Date of Evaluation: 05/01/1998

(This space reserved for official comments.)

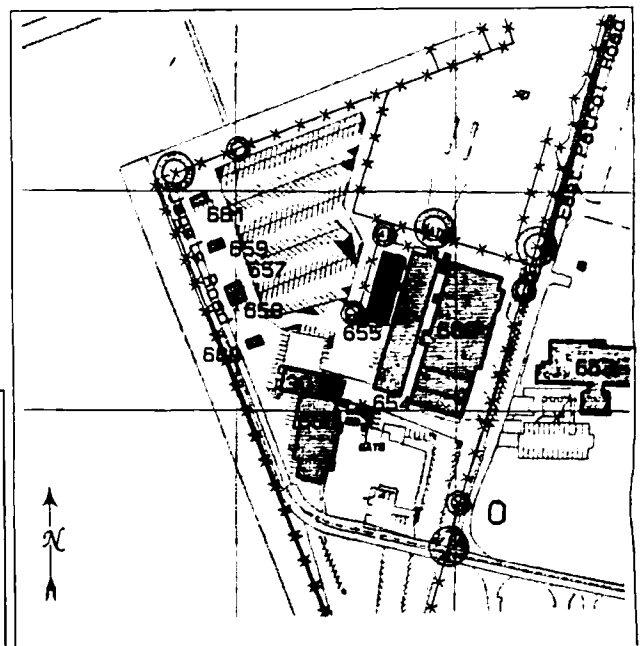

PRIMARY RECORD

Primary # _____
HRI # _____
Trinomial _____
NRHP Status Code 6Z

Other Listings _____
Review Code _____ Reviewer _____ Date / /

Page 1 of 2

*Resource Name or #: 656, Moffett Federal Airfield

P1. Other Identifier: CANG Squadron Operations

*P2. Location: Not for Publication Unrestricted a. County Santa Clara

b. USGS 7.5' Quad _____ Date _____ T _____; R _____; _____ 1/4 of _____ 1/4 of Sec _____; _____ B.M.

c. Address Jagels Road City Moffett Field Zip 94035

d. UTM: (Give more than one for large and/or linear feature) Zone _____, _____ mE/ _____ mN

e. Other Locational Data: (e.g. parcel #, legal description, directions to resource, elevation, additional UTM's, etc. as appropriate)

*P3a. Description: (Describe resource and its major elements. Include design, materials, condition, alterations, size, setting, and boundaries.)

Building 656 consists of three stepped rectangles on a concrete foundation. Constructed of concrete block, the building has a flat roof with a ribbed metal fascia. A pre-fabricated ribbed metal rectangular addition extends from the north side (old 301A). New fixed tinted windows have been added on the south, east, and west sides. A new metal and glass double door entry has been added on the south side. Metal single or double doors provide access on the north and west sides.

*P3b. Resources Attributes: (List attributes and codes) HP34. Military Property

*P4. Resources Present: Building Structure Object Site District Element of District Other (Isolates, etc.)

P5b. Description of Photo: (View, date, etc.)
Northwest,

April 1998, Roll 1-5

*P6. Date Constructed/Age and Sources:

Prehistoric Historic Both

1971

*P7. Owner and Address:

U.S.A. as represented by
National Aeronautics and Space
Administration, Washington, D.C.

*P8. Recorded by: (Name, affiliation, address)

Alexandra C. Cole, SAIC
816 State Street, Suite 500
Santa Barbara, CA 93101

*P9. Date Recorded: 03/03/1999

*P10. Survey Type: (Describe)

Comprehensive Survey for Section
106 Compliance



*P11. Report Citation: (Cite survey report/other sources or "none") Inventory and Evaluation of Cold War Era Historical Resources, Moffett Federal Airfield

*Attachments: NONE Location Map Sketch Map Continuation Sheet Building, Structure and Object Record
 Archaeological Record District Record Linear Feature Record Milling Station Record Rock Art Record Artifact Record
 Photograph Record Other: (List) _____

BUILDING, STRUCTURE, AND OBJECT RECORD

Page 2 of 2

*NRHP Status Code 6Z

*Resource Name or #: 656, Moffett Federal Airfield

B1. Historic Name: Buildings 301, 301A

B2. Common Name: Communications Center

B3. Original Use: Communications, ASW Wing 10 B4. Present Use: CANG Admin./Training

*B5. Architectural Style: No Style

*B6. Construction History: (Construction date, alterations, and date of alterations.)
1971; 1998-alterations, including new windows and door by David Takamoto Associates.

*B7. Moved? No Yes Unknown Date: _____ Original Location: _____

*B8. Related Features:

B9a. Architect: Unknown b. Builder: Unknown

*B10. Significance: Theme Cold War Area United States

Period of Significance 1946-1989 Property Type Military Applicable Criteria G
(Discuss importance in terms of historical or architectural context as defined by theme, period, and geographic scope. Also address integrity.)

Building 656 was the communications and intelligence center for the P-3 Orion Mission, and as such was the most important of all the buildings directly associated with the Cold War P-3 Orion anti-submarine warfare patrol mission dating from 1963 to 1994 at Moffett Field. Although this mission is considered of exceptional national significance within the Cold War context, this building is of standard construction and does not exhibit unique architectural or engineering features special to the P-3 mission. Additionally all the electronics equipment used in this building for communicating with the P-3 aircraft and SOSUS systems has been removed and the exterior has been remodeled for new use. It is therefore not considered of exceptional significance under criterion G.

B11. Additional Resource Attributes: (List attributes and codes) _____

*B12. References:
Real Property Form

B13. Remarks:

*B14. Evaluator: Alexandra C. Cole

Date of Evaluation: 05/01/1998

(This space reserved for official comments.)

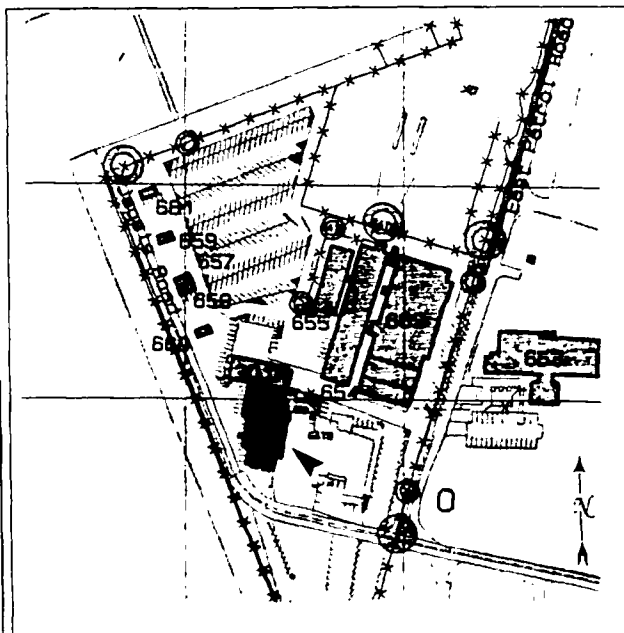

PRIMARY RECORD

Primary # _____

HRI # _____

Trinomial _____

NRHP Status Code 6Z

Other Listings _____

Review Code _____ Reviewer _____ Date / /

Page 1 of 2

*Resource Name or #: 657, Moffett Federal Airfield

P1. Other Identifier: Supply Warehouse

*P2. Location: Not for Publication Unrestricted a. County Santa Clara

b. USGS 7.5' Quad _____ Date _____ T _____; R _____; 1/4 of _____ 1/4 of Sec _____; B.M. _____

c. Address Jagels Road City Moffett Field Zip 94035

d. UTM: (Give more than one for large and/or linear feature) Zone _____, _____ mE/ _____ mN

e. Other Locational Data: (e.g. parcel #, legal description, directions to resource, elevation, additional UTM's, etc. as appropriate)

*P3a. Description: (Describe resource and its major elements. Include design, materials, condition, alterations, size, setting, and boundaries.)
This small rectangular Butler building has a concrete foundation and ribbed metal walls and roof. Metal doors with glass upper panes provide access on the east and west sides. Four-pane top-hinged transom windows are located on the north, south and west sides.

*P3b. Resources Attributes: (List attributes and codes) HP34. Military Property

*P4. Resources Present: Building Structure Object Site District Element of District Other (Isolates, etc.)

P5b. Description of Photo: (View, date, etc.)

657,658, NE

April 1998, Roll 1-9

*P6. Date Constructed/Age and Sources:

Prehistoric Historic Both

1955

*P7. Owner and Address:

U.S.A. as represented by

National Aeronautics and Space

Administration, Washington, D.C.

*P8. Recorded by:(Name, affiliation, address)

Alexandra C. Cole, SAIC

816 State Street, Suite 500

Santa Barbara, CA 93101

*P9. Date Recorded: 03/03/1999

*P10. Survey Type:(Describe)

Comprehensive Survey for Section

106 Compliance

*P11. Report Citation: (Cite survey report/other sources or "none") Inventory and Evaluation of Cold War Era Historical Resources, Moffett Federal Airfield

*Attachments: NONE Location Map Sketch Map Continuation Sheet Building, Structure and Object Record
 Archaeological Record District Record Linear Feature Record Milling Station Record Rock Art Record Artifact Record
 Photograph Record Other: (List) _____

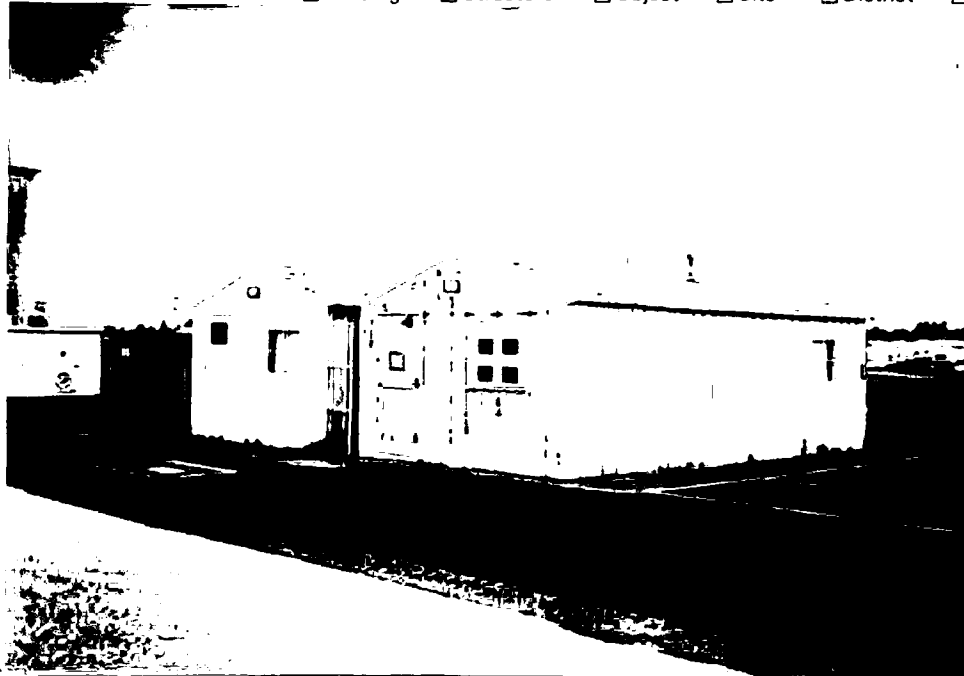

BUILDING, STRUCTURE, AND OBJECT RECORD

Page 2 of 2

*NRHP Status Code 6Z

*Resource Name or #: 657, Moffett Federal Airfield

B1. Historic Name: Building 193

B2. Common Name: Unknown

B3. Original Use: Line Operations B4. Present Use: CANG Warehouse

*B5. Architectural Style: No Style

*B6. Construction History: (Construction date, alterations, and date of alterations.)
1955

*B7. Moved? No Yes Unknown Date: _____ Original Location: _____

*B8. Related Features:

B9a. Architect: Bureau of Yards & Docks, Navy b. Builder: Unknown

*B10. Significance: Theme Cold War Area United States

Period of Significance 1946-1989 Property Type Military Applicable Criteria G

(Discuss importance in terms of historical or architectural context as defined by theme, period, and geographic scope. Also address integrity.)

This Cold War era building is considered a support building, a type found on any Naval installation regardless of mission. It is therefore not of exceptional national significance is is not considered eligible for the National Register of Historic Places (Criterion G).

B11. Additional Resource Attributes: (List attributes and codes) _____

*B12. References:
C.E. Archives, Building 683; Real Property Form

B13. Remarks:

*B14. Evaluator: Alexandra C. Cole

Date of Evaluation: 05/01/1998

(This space reserved for official comments.)

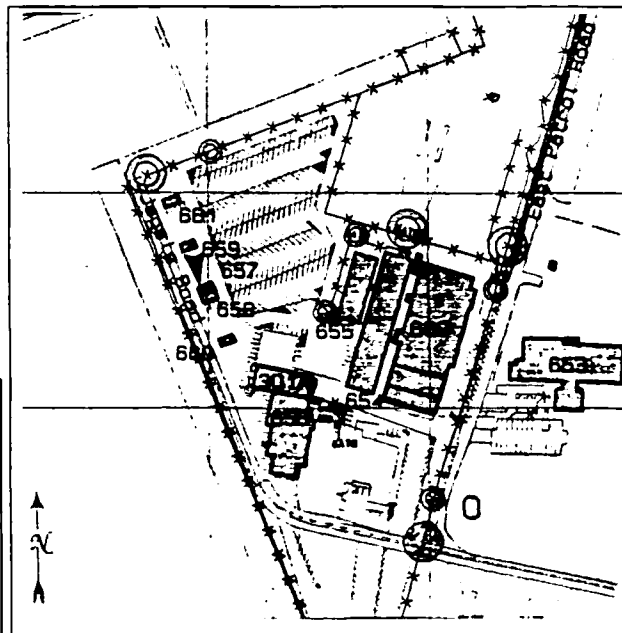

PRIMARY RECORD

Primary # _____
HRI # _____
Trinomial _____
NRHP Status Code 6Z

Other Listings _____
Review Code _____ Reviewer _____ Date / /

Page 1 of 2

*Resource Name or #: 658, Moffett Federal Airfield

P1. Other Identifier: Supply Warehouse

*P2. Location: Not for Publication Unrestricted a. County Santa Clara

b. USGS 7.5' Quad _____ Date _____ T _____; R _____; 1/4 of 1/4 of Sec _____; _____ B.M.

c. Address Jagels Road City Moffett Field Zip 94035

d. UTM: (Give more than one for large and/or linear feature) Zone _____, _____ mE/ _____ mN

e. Other Locational Data: (e.g. parcel #, legal description, directions to resource, elevation, additional UTM's, etc. as appropriate)

*P3a. Description: (Describe resource and its major elements. Include design, materials, condition, alterations, size, setting, and boundaries.)

This small rectangular Butler building has a concrete foundation and ribbed metal walls and roof. Metal doors with glass upper panes provide access on the east and west sides. Four-pane top-hinged transom windows are located on the north, south, and west sides.

*P3b. Resources Attributes: (List attributes and codes) HP34. Military Property

*P4. Resources Present: Building Structure Object Site District Element of District Other (Isolates, etc.)

P5b. Description of Photo: (View, date, etc.)

657, 658, NE

April 1998, Roll 1-9

*P6. Date Constructed/Age and Sources:

Prehistoric Historic Both

1955

*P7. Owner and Address:

U.S.A as represented by

National Aeronautics and Space

Administration, Washington, D.C.

*P8. Recorded by: (Name, affiliation, address)

Alexandra C. Cole, SAIC

816 State Street, Suite 500

Santa Barbara, CA 93101

*P9. Date Recorded: 03/03/1999

*P10. Survey Type: (Describe)

Comprehensive Survey for Section

106 Compliance

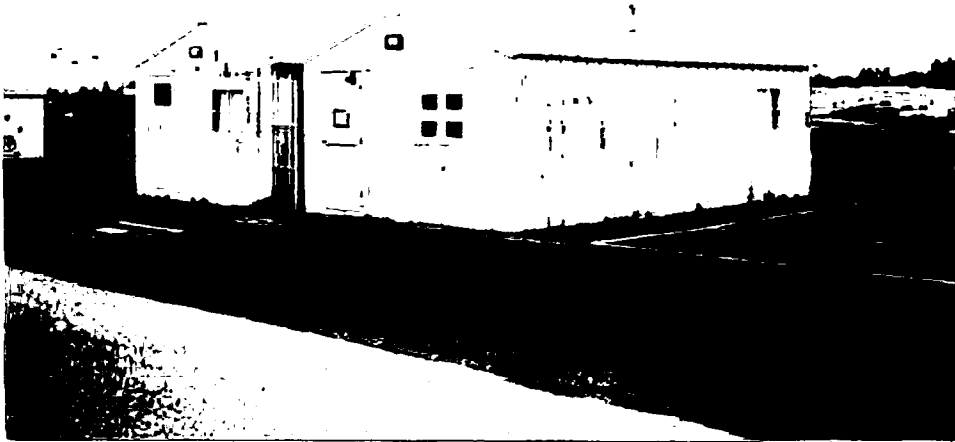

*P11. Report Citation: (Cite survey report/other sources or "none") Inventory and Evaluation of Cold War Era Historical Resources, Moffett Federal Airfield

*Attachments: NONE Location Map Sketch Map Continuation Sheet Building, Structure and Object Record
 Archaeological Record District Record Linear Feature Record Milling Station Record Rock Art Record Artifact Record
 Photograph Record Other: (List) _____

BUILDING, STRUCTURE, AND OBJECT RECORD

Page 2 of 2

*NRHP Status Code 6Z

*Resource Name or #: 658, Moffett Federal Airfield

B1. Historic Name: Building 194

B2. Common Name: Unknown

B3. Original Use: Line Operations B4. Present Use: CANG Warehouse F

*B5. Architectural Style: No Style

*B6. Construction History: (Construction date, alterations, and date of alterations.)
1955

*B7. Moved? No Yes Unknown Date: _____ Original Location: _____

*B8. Related Features:

B9a. Architect: Bureau of Yards & Docks, Navy b. Builder: Unknown

*B10. Significance: Theme Cold War Area United States

Period of Significance 1946-1989 Property Type Military Applicable Criteria G

(Discuss importance in terms of historical or architectural context as defined by theme, period, and geographic scope. Also address integrity.)

This Cold War era building is considered a support building, a type found at any Naval installation regardless of mission. It is therefore not of exceptional national significance and is not considered eligible for the National Register of Historic Places (Criterion G).

B11. Additional Resource Attributes: (List attributes and codes) _____

*B12. References:
C.E. Archives, Building 683; Real Property Form

B13. Remarks:

*B14. Evaluator: Alexandra C. Cole

Date of Evaluation: 05/01/1998

(This space reserved for official comments.)

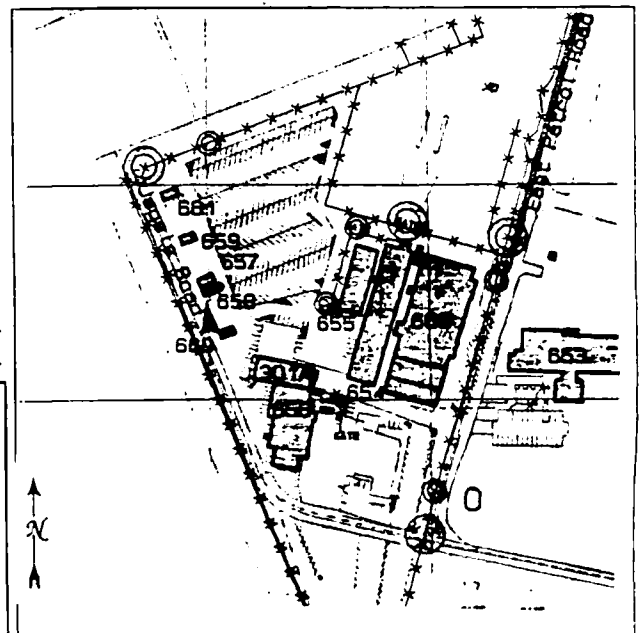

PRIMARY RECORD

Primary # _____
HRI # _____
Trinomial _____
NRHP Status Code 6Z

Other Listings _____
Review Code _____ Reviewer _____ Date / /

Page 1 of 2

*Resource Name or #: 659, Moffett Federal Airfield

P1. Other Identifier: Warehouse

*P2. Location: Not for Publication Unrestricted a. County Santa Clara

b. USGS 7.5' Quad _____ Date _____ T _____; R _____; _____ 1/4 of _____ 1/4 of Sec _____; _____ B.M.

c. Address Jagels Road City Moffett Field Zip 94035

d. UTM: (Give more than one for large and/or linear feature) Zone _____, _____ mE/ _____ mN

e. Other Locational Data: (e.g. parcel #, legal description, directions to resource, elevation, additional UTM's, etc. as appropriate)

*P3a. Description: (Describe resource and its major elements. Include design, materials, condition, alterations, size, setting, and boundaries.)

This small rectangular flat-roofed building is made of concrete. It is divided into six small lockers with heavy metal doors, three on the north and three on the south. Each locker has a metal roof vent.

*P3b. Resources Attributes: (List attributes and codes) HP34. Military Property

*P4. Resources Present: Building Structure Object Site District Element of District Other (Isolates, etc.)

P5b. Description of Photo: (View, date, etc.)
Northeast,

April 1998, Roll 1-10

*P6. Date Constructed/Age and Sources:

Prehistoric Historic Both
1956

*P7. Owner and Address:

U.S.A. as represented by

National Aeronautics and Space

Administration, Washington, D.C.

*P8. Recorded by: (Name, affiliation, address)

Alexandra C. Cole, SAIC

816 State Street, Suite 500

Santa Barbara, CA 93101

*P9. Date Recorded: 03/03/1999

*P10. Survey Type: (Describe)

Comprehensive Survey for Section

106 Compliance



*P11. Report Citation: (Cite survey report/other sources or "none") Inventory and Evaluation of Cold War Era Historical Resources, Moffett Federal Airfield

*Attachments: NONE Location Map Sketch Map Continuation Sheet Building, Structure and Object Record
 Archaeological Record District Record Linear Feature Record Milling Station Record Rock Art Record Artifact Record
 Photograph Record Other: (List) _____

BUILDING, STRUCTURE, AND OBJECT RECORD

Page 2 of 2

*NRHP Status Code 6Z

*Resource Name or #: 659, Moffett Federal Airfield

B1. Historic Name: Building 197

B2. Common Name: Unknown

B3. Original Use: Ammunition Service Locker B4. Present Use: Warehouse

*B5. Architectural Style: No Style

*B6. Construction History: (Construction date, alterations, and date of alterations.)
1956

*B7. Moved? No Yes Unknown Date: _____ Original Location: _____

*B8. Related Features:

B9a. Architect: Bureau of Yards & Docks, Navy b. Builder: Unknown

*B10. Significance: Theme Cold War Area United States

Period of Significance 1946-1989 Property Type Military Applicable Criteria G

(Discuss importance in terms of historical or architectural context as defined by theme, period, and geographic scope. Also address integrity.)

This Cold War era building is considered a support building, a type found at any Naval installation regardless of mission. It is therefore not of exceptional national significance and is not considered eligible for the National Register of Historic Places (Criterion G).

B11. Additional Resource Attributes: (List attributes and codes) _____

*B12. References:
C.E. Archives, Building 683; Real Property Form

B13. Remarks:

*B14. Evaluator: Alexandra C. Cole

Date of Evaluation: 05/01/1998

(This space reserved for official comments.)

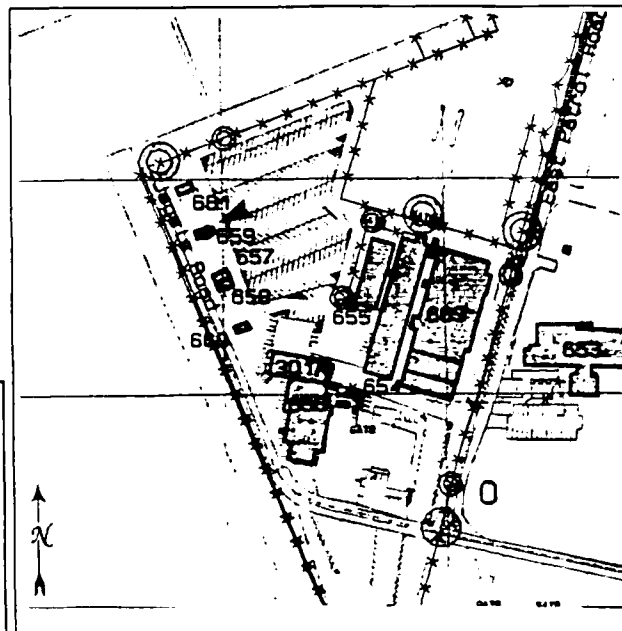

PRIMARY RECORD

Primary # _____
HRI # _____
Trinomial _____
NRHP Status Code 6Z

Other Listings _____
Review Code _____ Reviewer _____ Date / /

Page 1 of 2

*Resource Name or #: 660, Moffett Federal Airfield

P1. Other Identifier: Warehouse

*P2. Location: Not for Publication Unrestricted a. County Santa Clara

b. USGS 7.5' Quad _____ Date _____ T _____; R _____; _____ 1/4 of _____ 1/4 of Sec _____; _____ B.M.

c. Address Jagels Road City Moffett Field Zip 94035

d. UTM: (Give more than one for large and/or linear feature) Zone _____, _____ mE/ _____ mN

e. Other Locational Data: (e.g. parcel #, legal description, directions to resource, elevation, additional UTM's, etc. as appropriate)

*P3a. Description: (Describe resource and its major elements. Include design, materials, condition, alterations, size, setting, and boundaries.)

This small rectangular flat-roofed building is made of concrete. It is divided into six small lockers with heavy metal doors, three on the north and three on the south. Each locker has a metal roof vent.

*P3b. Resources Attributes: (List attributes and codes) HP34. Military Property

*P4. Resources Present: Building Structure Object Site District Element of District Other (Isolates, etc.)

P5b. Description of Photo: (View, date, etc.)
Northeast,

April 1998, Roll 1-8

*P6. Date Constructed/Age and Sources:
 Prehistoric Historic Both
1956

*P7. Owner and Address:
U.S.A. as represented by
National Aeronautics and Space
Administration, Washington, D.C.

*P8. Recorded by: (Name, affiliation, address)
Alexandra C. Cole, SAIC
816 State Street, Suite 500
Santa Barbara, CA 93101

*P9. Date Recorded: 03/03/1999

*P10. Survey Type: (Describe)
Comprehensive Survey for Section
106 Compliance

*P11. Report Citation: (Cite survey report/other sources or "none") Inventory and Evaluation of Cold War Era Historical Resources, Moffett Federal Airfield

*Attachments: NONE Location Map Sketch Map Continuation Sheet Building, Structure and Object Record
 Archaeological Record District Record Linear Feature Record Milling Station Record Rock Art Record Artifact Record
 Photograph Record Other: (List) _____

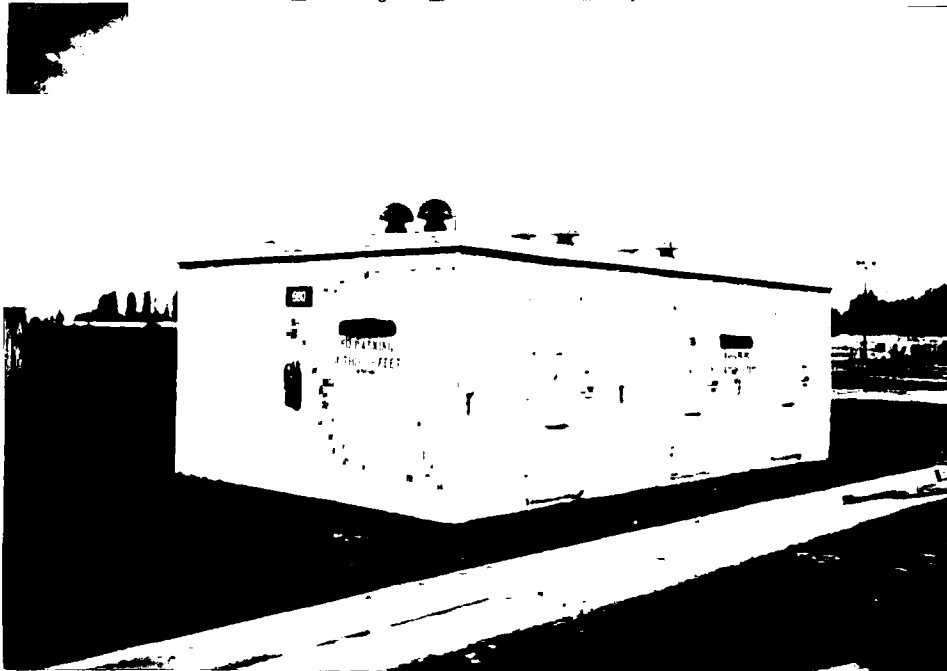

BUILDING, STRUCTURE, AND OBJECT RECORD

Page 2 of 2

*NRHP Status Code 6Z

*Resource Name or #: 660, Moffett Federal Airfield

B1. Historic Name: Building 198

B2. Common Name: Unknown

B3. Original Use: Ammunition Service Locker B4. Present Use: Warehouse H

*B5. Architectural Style: No Style

*B6. Construction History: (Construction date, alterations, and date of alterations.)
1956

*B7. Moved? No Yes Unknown Date: _____ Original Location: _____

*B8. Related Features:

B9a. Architect: Bureau of Yards & Docks, Navy b. Builder: Unknown

*B10. Significance: Theme Cold War Area United States
Period of Significance 1946-1989 Property Type Military Applicable Criteria G

(Discuss importance in terms of historical or architectural context as defined by theme, period, and geographic scope. Also address integrity.)

This Cold War era building is considered a support building, a type found at any Naval installation regardless of mission. It is therefore not of exceptional national significance and is not considered eligible for the National Register of Historic Places (Criterion G).

B11. Additional Resource Attributes: (List attributes and codes) _____

*B12. References:

C.E. Archives, Building 683; Real Property Form

B13. Remarks:

*B14. Evaluator: Alexandra C. Cole

Date of Evaluation: 05/01/1998

(This space reserved for official comments.)

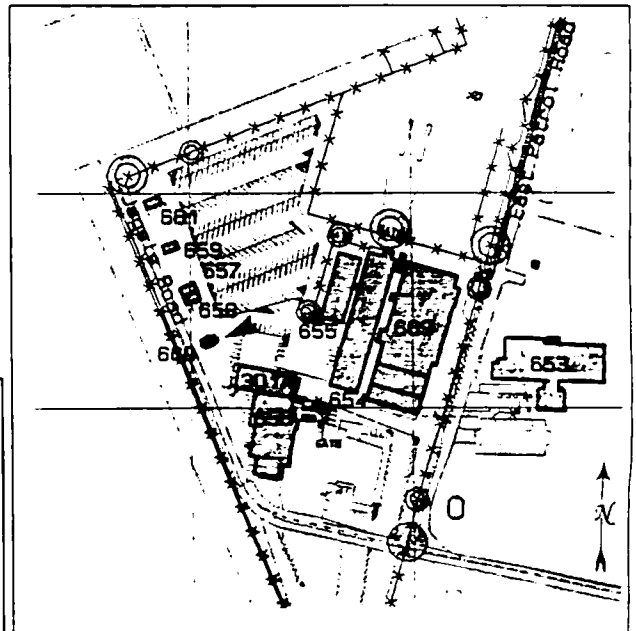

PRIMARY RECORD

Primary # _____
HRI # _____
Trinomial _____
NRHP Status Code 6Z

Other Listings _____
Review Code _____ Reviewer _____ Date / /

Page 1 of 2

*Resource Name or #: 661, Moffett Federal Airfield

P1. Other Identifier: Warehouse

*P2. Location: Not for Publication Unrestricted a. County Santa Clara

b. USGS 7.5' Quad _____ Date _____ T _____; R _____; _____ 1/4 of _____ 1/4 of Sec _____; _____ B.M.

c. Address Jagels Road City Moffett Field Zip 94035

d. UTM: (Give more than one for large and/or linear feature) Zone _____, _____ mE/ _____ mN

e. Other Locational Data: (e.g. parcel #, legal description, directions to resource, elevation, additional UTM's, etc. as appropriate)

*P3a. Description: (Describe resource and its major elements. Include design, materials, condition, alterations, size, setting, and boundaries.)

This small rectangular Butler building has a concrete foundation and ribbed metal walls and roof. Metal doors provide access on the east and west sides. Four-pane top-hinged transom windows are located on the north, south and west sides.

*P3b. Resources Attributes: (List attributes and codes) HP34. Military Property

*P4. Resources Present: Building Structure Object Site District Element of District Other (Isolates, etc.)

P5b. Description of Photo: (View, date, etc.)
Northeast,

April 1998, Roll 1-11

*P6. Date Constructed/Age and Sources:
 Prehistoric Historic Both
1956

*P7. Owner and Address:
U.S.A. as represented by
National Aeronautics and Space
Administration, Washington, D.C.

*P8. Recorded by: (Name, affiliation, address)
Alexandra C. Cole, SAIC
816 State Street, Suite 500
Santa Barbara, CA 93101

*P9. Date Recorded: 03/03/1999

*P10. Survey Type: (Describe)
Comprehensive Survey for Section
106 Compliance



*P11. Report Citation: (Cite survey report/other sources or "none") Inventory and Evaluation of Cold War Era Historical Resources, Moffett Federal Airfield

*Attachments: NONE Location Map Sketch Map Continuation Sheet Building, Structure and Object Record
 Archaeological Record District Record Linear Feature Record Milling Station Record Rock Art Record Artifact Record
 Photograph Record Other: (List) _____

BUILDING, STRUCTURE, AND OBJECT RECORD

Page 2 of 2

*NRHP Status Code 6Z

*Resource Name or #: 661, Moffett Federal Airfield

B1. Historic Name: Building 199

B2. Common Name: Unknown

B3. Original Use: Line Operations B4. Present Use: Warehouse I

*B5. Architectural Style: No Style

*B6. Construction History: (Construction date, alterations, and date of alterations.)
1956

*B7. Moved? No Yes Unknown Date: _____ Original Location: _____

*B8. Related Features:

B9a. Architect: Bureau of Yards & Docks, Navy b. Builder: Unknown

*B10. Significance: Theme Cold War Area United States

Period of Significance 1946-1989 Property Type Military Applicable Criteria G

(Discuss importance in terms of historical or architectural context as defined by theme, period, and geographic scope. Also address integrity.)

This Cold War era building is considered a support building, a type found at any Naval installation regardless of mission. It is therefore not of exceptional national significance and is not considered eligible for the National Register of Historic Places (Criterion G).

B11. Additional Resource Attributes: (List attributes and codes) _____

*B12. References:
C.E. Archives, Building 683; Real Property Form

B13. Remarks:

*B14. Evaluator: Alexandra C. Cole
Date of Evaluation: 05/01/1998

(This space reserved for official comments.)

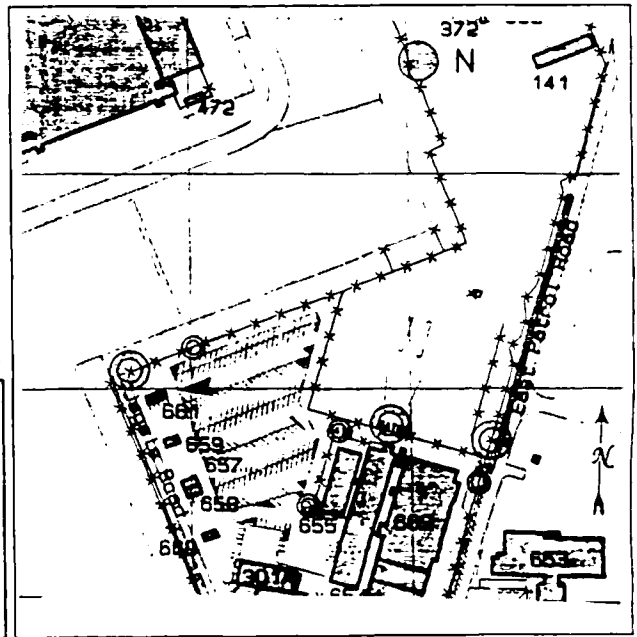

*Required information

PRIMARY RECORD

Primary # _____
HRI # _____
Trinomial _____
NRHP Status Code 6Z
Other Listings _____
Review Code _____ Reviewer _____ Date / /

Page 1 of 2

*Resource Name or #: 669, Moffett Federal Airfield

P1. Other Identifier: Maintenance

*P2. Location: Not for Publication Unrestricted a. County Santa Clara
b. USGS 7.5' Quad _____ Date _____ T _____; R _____; 1/4 of _____ 1/4 of Sec _____; B.M. _____
c. Address East Patrol Road City Moffett Field Zip 94035
d. UTM: (Give more than one for large and/or linear feature) Zone _____, _____ mE/ _____ mN
e. Other Locational Data: (e.g. parcel #, legal description, directions to resource, elevation, additional UTM's, etc. as appropriate)

*P3a. Description: (Describe resource and its major elements. Include design, materials, condition, alterations, size, setting, and boundaries.)
Building 669 has a two-story flat-roofed main block with a one-story wing to the north and a one-story ell to the south. The wing, with a high concrete foundation, has a loading dock on its east side. Metal single or double doors provide access on the south, east, and west sides. High overhead doors are located on the east and west sides of the main block. Double-hung windows in wood sash are located on the west, north, and east sides. The ell has sliding aluminum sash windows.

*P3b. Resources Attributes: (List attributes and codes) HP34, Military Property

*P4. Resources Present: Building Structure Object Site District Element of District Other (Isolates, etc.)

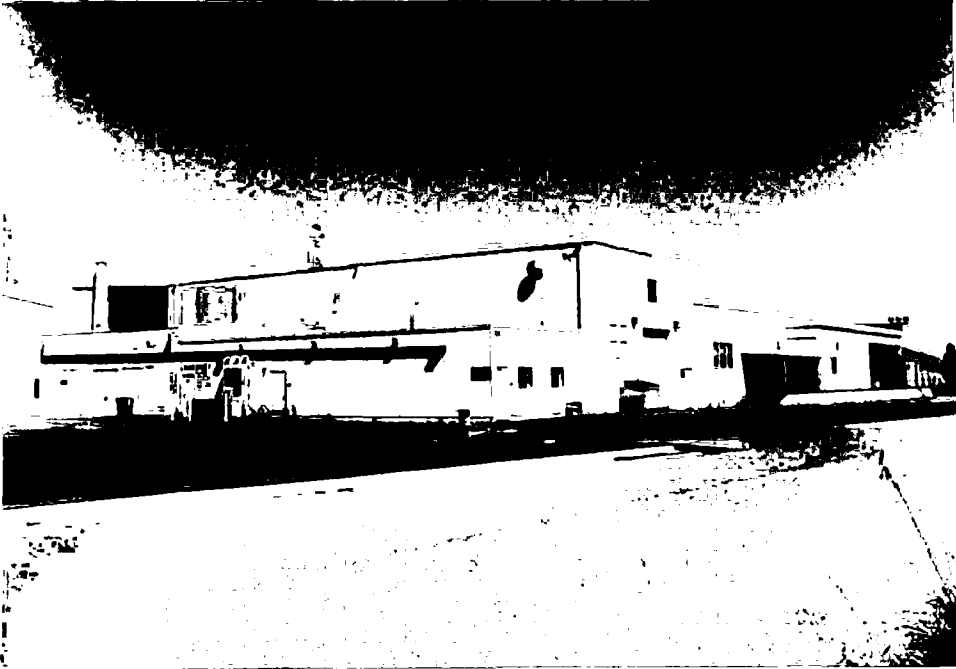

P5b. Description of Photo: (View, date, etc.)
North,

April 1998, Roll 7-15

*P6. Date Constructed/Age and Sources:
 Prehistoric Historic Both
1943

*P7. Owner and Address:
U.S.A. as represented by
National Aeronautics and Space
Administration, Washington, D.C.

*P8. Recorded by: (Name, affiliation, address)
Alexandra C. Cole, SAIC
816 State Street, Suite 500
Santa Barbara, CA 93101

*P9. Date Recorded: 06/29/1998

*P10. Survey Type: (Describe)
Comprehensive Survey for Section
106 Compliance

*P11. Report Citation: (Cite survey report/other sources or "none") Inventory and Evaluation of Cold War Era Historical Resources, Moffett Federal Airfield

*Attachments: NONE Location Map Sketch Map Continuation Sheet Building, Structure and Object Record
 Archaeological Record District Record Linear Feature Record Milling Station Record Rock Art Record Artifact Record
 Photograph Record Other: (List) _____

BUILDING, STRUCTURE, AND OBJECT RECORD

Page 2 of 2

*NRHP Status Code 6Z

*Resource Name or #: 669, Moffett Federal Airfield

B1. Historic Name: Building 49

B2. Common Name: Unknown

B3. Original Use: Unknown B4. Present Use: CANG Maintenance

*B5. Architectural Style: No Style

*B6. Construction History: (Construction date, alterations, and date of alterations.)
1943; 1963, altered by George S. Erskine and Associates, Menlo Park, for P-3 training school; 1998, altered for CANG engine repair.

*B7. Moved? No Yes Unknown Date: _____ Original Location: _____

*B8. Related Features:

B9a. Architect: Unknown b. Builder: Unknown

*B10. Significance: Theme Cold War Area United States

Period of Significance 1946-1989 Property Type Military Applicable Criteria G

(Discuss importance in terms of historical or architectural context as defined by theme, period, and geographic scope. Also address integrity.)

With buildings 654 and 655, this was part of "Orion University" that trained P-3 Orion pilots and technical crews. This building was directly associated with the Cold War P-3 Orion anti-submarine warfare patrol mission dating from 1963 to 1994 at Moffett Field. Although this mission is considered of exceptional national significance within the Cold War context, this building is of standard World War II construction and does not exhibit unique architectural or engineering modifications special to the P-3 mission. It is therefore not considered of exceptional significance under criterion G.

B11. Additional Resource Attributes: (List attributes and codes) _____

*B12. References:
CANG Master Plan 1997; Civil Engineering Archives, Building 683

B13. Remarks:

*B14. Evaluator: Alexandra C. Cole

Date of Evaluation: 05/01/1998

(This space reserved for official comments.)

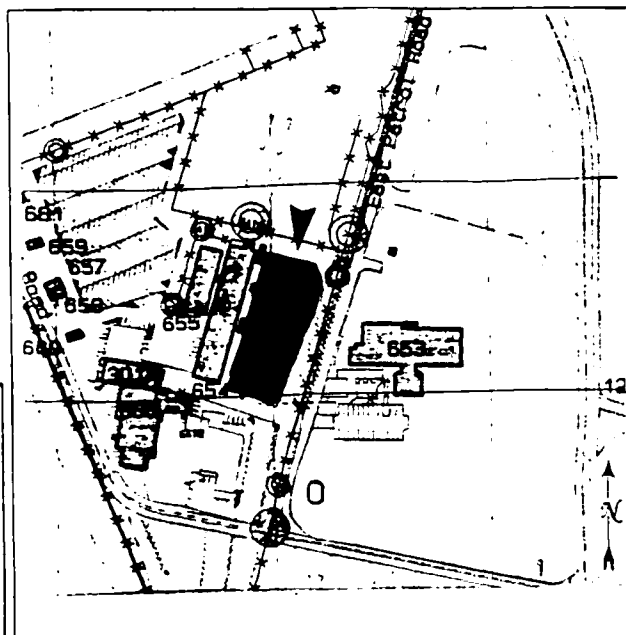

PRIMARY RECORD

Primary # _____
HRI # _____
Trinomial _____
NRHP Status Code 6Z

Other Listings _____
Review Code _____ Reviewer _____ Date / /

Page 1 of 2

*Resource Name or #: 679, Moffett Federal Airfield

P1. Other Identifier: Storage Shed

*P2. Location: Not for Publication Unrestricted a. County Santa Clara
b. USGS 7.5' Quad _____ Date _____ T _____; R _____; _____ 1/4 of _____ 1/4 of Sec _____; _____ B.M.
c. Address Macon Road City Moffett Field Zip 94035
d. UTM: (Give more than one for large and/or linear feature) Zone _____, _____ mE/ _____ mN
e. Other Locational Data: (e.g. parcel #, legal description, directions to resource, elevation, additional UTM's, etc. as appropriate)

*P3a. Description: (Describe resource and its major elements. Include design, materials, condition, alterations, size, setting, and boundaries.)
This high one-story rectangular storage building is constructed of rough- finished concrete block lower walls and ribbed metal upper walls. The roof is flat. Two high overhead doors and four metal personnel doors provide access on the north side. A rough-finished concrete block wall connects this building to #683.

*P3b. Resources Attributes: (List attributes and codes) HP34. Military Property

*P4. Resources Present: Building Structure Object Site District Element of District Other (Isolates, etc.)

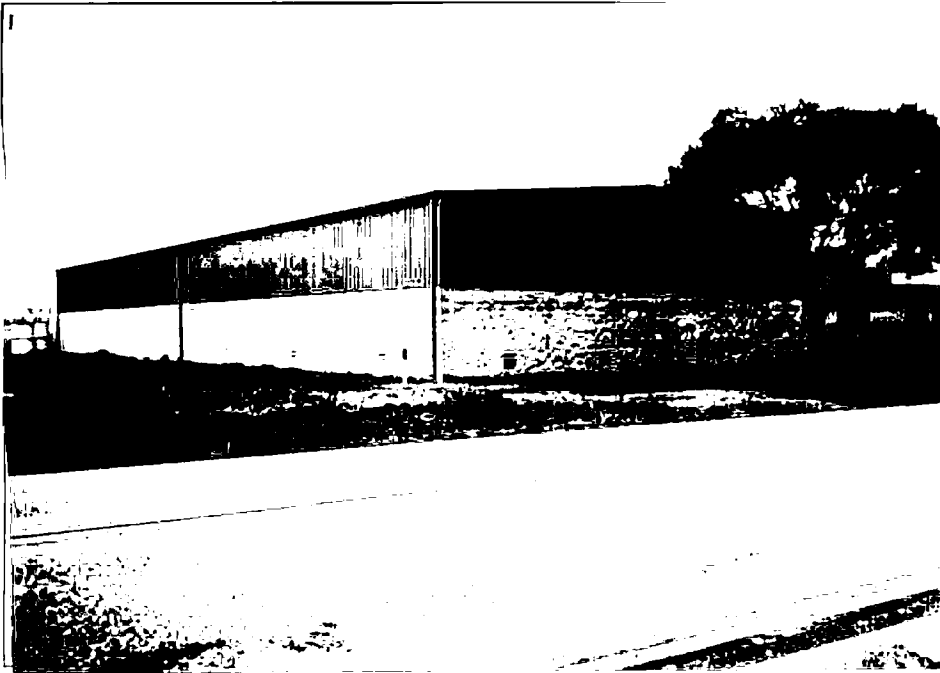

P5b. Description of Photo: (View, date, etc.)
Northwest,
April 1998, Roll 1-24

*P6. Date Constructed/Age and Sources:
 Prehistoric Historic Both
1992

*P7. Owner and Address:
U.S.A. as represented by
National Aeronautics and Space
Administration, Washington, D.C.

*P8. Recorded by: (Name, affiliation, address)
Alexandra C. Cole, SAIC
816 State Street, Suite 500
Santa Barbara, CA 93101

*P9. Date Recorded: 06/29/1998

*P10. Survey Type: (Describe)
Comprehensive Survey for Section
106 Compliance

*P11. Report Citation: (Cite survey report/other sources or "none") Inventory and Evaluation of Cold War Era Historical Resources, Moffett Federal Airfield

*Attachments: NONE Location Map Sketch Map Continuation Sheet Building, Structure and Object Record
 Archaeological Record District Record Linear Feature Record Milling Station Record Rock Art Record Artifact Record
 Photograph Record Other: (List) _____

BUILDING, STRUCTURE, AND OBJECT RECORD

Page 2 of 2

*NRHP Status Code 6Z

*Resource Name or #: 679, Moffett Federal Airfield

B1. Historic Name: Unknown

B2. Common Name: Unknown

B3. Original Use: Storage Shed B4. Present Use: CANG Storage Shed

*B5. Architectural Style: No Style

*B6. Construction History: (Construction date, alterations, and date of alterations.)
1992

*B7. Moved? No Yes Unknown Date: _____ Original Location: _____

*B8. Related Features:

B9a. Architect: Foster Engineering b. Builder: Unknown

*B10. Significance: Theme Cold War Area United States

Period of Significance 1946-1989 Property Type Military Applicable Criteria G

(Discuss importance in terms of historical or architectural context as defined by theme, period, and geographic scope. Also address integrity.)

This Cold War-era building is considered a support building, a type found at any Naval installation regardless of mission. It is therefore not of exceptional national significance and is not considered eligible for the National Register of Historic Places (Criterion G).

B11. Additional Resource Attributes: (List attributes and codes) _____

*B12. References:
Real Property Form

B13. Remarks:

*B14. Evaluator: Alexandra C. Cole

Date of Evaluation: 05/01/1998

(This space reserved for official comments.)

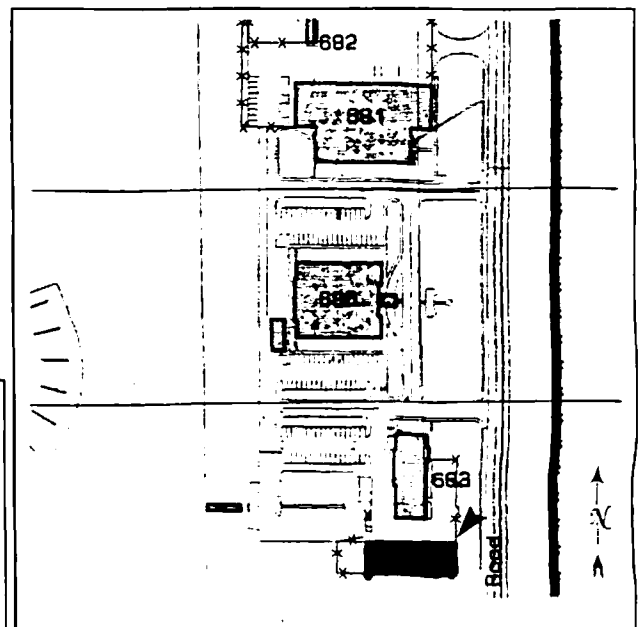

PRIMARY RECORD

Primary # _____
HRI # _____
Trinomial _____
NRHP Status Code 6Z

Other Listings _____
Review Code _____ Reviewer _____ Date / /

Page 1 of 2

*Resource Name or #: 680. Moffett Federal Airfield

P1. Other Identifier: Administration

*P2. Location: Not for Publication Unrestricted a. County Santa Clara
b. USGS 7.5' Quad _____ Date _____ T _____; R _____; _____ 1/4 of _____ 1/4 of Sec _____; _____ B.M.
c. Address Macon Road City Moffett Field Zip 94035
d. UTM: (Give more than one for large and/or linear feature) Zone _____, _____ mE/ _____ mN
e. Other Locational Data: (e.g. parcel #, legal description, directions to resource, elevation, additional UTM, etc. as appropriate)

*P3a. Description: (Describe resource and its major elements. Include design, materials, condition, alterations, size, setting, and boundaries.)
This one-story square building consists of a flat-roofed central block flanked by shed-roof wings. The lower walls are glazed concrete block and the upper walls are ribbed metal. Brushed concrete buttresses with bermed walls topped by tinted ribbon windows in metal frames are located on the north and south sides. The central entrance (west) has double doors of mirrored glass in metal frames, flanked by mirrored-glass walls. Single mirrored glass doors provide access on the west side.

*P3b. Resources Attributes: (List attributes and codes) HP34. Military Property

*P4. Resources Present: Building Structure Object Site District Element of District Other (Isolates, etc.)



P5b. Description of Photo: (View, date, etc.)
Northwest,
April 1998, Roll 1-1

*P6. Date Constructed/Age and Sources:
 Prehistoric Historic Both
1980

*P7. Owner and Address:
U.S.A. as represented by
National Aeronautics and Space
Administration, Washington, D.C.

*P8. Recorded by: (Name, affiliation, address)
Alexandra C. Cole, SAIC
816 State Street, Suite 500
Santa Barbara, CA 93101

*P9. Date Recorded: 06/29/1998

*P10. Survey Type: (Describe)
Comprehensive Survey for Section
106 Compliance

*P11. Report Citation: (Cite survey report/other sources or "none") Inventory and Evaluation of Cold War Era Historical Resources, Moffett Federal Airfield

*Attachments: NONE Location Map Sketch Map Continuation Sheet Building, Structure and Object Record
 Archaeological Record District Record Linear Feature Record Milling Station Record Rock Art Record Artifact Record
 Photograph Record Other: (List) _____

BUILDING, STRUCTURE, AND OBJECT RECORD

Page 2 of 2

*NRHP Status Code 6Z

*Resource Name or #: 680, Moffett Federal Airfield

B1. Historic Name: Unknown

B2. Common Name: Unknown

B3. Original Use: Reserve Forces Training B4. Present Use: CANG Headquarters

*B5. Architectural Style: No Style

*B6. Construction History: (Construction date, alterations, and date of alterations.)
1980

*B7. Moved? No Yes Unknown Date: _____ Original Location: _____

*B8. Related Features:

B9a. Architect: Reid & Tarics, S.F. b. Builder: Unknown

*B10. Significance: Theme Cold War Area United States
Period of Significance 1946-1989 Property Type Military Applicable Criteria G

(Discuss importance in terms of historical or architectural context as defined by theme, period, and geographic scope. Also address integrity.)

This Cold War-era building is considered a support building, a type found at any Naval installation regardless of mission. It is therefore not of exceptional national significance and is not considered eligible for the National Register of Historic Places (Criterion G).

B11. Additional Resource Attributes: (List attributes and codes) _____

*B12. References:
Real Property Form

B13. Remarks:

*B14. Evaluator: Alexandra C. Cole
Date of Evaluation: 05/01/1998

(This space reserved for official comments.)

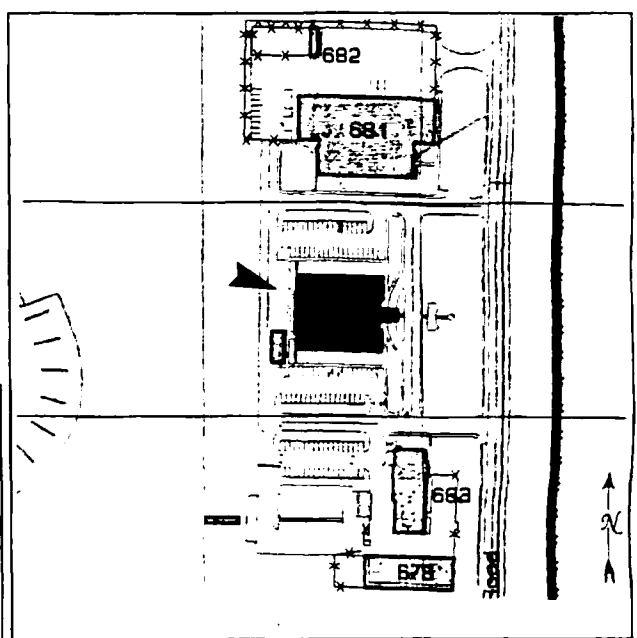

PRIMARY RECORD

Primary # _____
HRI # _____
Trinomial _____
NRHP Status Code 6Z

Other Listings _____
Review Code _____ Reviewer _____ Date / /

Page 1 of 2

*Resource Name or #: 681, Moffett Federal Airfield

P1. Other Identifier: Administration/Supply

*P2. Location: Not for Publication Unrestricted a. County Santa Clara
b. USGS 7.5' Quad _____ Date _____ T _____; R _____; _____ 1/4 of _____ 1/4 of Sec _____; _____ B.M.
c. Address Macon Road City Moffett Field Zip 94035
d. UTM: (Give more than one for large and/or linear feature) Zone _____, _____ mE/ _____ mN
e. Other Locational Data: (e.g. parcel #, legal description, directions to resource, elevation, additional UTM's, etc. as appropriate)

*P3a. Description: (Describe resource and its major elements. Include design, materials, condition, alterations, size, setting, and boundaries.)

This rectangular building consists of a one-story shed-roof administrative building connected to a high one-story flat-roof supply building. The lower walls consist of glazed concrete blocks and the upper walls of ribbed metal. The entrance wall on the south side consists of brushed concrete buttresses with planted berms topped by tinted ribbon windows in metal frames. Single mirrored-glass doors provide access on the south and west sides of the administrative building. High overhead doors and metal single doors provide access on the north and west sides of the supply building.

*P3b. Resources Attributes: (List attributes and codes) HP34. Military Property

*P4. Resources Present: Building Structure Object Site District Element of District Other (Isolates, etc.)

P5b. Description of Photo: (View, date, etc.)
Northwest,
April 1998, Roll 1-25

*P6. Date Constructed/Age and Sources:
 Prehistoric Historic Both
1980

*P7. Owner and Address:
U.S.A. as represented by
National Aeronautics and Space
Administration, Washington, D.C.

*P8. Recorded by: (Name, affiliation, address)
Alexandra C. Cole, SAIC
816 State Street, Suite 500
Santa Barbara, CA 93101

*P9. Date Recorded: 06/29/1998

*P10. Survey Type: (Describe)
Comprehensive Survey for Section
106 Compliance

*P11. Report Citation: (Cite survey report/other sources or "none") Inventory and Evaluation of Cold War Era Historical
Resources, Moffett Federal Airfield

*Attachments: NONE Location Map Sketch Map Continuation Sheet Building, Structure and Object Record
 Archaeological Record District Record Linear Feature Record Milling Station Record Rock Art Record Artifact Record
 Photograph Record Other: (List) _____



BUILDING, STRUCTURE, AND OBJECT RECORD

Page 2 of 2

*NRHP Status Code 6Z

*Resource Name or #: 681, Moffett Federal Airfield

B1. Historic Name: Unknown

B2. Common Name: Unknown

B3. Original Use: Equipment Warehouse

B4. Present Use: CANG Administrative/Supply

*B5. Architectural Style: No Style

*B6. Construction History: (Construction date, alterations, and date of alterations.)

1980

*B7. Moved? No Yes Unknown Date: _____ Original Location: _____

*B8. Related Features:

B9a. Architect: Reid & Tarics, S.F.

b. Builder: Unknown

*B10. Significance: Theme Cold War

Area United States

Period of Significance 1946-1989

Property Type Military

Applicable Criteria G

(Discuss importance in terms of historical or architectural context as defined by theme, period, and geographic scope. Also address integrity.)

This Cold War-era building is considered a support building, a type found at any Naval installation regardless of mission. It is therefore not of exceptional national significance and is not considered eligible for the National Register of Historic Places (Criterion G).

B11. Additional Resource Attributes: (List attributes and codes) _____

*B12. References:

Real Property Form

B13. Remarks:

*B14. Evaluator: Alexandra C. Cole

Date of Evaluation: 05/01/1998

(This space reserved for official comments.)

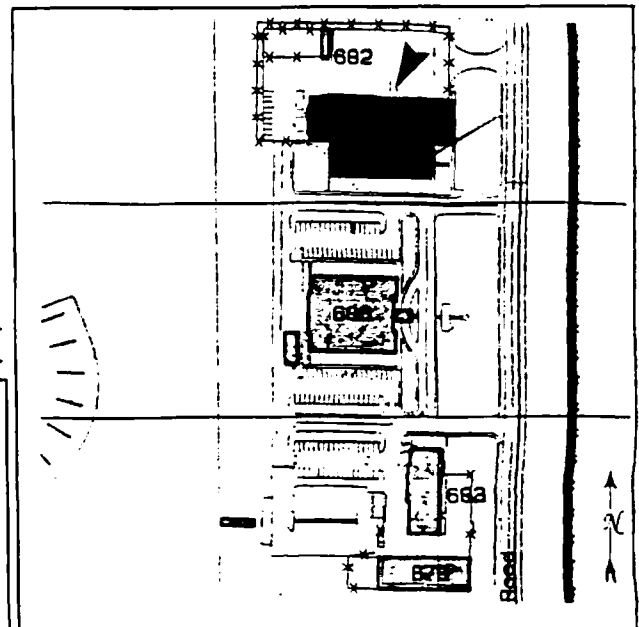

PRIMARY RECORD

Primary # _____
HRI # _____
Trinomial _____
NRHP Status Code 6Z

Other Listings _____
Review Code _____ Reviewer _____ Date / /

Page 1 of 2

*Resource Name or #: 682, Moffett Federal Airfield

P1. Other Identifier: Storage

*P2. Location: Not for Publication Unrestricted a. County Santa Clara
b. USGS 7.5' Quad _____ Date _____ T _____; R _____; _____ 1/4 of _____ 1/4 of Sec _____; _____ B.M.
c. Address Macon Road City Moffett Federal Airfield Zip 94035
d. UTM: (Give more than one for large and/or linear feature) Zone _____, _____ mE/ _____ mN
e. Other Locational Data: (e.g. parcel #, legal description, directions to resource, elevation, additional UTM's, etc. as appropriate)

*P3a. Description: (Describe resource and its major elements. Include design, materials, condition, alterations, size, setting, and boundaries.)
Building 682 is a high one-story rectangular building with glazed concrete block walls topped by a flat roof. Metal single or double doors provide access on the east and south sides. Metal louvers vent the west side. Its five stockrooms are designed to house oxygen, acetylene, argon, nitrogen, and corrosives.

*P3b. Resources Attributes: (List attributes and codes) HP34, Military Property

*P4. Resources Present: Building Structure Object Site District Element of District Other (Isolates, etc.)

P5b. Description of Photo: (View, date, etc.)
Northwest,
April 1998, Roll 1-28

*P6. Date Constructed/Age and Sources:
 Prehistoric Historic Both
1980

*P7. Owner and Address:
U.S.A. as represented by
National Aeronautics and Space
Administration, Washington, D.C.

*P8. Recorded by: (Name, affiliation, address)
Alexandra C. Cole, SAIC
816 State Street, Suite 500
Santa Barbara, CA 93101

*P9. Date Recorded: 06/30/1998

*P10. Survey Type: (Describe)
Comprehensive Survey for Section
106 Compliance



*P11. Report Citation: (Cite survey report/other sources or "none") Inventory and Evaluation of Cold War Era Historical Resources, Moffett Federal Airfield

*Attachments: NONE Location Map Sketch Map Continuation Sheet Building, Structure and Object Record
 Archaeological Record District Record Linear Feature Record Milling Station Record Rock Art Record Artifact Record
 Photograph Record Other: (List) _____

BUILDING, STRUCTURE, AND OBJECT RECORD

Page 2 of 2

*NRHP Status Code 6Z

*Resource Name or #: 682, Moffett Federal Airfield

B1. Historic Name: Unknown

B2. Common Name: Unknown

B3. Original Use: CANG Hazardous Storage B4. Present Use: CANG Hazardous Storage

*B5. Architectural Style: No Style

*B6. Construction History: (Construction date, alterations, and date of alterations.)
1980

*B7. Moved? No Yes Unknown Date: _____ Original Location: _____

*B8. Related Features:

B9a. Architect: Unknown b. Builder: Unknown

*B10. Significance: Theme Cold War Area United States

Period of Significance 1946-1989 Property Type Military Applicable Criteria G

(Discuss importance in terms of historical or architectural context as defined by theme, period, and geographic scope. Also address integrity.)

This Cold War-era building is considered a support building, a type found at any Naval installation regardless of mission. It is therefore not of exceptional national significance and is not considered eligible for the National Register of Historic Places (Criterion G).

B11. Additional Resource Attributes: (List attributes and codes) _____

*B12. References:

Real Property Form

B13. Remarks:

*B14. Evaluator: Alexandra C. Cole

Date of Evaluation: 05/01/1998

(This space reserved for official comments.)

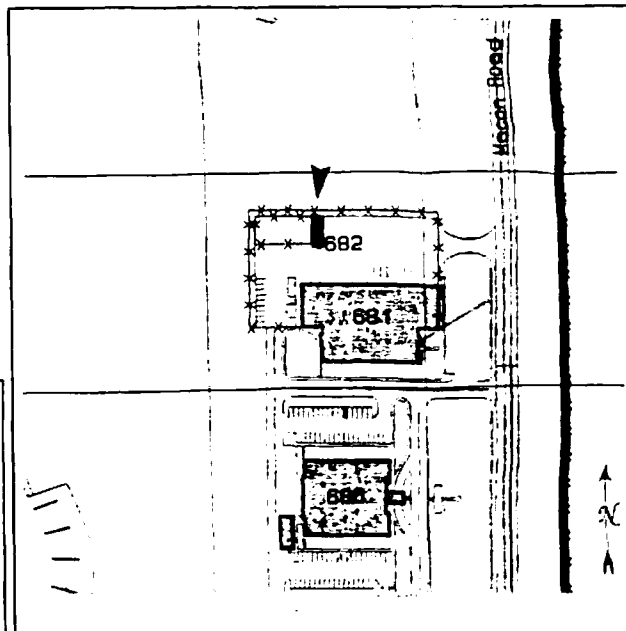

PRIMARY RECORD

Primary # _____
HRI # _____
Trinomial _____
NRHP Status Code 6Z

Other Listings _____
Review Code _____ Reviewer _____ Date / /

Page 1 of 2

*Resource Name or #: 683, Moffett Federal Airfield

P1. Other Identifier: Civil Engineering Office

*P2. Location: Not for Publication Unrestricted a. County Santa Clara

b. USGS 7.5' Quad _____ Date _____ T _____; R _____; _____ 1/4 of _____ 1/4 of Sec _____; _____ B.M.

c. Address Macon Road City Moffett Field Zip 94035

d. UTM: (Give more than one for large and/or linear feature) Zone _____, _____ mE/ _____ mN

e. Other Locational Data: (e.g. parcel #, legal description, directions to resource, elevation, additional UTM's, etc. as appropriate)

*P3a. Description: (Describe resource and its major elements. Include design, materials, condition, alterations, size, setting, and boundaries.)

This irregular-shaped building is constructed of glazed concrete block and ribbed metal. The main entrance wall (north) has three brushed concrete buttresses with planted berms topped by tinted ribbon windows in metal frames. The front shed roof is standing seam metal and the rear is a flat roof. The rear section has plywood panel lower walls and ribbed metal upper walls. Metal single and double doors provide access on the west and east sides. The building houses offices in the front section and shops at the rear. A rough concrete masonry wall connects this building to 679 to the south, providing a walled outdoor storage area.

*P3b. Resources Attributes: (List attributes and codes) HP34. Military Property

*P4. Resources Present: Building Structure Object Site District Element of District Other (Isolates, etc.)



P5b. Description of Photo: (View, date, etc.)

Southwest

April 1998, Roll 1-23

*P6. Date Constructed/Age and Sources:

Prehistoric Historic Both

1980

*P7. Owner and Address:

U.S.A. as represented by

National Aeronautics and Space

Administration, Washington, D.C.

*P8. Recorded by: (Name, affiliation, address)

Alexandra C. Cole, SAIC

816 State Street, Suite 500

Santa Barbara, CA 93101

*P9. Date Recorded: 06/29/1998

*P10. Survey Type: (Describe)

Comprehensive Survey for Section

106 Compliance

*P11. Report Citation: (Cite survey report/other sources or "none") Inventory and Evaluation of Cold War Era Historical Resources, Moffett Federal Airfield

*Attachments: NONE Location Map Sketch Map Continuation Sheet Building, Structure and Object Record
 Archaeological Record District Record Linear Feature Record Milling Station Record Rock Art Record Artifact Record
 Photograph Record Other: (List) _____

BUILDING, STRUCTURE, AND OBJECT RECORD

*Resource Name or #: 683, Moffett Federal Airfield

B1. Historic Name: Unknown

B2. Common Name: Unknown

B3. Original Use: Civil Engineer/Maintenance B4. Present Use: CANG CE SVC/Maintenance

*B5. Architectural Style: No Style

*B6. Construction History: (Construction date, alterations, and date of alterations.)
1980

*B7. Moved? No Yes Unknown Date: _____ Original Location: _____

*B8. Related Features:

B9a. Architect: Reid & Tarics, S.F. b. Builder: Unknown

*B10. Significance: Theme Cold War Area United States

Period of Significance 1946-1989 Property Type Military Applicable Criteria G

(Discuss importance in terms of historical or architectural context as defined by theme, period, and geographic scope. Also address integrity.)

This Cold War-era building is considered a support building, a type found at any Naval installation regardless of mission. It is therefore not of exceptional national significance and is not considered eligible for the National Register of Historic Places (Criterion G).

B11. Additional Resource Attributes: (List attributes and codes) _____

*B12. References:
Real Property Form

B13. Remarks:

*B14. Evaluator: Alexandra C. Cole

Date of Evaluation: 05/01/1998

(This space reserved for official comments.)

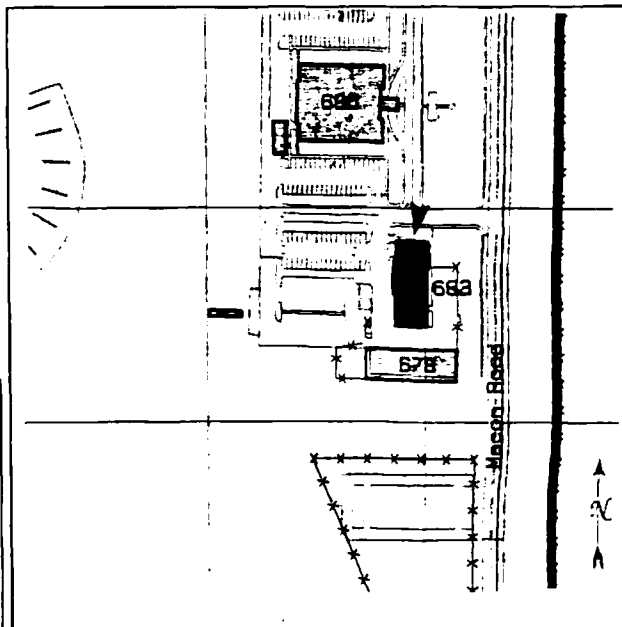

PRIMARY RECORD

Primary # _____
HRI # _____
Trinomial _____
NRHP Status Code 6Z

Other Listings _____
Review Code _____ Reviewer _____ Date / /

Page 1 of 2

*Resource Name or #: 684, Moffett Federal Airfield

P1. Other Identifier: Storage

*P2. Location: Not for Publication Unrestricted a. County Santa Clara
b. USGS 7.5' Quad _____ Date _____ T _____; R _____; _____ 1/4 of _____ 1/4 of Sec _____; _____ B.M.
c. Address Macon Road City Moffett Field Zip 94035
d. UTM: (Give more than one for large and/or linear feature) Zone _____, _____ mE/ _____ mN
e. Other Locational Data: (e.g. parcel #, legal description, directions to resource, elevation, additional UTM's, etc. as appropriate)

*P3a. Description: (Describe resource and its major elements. Include design, materials, condition, alterations, size, setting, and boundaries.)
This ground equipment facility is a flat-roofed rectangular tilt-up construction building capped with a decorative Tri-score concrete masonry parapet. Three metal overhead doors provide access on the west (flight line) side. Four open bays are located on the east side.

*P3b. Resources Attributes: (List attributes and codes) HP34. Military Property

*P4. Resources Present: Building Structure Object Site District Element of District Other (Isolates, etc.)



*P5b. Description of Photo: (View, date, etc.)
Southeast,

April 1998, Roll 3-34A

*P6. Date Constructed/Age and Sources:
 Prehistoric Historic Both
1984

*P7. Owner and Address:
U.S.A. as represented by
National Aeronautics and Space
Administration, Washington, D.C.

*P8. Recorded by: (Name, affiliation, address)
Alexandra C. Cole, SAIC
816 State Street, Suite 500
Santa Barbara, CA 93101

*P9. Date Recorded: 06/29/1998

*P10. Survey Type: (Describe)
Comprehensive Survey for Section
106 Compliance

*P11. Report Citation: (Cite survey report/other sources or "none") Inventory and Evaluation of Cold War Era Historical Resources, Moffett Federal Airfield

*Attachments: NONE Location Map Sketch Map Continuation Sheet Building, Structure and Object Record
 Archaeological Record District Record Linear Feature Record Milling Station Record Rock Art Record Artifact Record
 Photograph Record Other: (List) _____

BUILDING, STRUCTURE, AND OBJECT RECORD

Page 2 of 2

*NRHP Status Code 6Z

*Resource Name or #: 684, Moffett Federal Airfield

B1. Historic Name: Unknown

B2. Common Name: Unknown

B3. Original Use: Storage B4. Present Use: CANG Equipment Storage

*B5. Architectural Style: No Style

*B6. Construction History: (Construction date, alterations, and date of alterations.)
1984

*B7. Moved? No Yes Unknown Date: _____ Original Location: _____

*B8. Related Features:

B9a. Architect: Griffin/Joyce Assoc., San Jose b. Builder: Unknown

*B10. Significance: Theme Cold War Area United States

Period of Significance 1946-1989 Property Type Military Applicable Criteria G

(Discuss importance in terms of historical or architectural context as defined by theme, period, and geographic scope. Also address integrity.)

This Cold War-era building is considered a support building, a type found at any Naval installation regardless of mission. It is therefore not of exceptional national significance and is not considered eligible for the National Register of Historical Places (Criterion G).

B11. Additional Resource Attributes: (List attributes and codes) _____

*B12. References:
Real Property Form

B13. Remarks:

*B14. Evaluator: Alexandra C. Cole

Date of Evaluation: 05/01/1998

(This space reserved for official comments.)

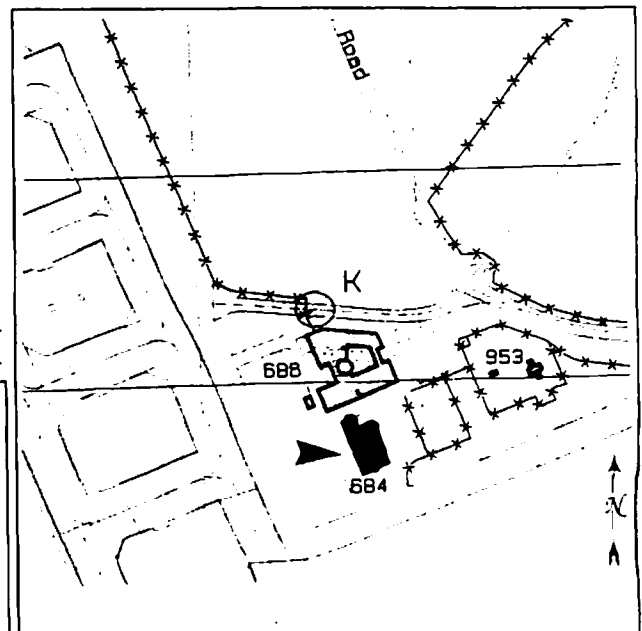

PRIMARY RECORD

Primary # _____
HRI # _____
Trinomial _____
NRHP Status Code 6Z

Other Listings _____
Review Code _____ Reviewer _____ Date / /

Page 1 of 2

*Resource Name or #: 686, Moffett Federal Airfield

P1. Other Identifier: Parachute Repair

*P2. Location: Not for Publication Unrestricted a. County Santa Clara
b. USGS 7.5' Quad _____ Date _____ T _____; R _____; _____ 1/4 of _____ 1/4 of Sec _____; _____ B.M.
c. Address Macon Road City Moffett Field Zip 94035
d. UTM: (Give more than one for large and/or linear feature) Zone _____, _____ mE/ _____ mN
e. Other Locational Data: (e.g. parcel #, legal description, directions to resource, elevation, additional UTM, etc. as appropriate)

*P3a. Description: (Describe resource and its major elements. Include design, materials, condition, alterations, size, setting, and boundaries.)
Building 686 is an irregular-shaped one-story building with pre-fabricated stucco panel walls set on a concrete foundation. A cylindrical parachute tower extends two stories from the center of the building. Metal and glass double doors and metal single doors provide access on the west side. The front entrance has glass and metal double doors flanked by large tinted picture windows. An open storage shed supported on metal posts extends from the southwest corner.

*P3b. Resources Attributes: (List attributes and codes) HP34. Military Property

*P4. Resources Present: Building Structure Object Site District Element of District Other (Isolates, etc.)

P5b. Description of Photo: (View, date, etc.)
Southeast,
April 1998, Roll 3-33A

*P6. Date Constructed/Age and Sources:
 Prehistoric Historic Both
1984

*P7. Owner and Address:
U.S.A. as represented by
National Aeronautics and Space
Administration, Washington, D.C.

*P8. Recorded by: (Name, affiliation, address)
Alexandra C. Cole, SAIC
816 State Street, Suite 500
Santa Barbara, CA 93101

*P9. Date Recorded: 06/29/1998

*P10. Survey Type: (Describe)
Comprehensive Survey for Section
106 Compliance

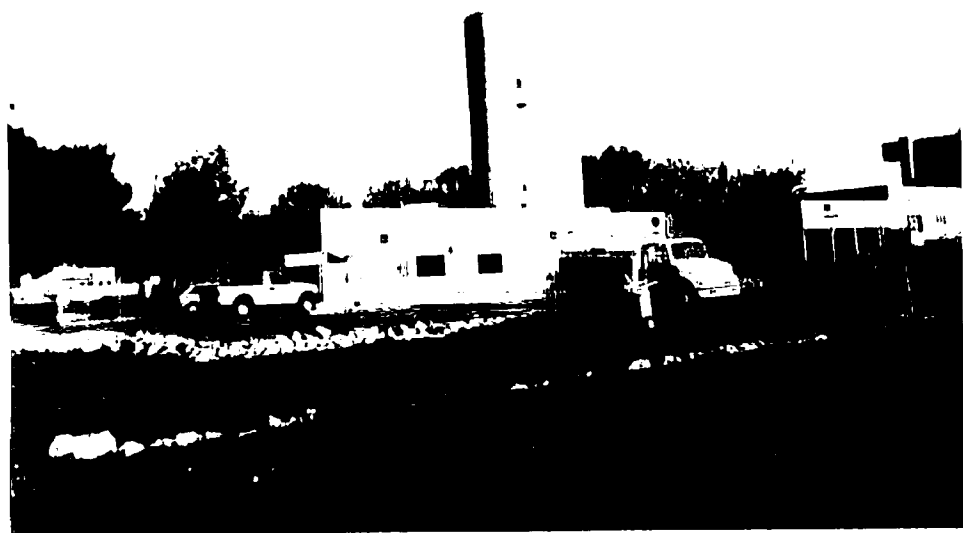

*P11. Report Citation: (Cite survey report/other sources or "none") Inventory and Evaluation of Cold War Era Historical Resources, Moffett Federal Airfield

*Attachments: NONE Location Map Sketch Map Continuation Sheet Building, Structure and Object Record
 Archaeological Record District Record Linear Feature Record Milling Station Record Rock Art Record Artifact Record
 Photograph Record Other: (List) _____

BUILDING, STRUCTURE, AND OBJECT RECORD

Page 2 of 2

*NRHP Status Code 6Z

*Resource Name or #: 686, Moffett Federal Airfield

B1. Historic Name: Unknown

B2. Common Name: Unknown

B3. Original Use: Parachute and Dinghy Repair B4. Present Use: Pararescue/Survival Equipment

*B5. Architectural Style: No Style

*B6. Construction History: (Construction date, alterations, and date of alterations.)
1984

*B7. Moved? No Yes Unknown Date: _____ Original Location: _____

*B8. Related Features:

B9a. Architect: Crosby, Thornton, Marshall Assoc. b. Builder: Unknown

*B10. Significance: Theme Cold War Area United States

Period of Significance 1946-1989 Property Type Military Applicable Criteria G

(Discuss importance in terms of historical or architectural context as defined by theme, period, and geographic scope. Also address integrity.)

This Cold War-era building is considered a support building, a type found at any Naval installation regardless of mission. It is therefore not of exceptional national significance and is not considered eligible for the National Register of Historic Places (Criterion G).

B11. Additional Resource Attributes: (List attributes and codes) _____

*B12. References:
Real Property Form

B13. Remarks:

*B14. Evaluator: Alexandra C. Cole

Date of Evaluation: 05/01/1998

(This space reserved for official comments.)

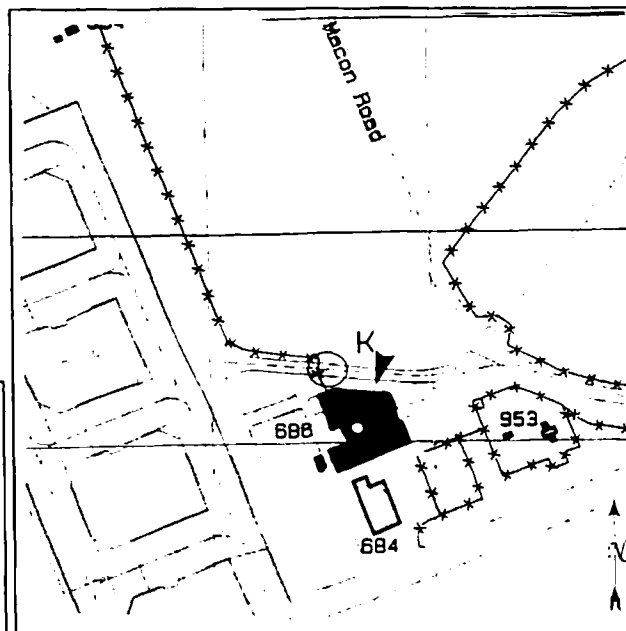

PRIMARY RECORD

Primary # _____
HRI # _____
Trinomial _____
NRHP Status Code 6Z

Other Listings _____
Review Code _____ Reviewer _____ Date / /

Page 1 of 2

*Resource Name or #: 901, Moffett Federal Airfield

P1. Other Identifier: Liquid Oxygen Storage

*P2. Location: Not for Publication Unrestricted a. County Santa Clara

b. USGS 7.5' Quad _____ Date _____ T _____; R _____; _____ 1/4 of _____ 1/4 of Sec _____; _____ B.M.

c. Address _____ City Moffett Field Zip 94035

d. UTM: (Give more than one for large and/or linear feature) Zone _____, _____ mE/ _____ mN

e. Other Locational Data: (e.g. parcel #, legal description, directions to resource, elevation, additional UTM's, etc. as appropriate)

*P3a. Description: (Describe resource and its major elements. Include design, materials, condition, alterations, size, setting, and boundaries.)

Building 901 is a high rectangular building of concrete block set on a concrete pad. Its flat roof is of ribbed metal. Four large openings are located on the east and west sides. It houses two large liquid oxygen tanks. Adjacent to it is a small square gable-roof concrete block building with fixed single pane windows and a metal single door. Both buildings are enclosed by a chain link fence.

*P3b. Resources Attributes: (List attributes and codes) HP34. Military Property

*P4. Resources Present: Building Structure Object Site District Element of District Other (Isolates, etc.)



P5b. Description of Photo: (View, date, etc.)
Northeast,

April 1998, Roll 3-19A

*P6. Date Constructed/Age and Sources:
 Prehistoric Historic Both
Unknown

*P7. Owner and Address:
U.S.A. as represented by
National Aeronautics and Space
Administration, Washington, D.C.

*P8. Recorded by: (Name, affiliation, address)
Alexandra C. Cole, SAIC
816 State Street, Suite 500
Santa Barbara, CA 93101

*P9. Date Recorded: 06/30/1998

*P10. Survey Type: (Describe)
Comprehensive Survey for Section
106 Compliance

*P11. Report Citation: (Cite survey report/other sources or "none") Inventory and Evaluation of Cold War Era Historical Resources, Moffett Federal Airfield

*Attachments: NONE Location Map Sketch Map Continuation Sheet Building, Structure and Object Record
 Archaeological Record District Record Linear Feature Record Milling Station Record Rock Art Record Artifact Record
 Photograph Record Other: (List) _____

BUILDING, STRUCTURE, AND OBJECT RECORD

Page 2 of 2

*NRHP Status Code 6Z

*Resource Name or #: 901, Moffett Federal Airfield

B1. Historic Name: Unknown

B2. Common Name: Unknown

B3. Original Use: Liquid Oxygen Storage

B4. Present Use: Liquid Oxygen-DFSC

*B5. Architectural Style: No style

*B6. Construction History: (Construction date, alterations, and date of alterations.)

Unknown

*B7. Moved? No Yes Unknown Date: _____ Original Location: _____

*B8. Related Features:

B9a. Architect: Unknown

b. Builder: Unknown

*B10. Significance: Theme Cold War

Area United States

Period of Significance 1946-1989

Property Type Military

Applicable Criteria G

(Discuss importance in terms of historical or architectural context as defined by theme, period, and geographic scope. Also address integrity.)

This Cold War-era building is considered a support building, a type found at any Naval installation regardless of mission. It is therefore not of exceptional national significance and is not considered eligible for the National Register of Historic Places (Criterion G).

B11. Additional Resource Attributes: (List attributes and codes) _____

*B12. References:

Real Property Form

B13. Remarks:

*B14. Evaluator: Alexandra C. Cole

Date of Evaluation: 05/01/1998

(This space reserved for official comments.)

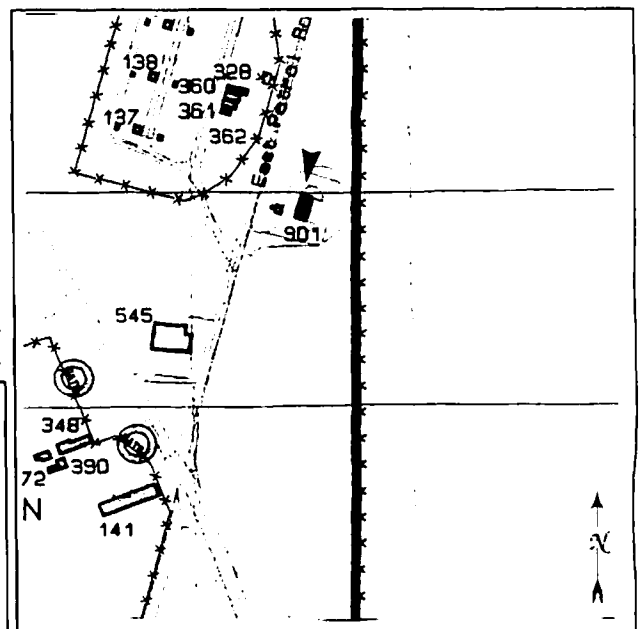

PRIMARY RECORD

Primary # _____
HRI # _____
Trinomial _____
NRHP Status Code 6Z

Other Listings _____
Review Code _____ Reviewer _____ Date / /

Page 1 of 2

*Resource Name or #: 949, Moffett Federal Airfield

P1. Other Identifier: Munitions Magazine

*P2. Location: Not for Publication Unrestricted a. County Santa Clara

b. USGS 7.5' Quad _____ Date _____ T _____; R _____; _____ 1/4 of _____ 1/4 of Sec _____; _____ B.M.

c. Address Zook Road City Moffett Field Zip 94035

d. UTM: (Give more than one for large and/or linear feature) Zone _____, _____ mE/ _____ mN

e. Other Locational Data: (e.g. parcel #, legal description, directions to resource, elevation, additional UTM, etc. as appropriate)

*P3a. Description: (Describe resource and its major elements. Include design, materials, condition, alterations, size, setting, and boundaries.)

This small rectangular flat-roofed building is made of concrete. It is divided into six small lockers with heavy metal doors, three on the east and three on the west. Each locker has a metal roof vent.

*P3b. Resources Attributes: (List attributes and codes) HP34. Military Property

*P4. Resources Present: Building Structure Object Site District Element of District Other (Isolates, etc.)

P5b. Description of Photo: (View, date, etc.)
Northwest,

April 1998, Roll 4-12

*P6. Date Constructed/Age and Sources:
 Prehistoric Historic Both
1956

*P7. Owner and Address:
U.S.A. as represented by
National Aeronautics and Space
Administration, Washington, D.C.

*P8. Recorded by: (Name, affiliation, address)
Alexandra C. Cole, SAIC
816 State Street, Suite 500
Santa Barbara, CA 93101

*P9. Date Recorded: 06/29/1998

*P10. Survey Type: (Describe)
Comprehensive Survey for Section
106 Compliance

*P11. Report Citation: (Cite survey report/other sources or "none") Inventory and Evaluation of Cold War Era Historical Resources, Moffett Federal Airfield

*Attachments: NONE Location Map Sketch Map Continuation Sheet Building, Structure and Object Record
 Archaeological Record District Record Linear Feature Record Milling Station Record Rock Art Record Artifact Record
 Photograph Record Other: (List) _____

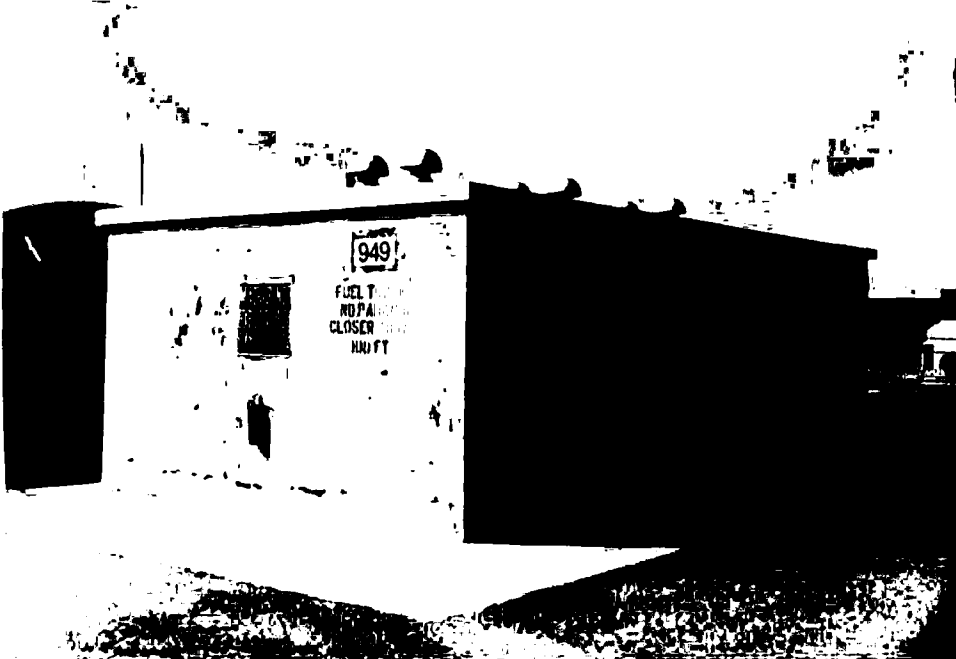

BUILDING, STRUCTURE, AND OBJECT RECORD

Page 2 of 2

*NRHP Status Code 6Z

*Resource Name or #: 949, Moffett Federal Airfield

B1. Historic Name: Building 249

B2. Common Name: Unknown

B3. Original Use: High Explosives Magazine

B4. Present Use: CANG Ordnance Magazine

*B5. Architectural Style: No Style

*B6. Construction History: (Construction date, alterations, and date of alterations.)

1956

*B7. Moved? No Yes Unknown Date: _____ Original Location: _____

*B8. Related Features:

B9a. Architect: Unknown

b. Builder: Unknown

*B10. Significance: Theme Cold War

Area United States

Period of Significance 1946-1989

Property Type Military

Applicable Criteria G

(Discuss importance in terms of historical or architectural context as defined by theme, period, and geographic scope. Also address integrity.)

This Cold War-era building is considered a support building, a type found at any Naval installation regardless of mission. It is therefore not of exceptional national significance and is not considered eligible for the National Register of Historic Places (Criterion G).

B11. Additional Resource Attributes: (List attributes and codes) _____

*B12. References:

B13. Remarks:

*B14. Evaluator: Alexandra C. Cole

Date of Evaluation: 05/01/1998

(This space reserved for official comments.)

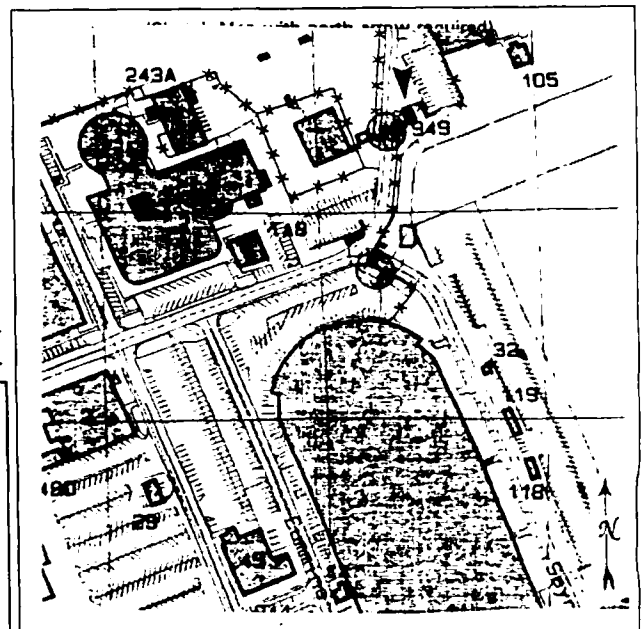

PRIMARY RECORD

Primary # _____
HRI # _____
Trinomial _____
NRHP Status Code 6Z

Other Listings _____
Review Code _____ Reviewer _____ Date / /

Page 1 of 2

*Resource Name or #: 950, Moffett Federal Airfield

P1. Other Identifier: Storage

*P2. Location: Not for Publication Unrestricted a. County Santa Clara
b. USGS 7.5' Quad _____ Date _____ T _____; R _____; _____ 1/4 of _____ 1/4 of Sec _____; _____ B.M.
c. Address South Perimeter Road City Moffett Federal Airfield Zip 94035
d. UTM: (Give more than one for large and/or linear feature) Zone _____, _____ mE/ _____ mN
e. Other Locational Data: (e.g. parcel #, legal description, directions to resource, elevation, additional UTM, etc. as appropriate)

*P3a. Description: (Describe resource and its major elements. Include design, materials, condition, alterations, size, setting, and boundaries.)
Building 950 is a pre-fabricated metal open storage shed set on a concrete slab. The corrugated metal shallow-pitched gable-roof is supported on fourteen metal tapered columns. It stores hazardous waste materials.

*P3b. Resources Attributes: (List attributes and codes) HP34, Military Property

*P4. Resources Present: Building Structure Object Site District Element of District Other (Isolates, etc.)

P5b. Description of Photo: (View, date, etc.)
North,
April 1998, Roll 7-28

*P6. Date Constructed/Age and Sources:
 Prehistoric Historic Both
1989

*P7. Owner and Address:
U.S.A. as represented by
National Aeronautics and Space
Administration, Washington, D.C.

*P8. Recorded by: (Name, affiliation, address)
Alexandra C. Cole, SAIC
816 State Street, Suite 500
Santa Barbara, CA 93101

*P9. Date Recorded: 06/29/1998

*P10. Survey Type: (Describe)
Comprehensive Survey for Section
106 Compliance



*P11. Report Citation: (Cite survey report/other sources or "none") Inventory and Evaluation of Cold War Era Historical Resources, Moffett Federal Airfield

*Attachments: NONE Location Map Sketch Map Continuation Sheet Building, Structure and Object Record
 Archaeological Record District Record Linear Feature Record Milling Station Record Rock Art Record Artifact Record
 Photograph Record Other: (List) _____

BUILDING, STRUCTURE, AND OBJECT RECORD

Page 2 of 2

*NRHP Status Code 6Z

*Resource Name or #: 950, Moffett Federal Airfield

B1. Historic Name: Unknown

B2. Common Name: Unknown

B3. Original Use: Hazardous Materials Storage B4. Present Use: Hazardous Materials Storage

*B5. Architectural Style: No Style

*B6. Construction History: (Construction date, alterations, and date of alterations.)
1989

*B7. Moved? No Yes Unknown Date: _____ Original Location: _____

*B8. Related Features:

B9a. Architect: Unknown b. Builder: Unknown

*B10. Significance: Theme Cold War Area United States

Period of Significance 1946-1989 Property Type Military Applicable Criteria G

(Discuss importance in terms of historical or architectural context as defined by theme, period, and geographic scope. Also address integrity.)

This Cold War-era building is considered a support building, a type found at any Naval installation regardless of mission. It is therefore not of exceptional national significance and is not considered eligible for the National Register of Historic Places (Criterion G).

B11. Additional Resource Attributes: (List attributes and codes) _____

*B12. References:
Real Property Form

B13. Remarks:

*B14. Evaluator: Alexandra C. Cole

Date of Evaluation: 05/01/1998

(This space reserved for official comments.)

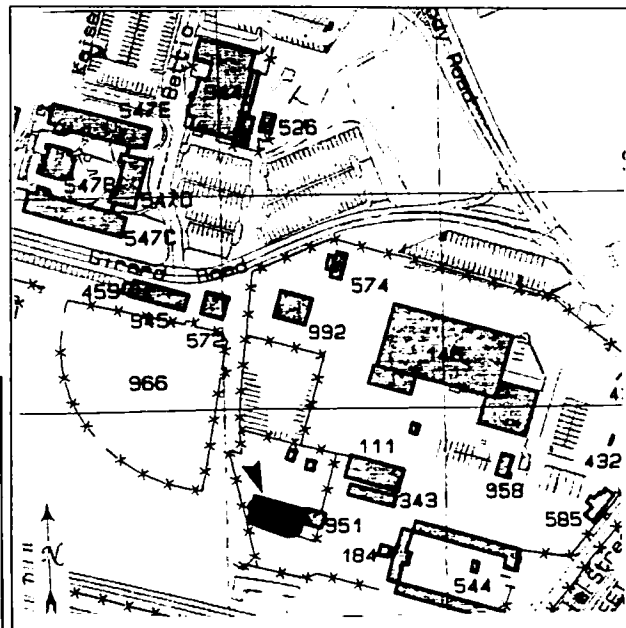

PRIMARY RECORD

Primary # _____
HRI # _____
Trinomial _____
NRHP Status Code 6Z

Other Listings _____
Review Code _____ Reviewer _____ Date / /

Page 1 of 2

*Resource Name or #: 951 (251)

P1. Other Identifier: Storage

*P2. Location: Not for Publication Unrestricted a. County Santa Clara

b. USGS 7.5' Quad _____ Date _____ T _____; R _____; _____ 1/4 of _____ 1/4 of Sec _____; _____ B.M.

c. Address South Perimeter Road City Moffett Federal Airfield Zip 94035

d. UTM: (Give more than one for large and/or linear feature) Zone _____, _____ mE/ _____ mN

e. Other Locational Data: (e.g. parcel #, legal description, directions to resource, elevation, additional UTM's, etc. as appropriate)

*P3a. Description: (Describe resource and its major elements. Include design, materials, condition, alterations, size, setting, and boundaries.)

Building 951 (251) is a small rectangular concrete building with a shallow-pitched concrete roof with widely overhanging eaves. Metal double doors provide access on the north and south sides. Fixed square single pane windows are located on the east and south sides. It is used to store hazardous materials.

*P3b. Resources Attributes: (List attributes and codes) HP34. Military Property

*P4. Resources Present: Building Structure Object Site District Element of District Other (Isolates, etc.)



P5b. Description of Photo: (View, date, etc.)
Northwest

April 1998, Roll 7-27

*P6. Date Constructed/Age and Sources:
 Prehistoric Historic Both
1957

*P7. Owner and Address:
U.S.A. as represented by
National Aeronautics and Space
Administration, Washington, D.C.

*P8. Recorded by: (Name, affiliation, address)
Alexandra C. Cole, SAIC
816 State Street, Suite 500
Santa Barbara, CA 93101

*P9. Date Recorded: 06/30/1998

*P10. Survey Type: (Describe)
Comprehensive Survey for Section
106 Compliance

*P11. Report Citation: (Cite survey report/other sources or "none") Inventory and Evaluation of Cold War Era Historical Resources, Moffett Federal Airfield

*Attachments: NONE Location Map Sketch Map Continuation Sheet Building, Structure and Object Record
 Archaeological Record District Record Linear Feature Record Milling Station Record Rock Art Record Artifact Record
 Photograph Record Other: (List) _____

BUILDING, STRUCTURE, AND OBJECT RECORD

Page 2 of 2

*NRHP Status Code 6Z

*Resource Name or #: 951 (251)

B1. Historic Name: Unknown

B2. Common Name: Unknown

B3. Original Use: Unknown B4. Present Use: Hazardous Materials Storage

*B5. Architectural Style: No Style

*B6. Construction History: (Construction date, alterations, and date of alterations.)
1957

*B7. Moved? No Yes Unknown Date: _____ Original Location: _____

*B8. Related Features:

B9a. Architect: Unknown b. Builder: Unknown

*B10. Significance: Theme Cold War Area United States

Period of Significance 1946-1989 Property Type Military Applicable Criteria G

(Discuss importance in terms of historical or architectural context as defined by theme, period, and geographic scope. Also address integrity.)

This Cold War-era building is considered a support building, a type found at any Naval installation regardless of mission. It is therefore not of exceptional national significance and is not considered eligible for the National Register of Historic Places (Criterion G).

B11. Additional Resource Attributes: (List attributes and codes) _____

*B12. References:
Real Property Form

B13. Remarks:

*B14. Evaluator: Alexandra C. Cole

Date of Evaluation: 05/01/1998

(This space reserved for official comments.)

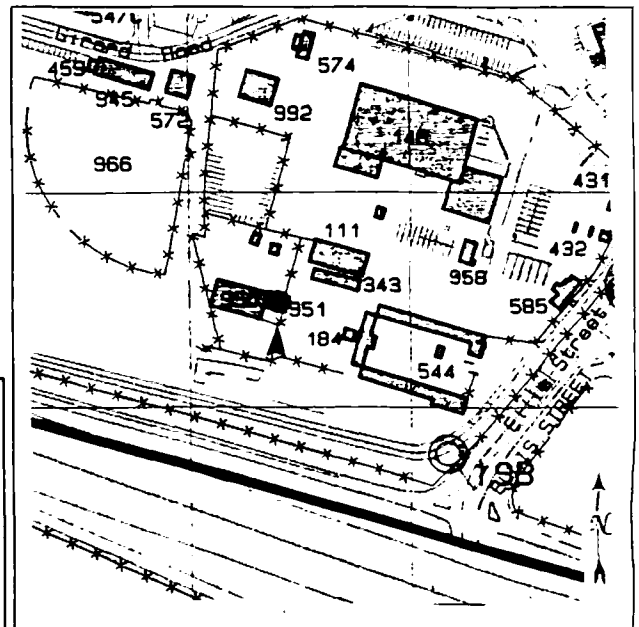

PRIMARY RECORD

Primary # _____
HRI # _____
Trinomial _____
NRHP Status Code 6Z

Other Listings _____
Review Code _____ Reviewer _____ Date / /

Page 1 of 2

*Resource Name or #: 953, Moffett Federal Airfield

P1. Other Identifier: Fuel Storage

*P2. Location: Not for Publication Unrestricted a. County Santa Clara
b. USGS 7.5' Quad _____ Date _____ T _____; R _____; _____ 1/4 of _____ 1/4 of Sec _____; _____ B.M.
c. Address Macon Road City Moffett Field Zip 94035
d. UTM: (Give more than one for large and/or linear feature) Zone _____, _____ mE/ _____ mN
e. Other Locational Data: (e.g. parcel #, legal description, directions to resource, elevation, additional UTM, etc. as appropriate)

*P3a. Description: (Describe resource and its major elements. Include design, materials, condition, alterations, size, setting, and boundaries.)
Building 953 consists of a pumping system and a circular fuel storage tank enclosed by a chain link fence.

*P3b. Resources Attributes: (List attributes and codes) HP34. Military Property

*P4. Resources Present: Building Structure Object Site District Element of District Other (Isolates, etc.)

P5b. Description of Photo: (View, date, etc.)
West,
April 1998, Roll 7-18

*P6. Date Constructed/Age and Sources:
 Prehistoric Historic Both
1956

*P7. Owner and Address:
U.S.A. as represented by
National Aeronautics and Space
Administration, Washington, D.C.

*P8. Recorded by: (Name, affiliation, address)
Alexandra C. Cole, SAIC
816 State Street, Suite 500
Santa Barbara, CA 93101

*P9. Date Recorded: 06/29/1998

*P10. Survey Type: (Describe)
Comprehensive Survey for Section
106 Compliance



*P11. Report Citation: (Cite survey report/other sources or "none") Inventory and Evaluation of Cold War Era Historical Resources, Moffett Federal Airfield

*Attachments: NONE Location Map Sketch Map Continuation Sheet Building, Structure and Object Record
 Archaeological Record District Record Linear Feature Record Milling Station Record Rock Art Record Artifact Record
 Photograph Record Other: (List) _____

BUILDING, STRUCTURE, AND OBJECT RECORD

Page 2 of 2

*NRHP Status Code 6Z

*Resource Name or #: 953, Moffett Federal Airfield

B1. Historic Name: Unknown

B2. Common Name: Unknown

B3. Original Use: Navy Day Tank-Fuel Storage B4. Present Use: CANG Ready Fuel Storage

*B5. Architectural Style: No Style

*B6. Construction History: (Construction date, alterations, and date of alterations.)
1956

*B7. Moved? No Yes Unknown Date: _____ Original Location: _____

*B8. Related Features: _____

B9a. Architect: Unknown b. Builder: Unknown

*B10. Significance: Theme Cold War Area United States

Period of Significance 1946-1989 Property Type Military Applicable Criteria G

(Discuss importance in terms of historical or architectural context as defined by theme, period, and geographic scope. Also address integrity.)

This Cold War-era building is considered a support building, a type found at any Naval installation regardless of mission. It is therefore not of exceptional national significance and is not considered eligible for the National Register of Historic Places (Criterion G).

B11. Additional Resource Attributes: (List attributes and codes) _____

*B12. References:
Real Property Form

B13. Remarks: _____

*B14. Evaluator: Alexandra C. Cole

Date of Evaluation: 05/01/1998

(This space reserved for official comments.)

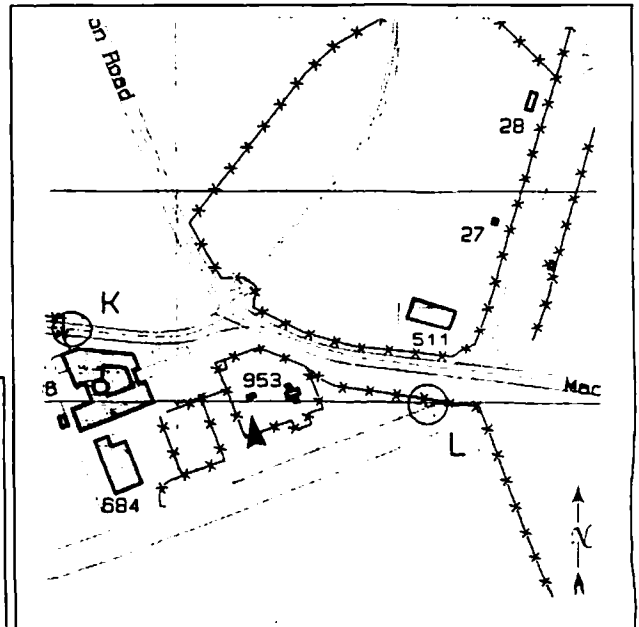

*Required information

PRIMARY RECORD

Primary # _____
HRI # _____
Trinomial _____
NRHP Status Code 6Z

Other Listings _____
Review Code _____ Reviewer _____ Date / /

Page 1 of 2

*Resource Name or #: 954, Moffett Federal Airfield

P1. Other Identifier: _____

*P2. Location: Not for Publication Unrestricted a. County Santa Clara
b. USGS 7.5' Quad _____ Date _____ T _____; R _____; _____ 1/4 of _____ 1/4 of Sec _____; _____ B.M.
c. Address Airfield, off Macon Road City Moffett Field Zip 94035
d. UTM: (Give more than one for large and/or linear feature) Zone _____, _____ mE/ _____ mN
e. Other Locational Data: (e.g. parcel #, legal description, directions to resource, elevation, additional UTM's, etc. as appropriate)

*P3a. Description: (Describe resource and its major elements. Include design, materials, condition, alterations, size, setting, and boundaries.)
Building 954 is a small rectangular metal panel building with a metal hipped roof. A flat-roof corrugated metal canopy shades the south entrance. Metal single doors provide access on the north, south, and east sides. A fixed and transom window in metal sash and transom windows are located on the south side. Formerly a fuel truck dispatching office, it is now used for storage. Its function has now been taken over by Building 686.

*P3b. Resources Attributes: (List attributes and codes) HP34. Military Property

*P4. Resources Present: Building Structure Object Site District Element of District Other (Isolates, etc.)

P5b. Description of Photo: (View, date, etc.)
North,
April 1998, Roll 7-20

*P6. Date Constructed/Age and Sources:
 Prehistoric Historic Both
1956

*P7. Owner and Address:
U.S.A. as represented by
National Aeronautics and Space
Administration, Washington, D.C.

*P8. Recorded by: (Name, affiliation, address)
Alexandra C. Cole, SAIC
816 State Street, Suite 500
Santa Barbara, CA 93101

*P9. Date Recorded: 06/29/1998

*P10. Survey Type: (Describe)
Comprehensive Survey for Section
106 Compliance

*P11. Report Citation: (Cite survey report/other sources or "none") Inventory and Evaluation of Cold War Era Historical Resources, Moffett Federal Airfield

*Attachments: NONE Location Map Sketch Map Continuation Sheet Building, Structure and Object Record
 Archaeological Record District Record Linear Feature Record Milling Station Record Rock Art Record Artifact Record
 Photograph Record Other: (List) _____



BUILDING, STRUCTURE, AND OBJECT RECORD

Page 2 of 2

*NRHP Status Code 6Z

*Resource Name or #: 954, Moffett Federal Airfield

B1. Historic Name: Unknown

B2. Common Name: Unknown

B3. Original Use: Fuel Truck Dispensing Office

B4. Present Use: Storage

*B5. Architectural Style: No Style

*B6. Construction History: (Construction date, alterations, and date of alterations.)

1956

*B7. Moved? No Yes Unknown Date: _____ Original Location: _____

*B8. Related Features:

B9a. Architect: Unknown

b. Builder: Unknown

*B10. Significance: Theme Cold War

Area United States

Period of Significance 1946-1989

Property Type Military

Applicable Criteria G

(Discuss importance in terms of historical or architectural context as defined by theme, period, and geographic scope. Also address integrity.)

This Cold War-building is considered a support building, a type found at any Naval installation regardless of mission. It is therefore not of exceptional national significance and is not considered eligible for the National Register of Historic Places (Criterion G).

B11. Additional Resource Attributes: (List attributes and codes) _____

*B12. References:

Real Property Form

B13. Remarks:

*B14. Evaluator: Alexandra C. Cole

Date of Evaluation: 05/01/1998

(This space reserved for official comments.)

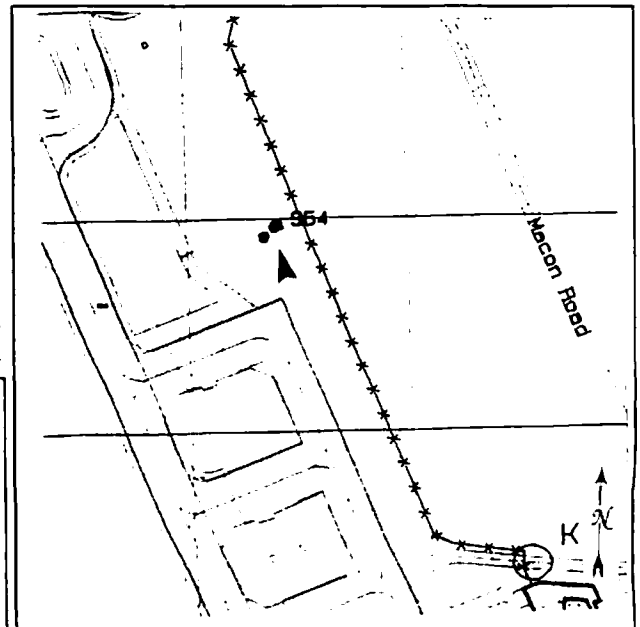

*Required information

PRIMARY RECORD

Primary # _____
HRI # _____
Trinomial _____
NRHP Status Code 6Z

Other Listings _____
Review Code _____ Reviewer _____ Date / /

Page 1 of 2

*Resource Name or #: 956 Moffett Federal Airfield

P1. Other Identifier: Parachute Loft

*P2. Location: Not for Publication Unrestricted a. County Santa Clara

b. USGS 7.5' Quad _____ Date _____ T _____; R _____; _____ 1/4 of _____ 1/4 of Sec _____; _____ B.M.

c. Address Cody Road City Moffett Field Zip 94035

d. UTM: (Give more than one for large and/or linear feature) Zone _____ mE/ _____ mN

e. Other Locational Data: (e.g. parcel #, legal description, directions to resource, elevation, additional UTM's, etc. as appropriate)

*P3a. Description: (Describe resource and its major elements. Include design, materials, condition, alterations, size, setting, and boundaries.)

This rectangular one-story paraloft building is constructed of concrete posts and beams with concrete block infill. The roof is flat. Two wings extend from the north side. A ribbed metal parachute tower extends from the roof on the east side. Multi-paned windows in metal sash light the north side. A raised receiving dock with two metal entrance doors is located on the west side.

*P3b. Resources Attributes: (List attributes and codes) HP34. Military Property

*P4. Resources Present: Building Structure Object Site District Element of District Other (Isolates, etc.)

P5b. Description of Photo: (View, date, etc.)
North,

April 1998, Roll 1-18

*P6. Date Constructed/Age and Sources:
 Prehistoric Historic Both
1957

*P7. Owner and Address:
U.S.A. as represented by
National Aeronautics and Space
Administration, Washington, D.C.

*P8. Recorded by: (Name, affiliation, address)
Alexandra C. Cole, SAIC
816 State Street, Suite 500
Santa Barbara, CA 93101

*P9. Date Recorded: 06/29/1998

*P10. Survey Type: (Describe)
Comprehensive Survey for Section
106 Compliance

*P11. Report Citation: (Cite survey report/other sources or "none") Inventory and Evaluation of Cold War Era Historical Resources, Moffett Federal Airfield

*Attachments: NONE Location Map Sketch Map Continuation Sheet Building, Structure and Object Record
 Archaeological Record District Record Linear Feature Record Milling Station Record Rock Art Record Artifact Record
 Photograph Record Other: (List) _____

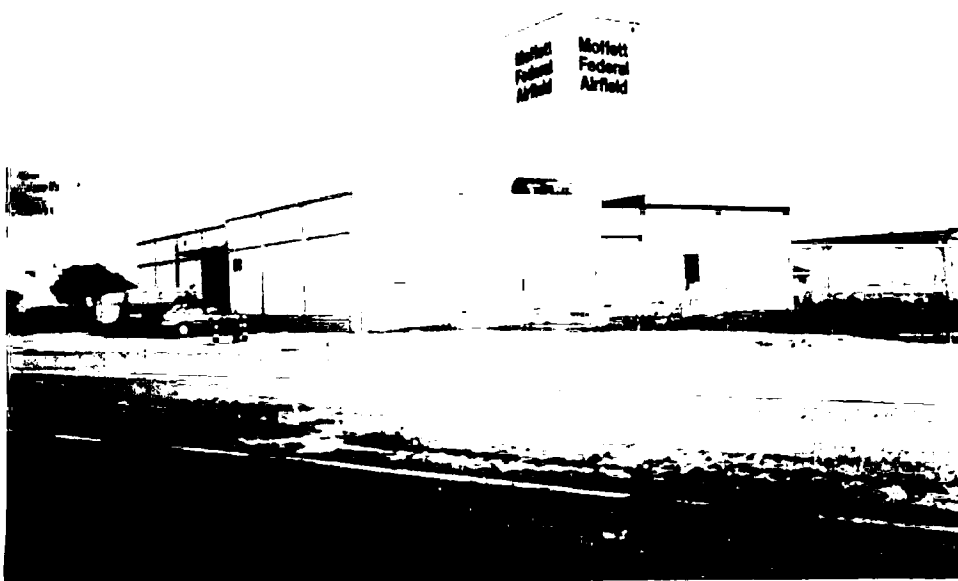

BUILDING, STRUCTURE, AND OBJECT RECORD

Page 2 of 2

*NRHP Status Code 6Z

*Resource Name or #: 956 Moffett Federal Airfield

B1. Historic Name: Unknown

B2. Common Name: Unknown

B3. Original Use: AIMD Parachute Loft B4. Present Use: Parachute Loft

*B5. Architectural Style: No Style

*B6. Construction History: (Construction date, alterations, and date of alterations.)

1957

*B7. Moved? No Yes Unknown Date: _____ Original Location: _____

*B8. Related Features:

B9a. Architect: Unknown b. Builder: Unknown

*B10. Significance: Theme Cold War Area United States

Period of Significance 1946-1989 Property Type Military Applicable Criteria G

(Discuss importance in terms of historical or architectural context as defined by theme, period, and geographic scope. Also address integrity.)

This Cold War-era building is considered a support building, a type found at any Naval installation regardless of mission. It is therefore not of exceptional national significance and is not considered eligible for the National Register of Historic Places (Criterion G).

B11. Additional Resource Attributes: (List attributes and codes) _____

*B12. References:

Real Property Form

B13. Remarks:

*B14. Evaluator: Alexandra C. Cole

Date of Evaluation: 05/01/1998

(This space reserved for official comments.)

